



Fisher Engineering

P.O. Box 529 Rockland, Maine 04841

26020-1

August 14, 2003
Lit. No. 28353

Mini Bar Light

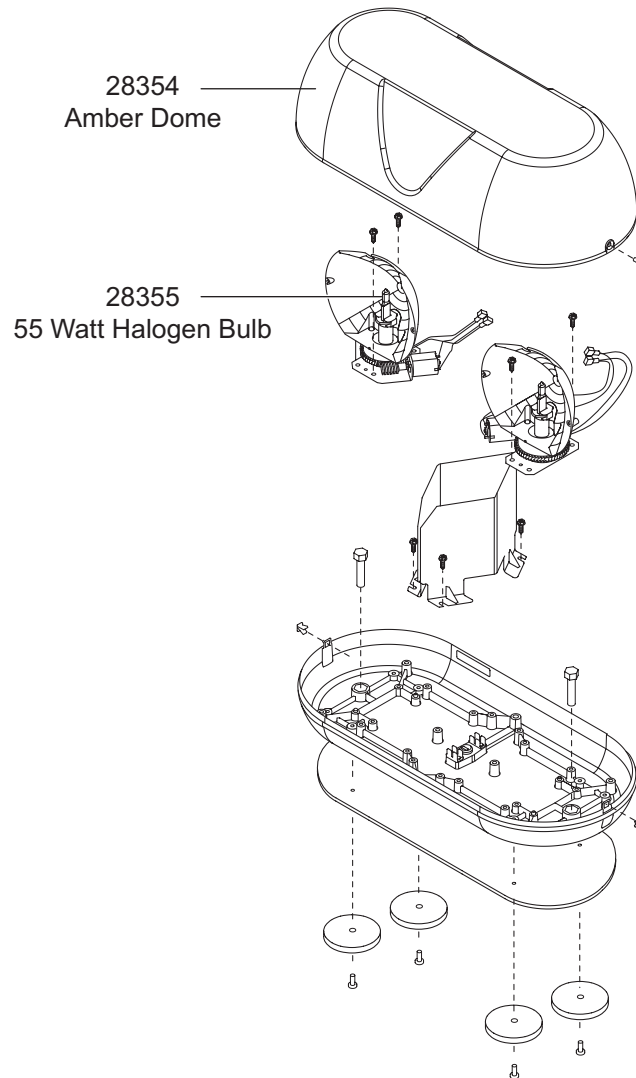

⚠ WARNING

The use of any magnetic mounted warning light on a vehicle while it is in motion is at the user's risk.

⚠ WARNING

Do not install this product or route wire in deployment path of an air bag. Refer to vehicle manufacturer's manual for air bag deployment area(s).

HALOGEN BULB REPLACEMENT

⚠ CAUTION

Do not handle the bulb with bare hands. Use gloves to prevent possible injury.

⚠ CAUTION

Replacing any halogen bulb requires the use of safety glasses to prevent injury.

1. Be sure to unplug the lamp from its power source before servicing lamp.
2. Remove the lens by unscrewing the two screws at each end of the light bar.

⚠ CAUTION

Turn the reflector using the motor or worm gear only or damage to the reflector could result.

3. After the bulb has completely cooled, remove the old bulb by removing the retaining clip, then pulling the bulb straight up and unplugging from its wires. If the rotator's reflector is in the way, move it by turning the worm gear on the motor.
4. Verify the replacement bulb is the correct wattage (55 watts). Plug the new bulb into the white wire and insert into the lamp socket as shown. Replace the retaining clip.
6. Replace lens using screws from Step 2.

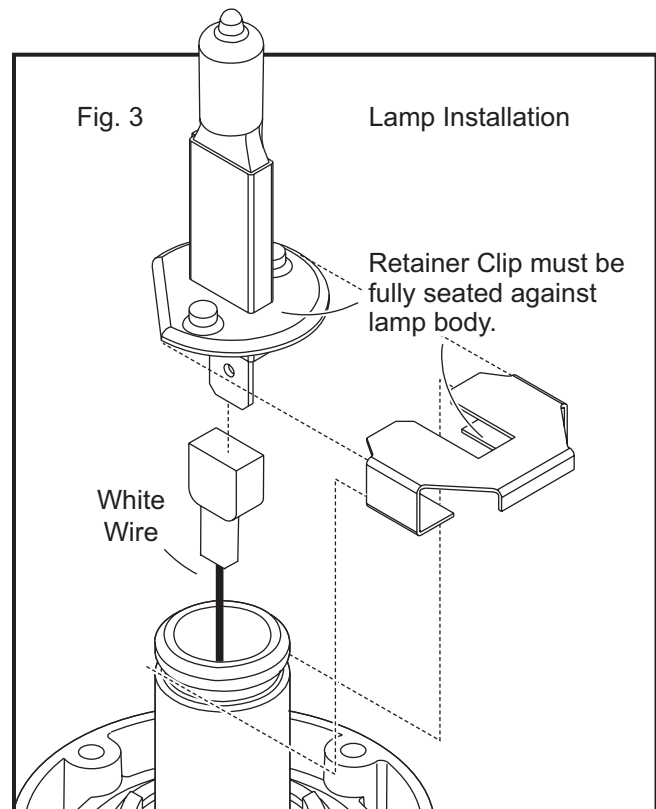

RECOMMENDATIONS

The outer surfaces of the strobe light may be cleaned with glass cleaner. Do not use abrasive or oil-based cleaners as they may dull the lens surface, resulting in reduced light output. Do not use a pressure washer!

Copyright© 2003 Douglas Dynamics, L.L.C. All rights reserved. This material may not be reproduced or copied, in whole or in part, in any printed, mechanical, electronic, film or other distribution and storage media, without the written consent of Fisher Engineering. Authorization to photocopy items for internal or personal use by Fisher Engineering outlets or snowplow owner is granted.

Fisher Engineering reserves the right under its product improvement policy to change construction or design details and furnish equipment when so altered without reference to illustrations or specifications used. Fisher Engineering and the vehicle manufacturer may require and/or recommend optional equipment for snow removal. Do not exceed vehicle ratings with a snowplow. Fisher Engineering offers a limited warranty for all snowplows and accessories. See separately printed page for this important information. The following are registered (®) and unregistered (™) trademarks of Douglas Dynamics, L.L.C.: FISHER®

Printed in USA