

4 WIRE/2 HARNESS

PECULIAR LIGHT KIT

A3735-31
A3735-32

CHECK YOUR LOCAL REGULATIONS FOR COMPLIANCE IN YOUR AREA.

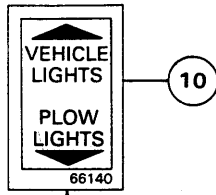

LIGHT SWITCH BRACKET LABEL
AFFIX TO LIGHT SWITCH BRACKET

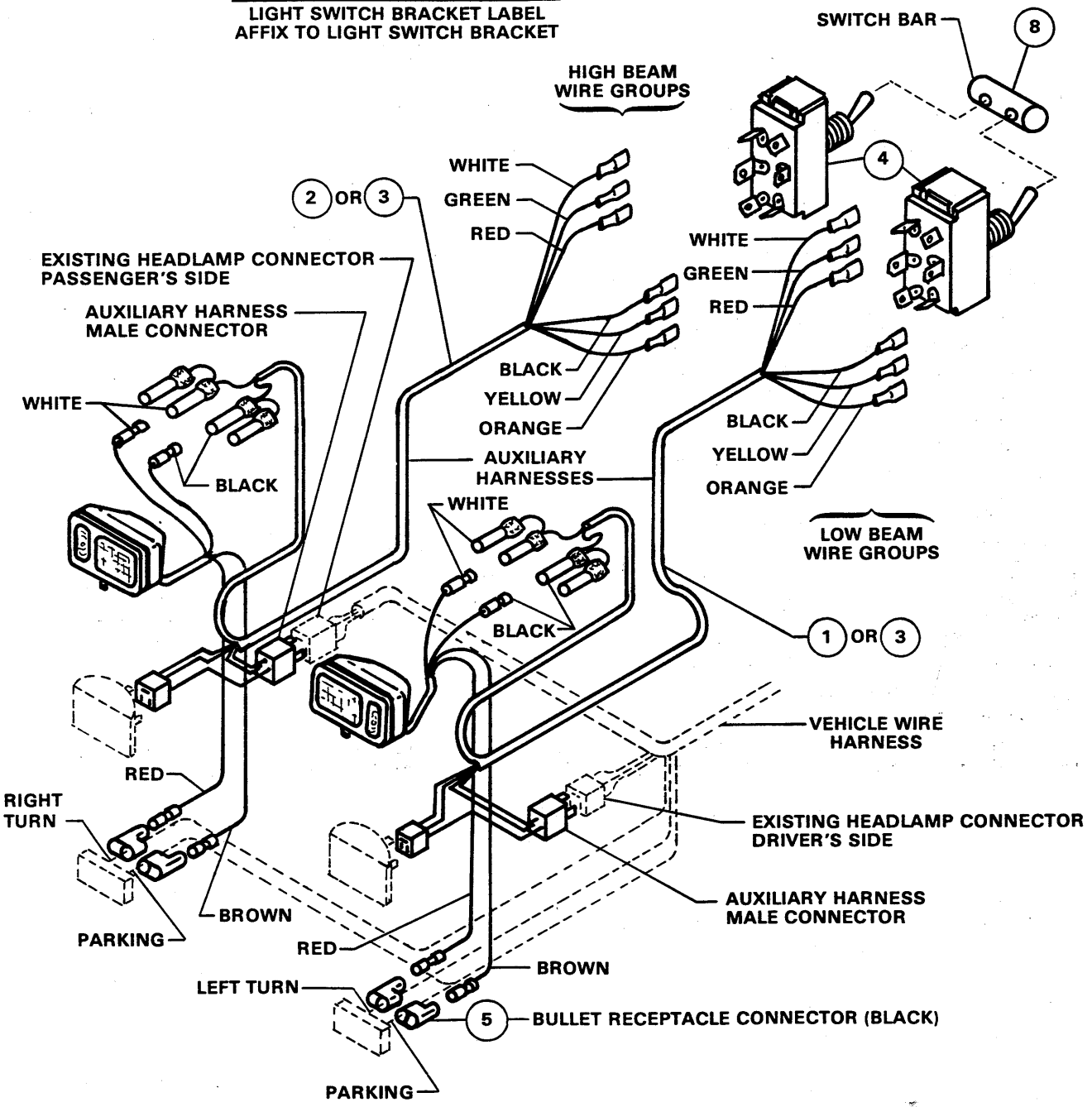

Reference Numbers for Parts List, Page 3.

INSTALLATION INSTRUCTIONS

This Peculiar Light Kit, when used with an A6136 Headlamp Kit, includes two (2) wiring harnesses, connectors and two (2) switches to simplify installation and provide performance equal to existing vehicle system. Always check to be certain the vehicle lights work properly before beginning the installation.

1. Assemble headlamps to headlamp support brackets on Headgear with headlamp swivel above brackets and loosely secured with lock washer and nut. Pass leads thru grille.
2. Identify park and turn signal lamp wires on both sides of vehicle.

CAUTION: Before proceeding, disconnect battery ground cable to avoid possible electrical equipment damage, electrical fire or personal injury.

Attach a black self stripping bullet receptacle connector to each wire. Route auxiliary headlamp red and brown wires to receptacles. Insert **RED** wire bullets into **TURN SIGNAL** wire receptacles and **BROWN** wire bullets into **PARK** wire receptacles.

3. Install light switch bracket and drill two (2) $\frac{3}{8}$ " holes in firewall per dash bracket mounting instructions. CHECK for adequate clearance before drilling.
4. **MODIFY BOTH HARNESSES PER INSTRUCTIONS AND DIAGRAM AT BOTTOM OF THIS PAGE BEFORE INSTALLATION.**
5. Driver's Side — Install one auxiliary harness (6127 harness if 2B/2D installation or one 6133 harness if 9004 (HB1) installation) by inserting end of harness with 6 loose wires thru a firewall hole drilled in Step 3. Route harness to vehicle headlamp.
6. Curb Side — Install second auxiliary harness (6138 harness if 2B/2D installation or 6133 harness if 9004 (HB1) installation) following same installation procedure as Step 5.
7. **BOTH SIDES OF VEHICLE:** Remove existing connectors from headlamps (NOTE: Vehicle headlamp connectors with lock feature — squeeze both sides of rubber boot to remove headlamp connectors) and couple to auxiliary harness male connectors. Couple auxiliary harness headlamp connectors to headlamps.
8. **EACH SIDE OF VEHICLE:** Bring harness and auxiliary headlamp black and white wire connectors to a common location behind the grille. **MATCHING** wire colors, black to black and white to white, insert headlamp wire bullets into harness receptacles.
9. Connect the six loose wire terminals of **EACH** auxiliary harness to a Toggle Switch as shown in wiring diagram, Page 1. Install switches in bracket. Affix Light Switch Bracket Label to bracket. Slide Switch Bar over toggles of both switches.
10. Install grommet around each harness and insert into firewall holes drilled in Step 3. **CAUTION:** Always protect wires to prevent electrical short circuits or fires.

This vehicle is equipped with a Heavy Duty Flasher. A flasher change is not required.

FINAL CHECK: When electrical circuits are completed, reconnect the vehicle battery. Check the operation of all vehicle lights. The vehicle and auxiliary headlamps are controlled by the Toggle Switch. The park/turn signal lamps operate with vehicle lights. Place **Toggle Switch** in **PLOW** position and with plow in **RAISED** position, aim **Auxiliary Headlamps** in accordance with SAE J599 Lighting Inspection Code (see Page 4 of these instructions) and any federal, state, or local regulations that apply.

Finally, secure harnesses and wires with cable ties so they do not interfere with hot or moving parts in engine compartment.

NOTE: Auxiliary and vehicle headlamps will use headlamp fuses as designed by vehicle manufacturer (if one fuse is blown, neither vehicle or auxiliary headlamp on that side will light).

CAUTION: Auxiliary lights provide added safety and are a NHTSA requirement. **BEFORE TRAVELING POSITION BLADE SO IT DOES NOT BLOCK HEADLAMP BEAM. DO NOT CHANGE BLADE POSITION WHILE TRAVELING.**

MODIFY WIRING HARNESSES AS FOLLOWS: Locate the headlamp connector with 6-wires. As close to 6-wire connector as possible, cut the 3 wires that go to the 3-wire connector (See Diagram). Protect ends of cut wires. (The 3-wire connector is not used on this installation. Modify both harnesses.)

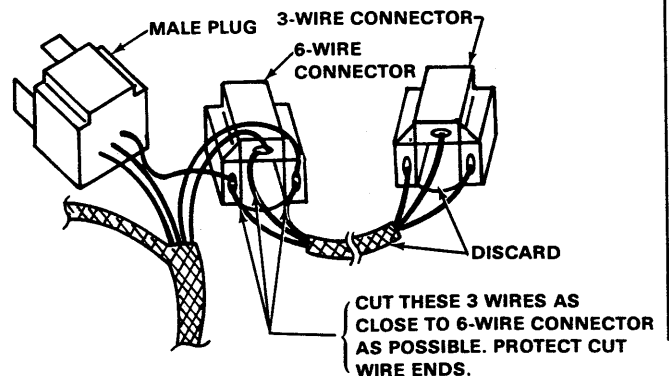

4-WIRE/2 HARNESS		PECULIAR LIGHT KIT PARTS LIST	
REF. NO.	QUANTITY	DESCRIPTION	PART NO.
1	1	Light Harness 2B/2D (A3735-31)	6127
2	1	Light Harness 2B/2D Long (A3735-31)	6138
3	2	Light Harness 9004 (HB1) (A3735-32)	6133
4	2	Toggle Switch	3736
5	4	Bullet Receptacle Connector	5776
6	6	Cable Tie (Not Shown)	3666
7	2	Grommet (Not Shown)	3042
8	1	Switch Bar	6518
9	1	Light Switch Bracket (Not Shown)	6130
10	1	Light Switch Bracket Label	6129

Reference Numbers for Diagram, Page 1.

4-WIRE COMMON LIGHT KIT PARTS LIST A6136

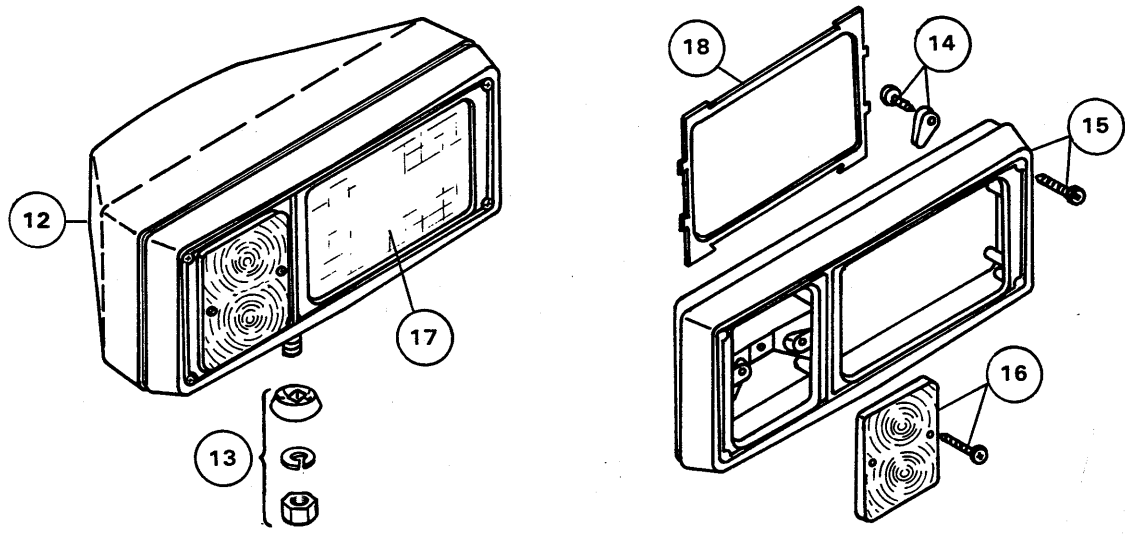

REF. NO.	QUANTITY	DESCRIPTION	PART NO.
12	1	Headlamp — Driver Side (Not Shown)	A6143
13	1	Headlamp — Passenger Side	A6144
14	2	Headlamp Swivel & Fastener Group	6128
15	2	2E1 Retaining Fingers with Fasteners (4 ea.)	A6153
16	2	Bezel with Fasteners (4) (Driver or Passenger Side)	6122
17	2	Lens with Fasteners (2) (Driver or Passenger Side)	6123
18	2	2E1 Headlamp — Plastic	6728
	1	Headlamp Gaskets (1 Pair)	6664
	4	Park/Turn Signal Bulb — (Trade Number 1157) (Not Shown)	

Fisher Engineering reserves the right under its Product Improvement Policy to change construction or design details and furnish equipment when so altered without reference to illustrations or specifications used herein.

**COMMON LIGHT KIT
INSTRUCTION SHEET**
FISHER HEADLAMP BEAM AIMING

1. PLACE VEHICLE ON A LEVEL SURFACE 25 FEET IN FRONT OF A MATTE-WHITE SCREEN, SUCH AS A GARAGE DOOR. THE SCREEN SHOULD BE PERPENDICULAR BOTH TO THE GROUND AND TO THE VEHICLE CENTERLINE.
2. THE VEHICLE SHOULD BE EQUIPPED FOR NORMAL OPERATION. THE SNOWPLOW BLADE SHOULD BE IN PLACE AND IN **RAISED** POSITION. BELOW ARE POINTS LISTED BY THE SOCIETY OF AUTOMOTIVE ENGINEERS (SAE) PERTINENT TO HEADLAMP AIMING IN SPECIFICATION #SAE J599d:

Preparation for Headlamp Aim or Inspection — Before checking beam aim, the inspector shall:

1. Remove ice or mud from under fenders.
 2. See that no tire is noticeably deflated.
 3. Check car springs for sag or broken leaves.
 4. See that there is no load in the vehicle other than the driver.
 5. Check functioning of any "level-ride" control.
 6. Clean lenses and aiming pads.
 7. Check for bulb burnout, broken mechanical aiming pads, and proper beam switching.
 8. Stabilize suspension by rocking vehicle sideways.
3. MARK (OR TAPE) THE VERTICAL CENTERLINE OF THE HEADLAMPS AND THE VEHICLE ITSELF ON THE SCREEN. MARK THE HORIZONTAL CENTERLINE OF THE HEADLAMPS ON THE SCREEN (DISTANCE FROM GROUND TO HEADLAMP CENTERS).
 4. THE CORRECT VISUAL AIM FOR TYPE 2 HEADLAMPS (SNOWPLOW HEADLAMPS ARE TYPE 2; SEE NUMBER ON FACE OF SEALED BEAM) IS WITH THE TOP EDGE OF THE HIGH INTENSITY ZONE OF THE LOWER BEAM BELOW THE HORIZONTAL CENTERLINE AND THE LEFT EDGE OF THE HIGH INTENSITY ZONE ON THE VERTICAL CENTERLINE (SEE DIAGRAM BELOW).

