

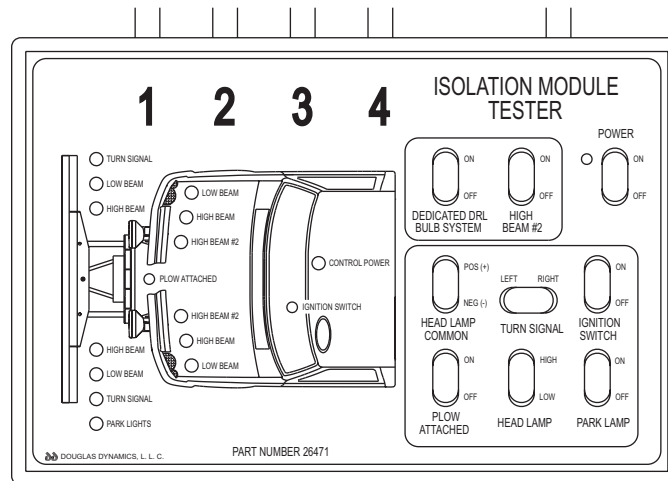

Operator's Manual for Isolation Module Tester



⚠ CAUTION

Read this document before testing any FISHER® snowplows.

⚠ CAUTION

See your FISHER® outlet for application recommendations. The Kit Selection Guide has specific vehicle and snowplow requirements.

TABLE OF CONTENTS

Safety Information	3
Test Preparation	7
Isolation Module On-Vehicle Test	7
Isolation Module 26400 (White Label) Off-Vehicle Test	9
Isolation Module 27781 (Light Green Label) Off-Vehicle Test	10
Isolation Module 26401 (Yellow Label) Off-Vehicle Test	11

SAFETY

SAFETY DEFINITIONS

WARNING

Indicates a potentially hazardous situation, that if not avoided, could result in death or serious personal injury.

CAUTION

Indicates a situation that, if not avoided, could result in damage to product or property.

NOTE: Identifies tips, helpful hints, and maintenance information the owner/operator should know.

BEFORE YOU BEGIN

WARNING

Lower blade when vehicle is parked. Temperature changes could change hydraulic pressure, causing the blade to drop unexpectedly or damaging hydraulic components. Failure to do this can result in serious personal injury.

WARNING

The tester shall keep bystanders clear of the blade during this test. Do not stand between the vehicle and the blade. A moving or falling blade could cause personal injury.

CAUTION

Before starting any test, the snowplow must be properly attached to the vehicle.

- Park the vehicle on a level surface, place shift lever in PARK or NEUTRAL and set parking brake.

PERSONAL SAFETY

- Wear only snug-fitting clothing while working on your vehicle or snowplow.
- Do not wear jewelry or a necktie, and secure long hair.
- Wear safety goggles to protect your eyes from battery acid, gasoline, dirt and dust.
- Avoid touching hot surfaces such as the engine, radiator, hoses and exhaust pipes.
- Always have a fire extinguisher rated BC handy, for flammable liquids and electrical fires.

FIRE AND EXPLOSION

WARNING

Gasoline is highly flammable and gasoline vapor is explosive. Never smoke while working on vehicle. Keep all open flames away from gasoline tank and lines. Wipe up any spilled gasoline immediately.

Be careful when using gasoline. Do not use gasoline to clean parts. Store only in approved containers away from sources of heat or flame.

BATTERY SAFETY

CAUTION

Batteries normally produce explosive gases which can cause personal injury. Therefore, do not allow flames, sparks or lit tobacco to come near the battery. When charging or working near a battery, always cover your face and protect your eyes, and also provide ventilation.

Batteries contain sulfuric acid which burns skin, eyes and clothing.

Disconnect the battery before removing or replacing any electrical components.

FUSES

The vehicle control harness contains two automotive-style fuses. One fuse is for the snowplow park/turn lamp power and the other is for the snowplow control power. If a problem should occur and fuse replacement is necessary, the replacement fuse should be of the same value as the original. Installing a fuse of a larger value could damage the system.

SAFETY

WARNING/CAUTION & INSTRUCTION LABELS

Become familiar with and inform users about the warning labels on the back of the blade, and the instruction label located either on the headgear or back of the blade.

Minute Mount® 2 System with Straight Blades

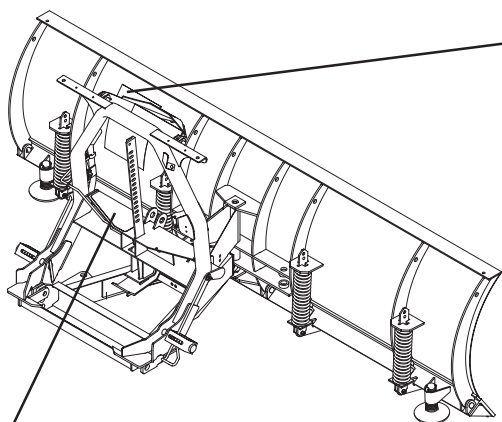

Instruction Label

Headgear
Jack (fully raised)
Jack (lowered)
Pin Release Handle (raised)
Stop
Jack Lock
Attachment Arm
Pushplate
Pin Release Handle (lowered)
Jack
Connecting Pin

1. Push **Pin Release Handle** down to pull out **Connecting Pins**.
2. Drive vehicle slowly to engage **Pushplates** into **Attachment Arms**.
3. Stand in front of blade. Fully raise **Pin Release Handle** to release **Connecting Pins**.
4. Push **Headgear** toward vehicle to allow **Connecting Pins** to fully engage **Pushplates**.
5. Pull out **Jack Lock**. Push **Pin Release Handle** into **Stop**.
6. While holding **Jack Lock** out, use **Jack Handle** to raise **Jack** fully. Release **Jack Lock**.
7. Attach all electrical connectors.

ATTACH

1. Place control in Lower/Float to put blade down.
2. Pull and hold **Jack Lock** out. **Jack** will drop to ground. Then pull **Pin Release Handle** away from **Stop** and **Jack Lock**. Release **Jack Lock**.

3. Stand in front of blade. While pushing **Headgear** toward vehicle with left hand, push **Pin Release Handle** down to disengage **Connecting Pins**. Make sure **Connecting Pins** are fully retracted.
4. Detach all electrical connectors.

DETACH

U.S. Patents 4,280,062; 4,999,935; 5,353,530; 5,420,480; RE 35,700; 6,253,470; CAN Patent 2,060,425; and other patents pending.

Read Owner's Manual For Complete Instructions

27451

Warning/Caution Label

WARNING

LOWER BLADE WHEN VEHICLE IS PARKED.

REMOVE BLADE ASSEMBLY BEFORE PLACING VEHICLE ON HOIST.

DO NOT EXCEED GVWR OR GAWR INCLUDING BLADE AND BALLAST.

CAUTION

READ OWNER'S MANUAL BEFORE OPERATING OR SERVICING SNOWPLOW.

TRANSPORT SPEED SHOULD NOT EXCEED 45 MPH. REDUCE SPEED UNDER ADVERSE TRAVEL CONDITIONS.

PLOWING SPEED SHOULD NOT EXCEED 10 MPH.

SEE YOUR SALES OUTLET FOR APPLICATION RECOMMENDATIONS.

Original Minute Mount® System with Straight Blades

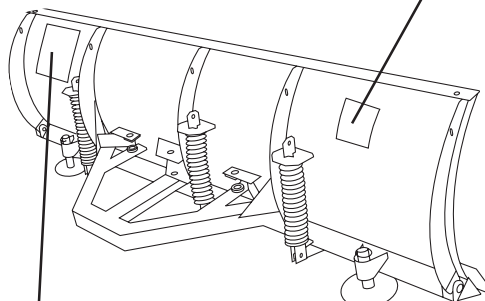

Instruction Label

U.S. Patents
4,280,062; 4,999,935;
5,353,530; 5,420,480
and other patents
pending

MOUNTING PLOW		REMOVING PLOW
<p>A</p> <ol style="list-style-type: none"> 1. Drive vehicle forward fully engaging pushplates into attachment arms. 		<p>C</p> <ol style="list-style-type: none"> 1. Remove slack from carrying chain and reattach. 2. Back vehicle away from plow.
<p>B</p> <ol style="list-style-type: none"> 1. Twist connecting pin to release tension. 2. Remove electrical covers on vehicle. 3. Attach electrical connector to corresponding connector on vehicle. 4. Repeat steps B 1-3 on passenger side of vehicle. 5. Connect hydraulic hoses to quick disconnects. (BELT DRIVE ONLY) 		<p>B</p> <ol style="list-style-type: none"> 1. Disconnect electrical connector and reinsert in protective cover. 2. Insert release rod under jack collar. 3. Push down on release rod as you pull and twist connecting pin. 4. Repeat Steps B 1-3 on passenger side. 5. Disconnect hydraulic hose couplings and cover with dust plugs.
<p>C</p> <ol style="list-style-type: none"> 1. Release carrying chain and reattach it leaving plenty of slack. 2. Push headgear upward toward vehicle until connecting pins snap in place. 3. Pull jack lever outward and 		<p>A</p> <ol style="list-style-type: none"> 1. Place cab control in "Lower/Float". 2. Push lift arm down. 3. Pull jack lever outward. Jack stand will adjust to proper height.

SAFETY

Minute Mount® 2 System with EZ-V® Snowplow

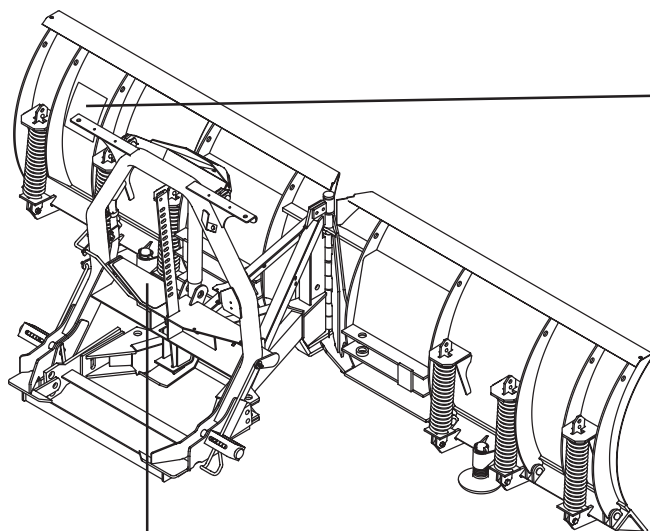

Instruction Label

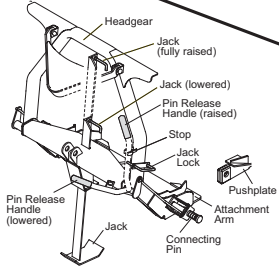

1. Push **Pin Release Handle** down to pull out **Connecting Pins**.
2. Drive vehicle slowly to engage **Pushplates** into **Attachment Arms**.
3. Stand in front of blade. Fully raise **Pin Release Handle** to release **Connecting Pins**.
4. Push **Headgear** toward vehicle to allow **Connecting Pins** to fully engage **Pushplates**.
5. Pull out **Jack Lock**. Push **Pin Release Handle** into **Stop**.
6. While holding **Jack Lock** out, use **Jack Handle** to raise **Jack** fully. Release **Jack Lock**.
7. Attach all electrical connectors.

ATTACH

1. Place control in **Lower/Float** to put blade down.
2. Pull and hold **Jack Lock** out. **Jack** will drop to ground. Then pull **Pin Release Handle** away from **Stop** and **Jack Lock**. Release **Jack Lock**.
3. Stand in front of blade. While pushing **Headgear** toward vehicle with left hand, push **Pin Release Handle** down to disengage **Connecting Pins**. Make sure **Connecting Pins** are fully retracted.
4. Detach all electrical connectors.

U.S. Patents 4,280,062; 4,999,935; 5,353,530; 5,420,480; RE 35,700; 6,253,470; CAN Patent 2,060,425; and other patents pending.

Read Owner's Manual For Complete Instructions

27455

Warning/Caution Label

WARNING

LOWER BLADE WHEN VEHICLE IS PARKED.

REMOVE BLADE ASSEMBLY BEFORE PLACING VEHICLE ON HOIST.

DO NOT EXCEED GVWR OR GAWR INCLUDING BLADE AND BALLAST.

CAUTION

READ OWNER'S MANUAL BEFORE OPERATING OR SERVICING SNOWPLOW.

TRANSPORT SPEED SHOULD NOT EXCEED 45 MPH. REDUCE SPEED UNDER ADVERSE TRAVEL CONDITIONS.

PLOWING SPEED SHOULD NOT EXCEED 10 MPH.

SEE YOUR SALES OUTLET FOR APPLICATION RECOMMENDATIONS.

Original Minute Mount® System with EZ-V Snowplow

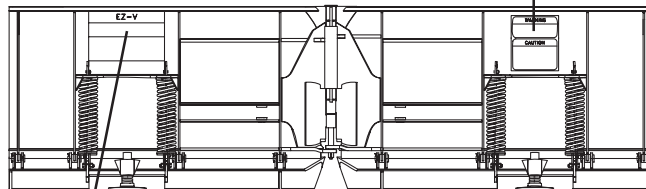

Instruction Label









Snowplow

U.S. Patent
 4,280,062; 4,999,935;
 5,353,530; 5,420,480
 and other patents pending

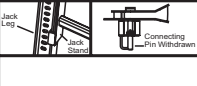
MOUNTING PLOW

1. Drive vehicle forward fully engaging pushplates into attachment arms.
2. Twist connecting pin to release tension.
3. Remove electrical covers on vehicle.
4. Attach electrical connector to corresponding connector on vehicle.
5. Repeat these steps on passenger side of vehicle.
6. Release carrying chain and reattach it leaving plenty of slack.
7. Push headgear upward toward vehicle until connecting pins snap in place.
8. Pull jack lever outward and raise the jack leg.

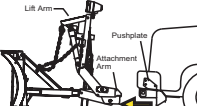
PLOW REMOVAL

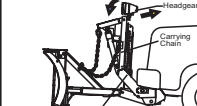
9. Remove slack from carrying chain and reattach.
10. Back vehicle away from plow.
5. Disconnect electrical connectors and cover with protective covers.
6. Insert release rod in lowest possible slot on jack leg above A-frame.
7. Push down on release rod as you pull and twist connecting pin.
8. Repeat these steps on passenger side of vehicle.
1. Position blade in the "straight" mode before removing.
2. Place control in "Lower" mode.
3. Push lift arm down.
4. Pull jack lever outward. Jack leg will adjust to proper height.

27755

SAFETY

Homesteader™ Personal Plow

Warning/Caution Label

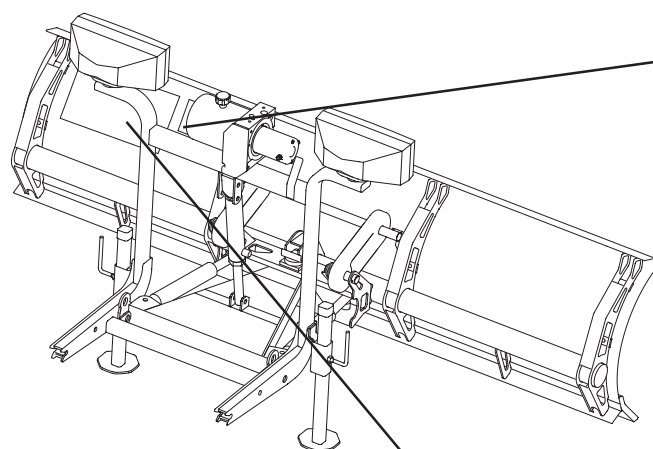

WARNING

LOWER BLADE WHEN VEHICLE IS PARKED.

REMOVE BLADE ASSEMBLY BEFORE PLACING VEHICLE ON HOIST.

DO NOT EXCEED GVWR OR GAWR INCLUDING BLADE AND BALLAST.



CAUTION

READ *OWNER'S MANUAL* BEFORE OPERATING OR SERVICING SNOWPLOW.

TRANSPORT SPEED SHOULD NOT EXCEED 45 MPH. REDUCE SPEED UNDER ADVERSE TRAVEL CONDITIONS.

PLOWING SPEED SHOULD NOT EXCEED 10 MPH.

SEE YOUR SALES OUTLET FOR APPLICATION RECOMMENDATIONS.

Instruction Label

This snowplow is for personal/homeowner use only.

ATTACH INSTRUCTIONS

1. Make certain both **connecting pins** are fully retracted.
2. Drive vehicle slowly to completely insert **attachment arms** into **receiver assembly** slots.
3. Twist both **connecting pins** to release spring tension, then push **plow gear** toward vehicle so **connecting pins** fully engage holes in **attachment arms**.
4. Loosen one **jack handle** and slide **jack sleeve** down below **jack retainer**. Remove **jack** and retighten **jack handle**. Repeat for other **jack** and store them.
5. Connect all electrical cables from vehicle to snowplow.

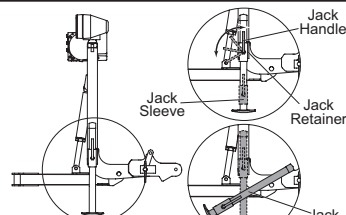
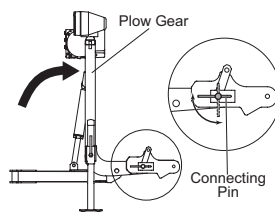
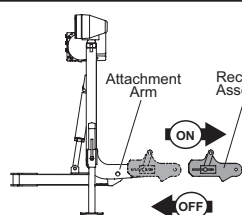

U.S. Patents 4,999,935; 5,420,480; 6,253,470; RE35,700; CAN Patent 2,060,425; and other patents pending.

27155

5. Back vehicle away from snowplow.

6. See Owner's Manual for proper snowplow storage.

3. While pushing **plow gear** toward vehicle to release **connecting pin** tension, pull **connecting pin** out on one side and twist pin handle to keep pin retracted. Repeat procedure for other **connecting pin**.
4. Disconnect all electrical cables.

1. Put blade on ground using LOWER/FLOAT on snowplow control. Leave control ON and in FLOAT.
2. Attach **jacks**. Loosen **jack handle**, put **jack** on ground, and raise **jack sleeve** until fully engaging **jack retainer**. Tighten **jack handle**. Repeat for other **jack**.

DETACH INSTRUCTIONS

Read Owner's Manual for Complete Instructions

ISOLATION MODULE TEST PROCEDURE

TEST PREPARATION

⚠ CAUTION

Read this document before testing any FISHER® snowplows.

- When connecting the Isolation Module Tester to the battery, connect the red clip to the positive terminal and the black clip to the negative terminal. Connect the black clip last. When disconnecting, disconnect it first.
- If an Isolation Module Tester lamp (tester lamps are white, tester LED's are green and slightly smaller) does not come on, the fault could be an open lamp element, an open circuit, or both.
- All vehicle lamps must be operational. An open lamp may cause false test results.
- The Isolation Module Tester is protected by a fuse inside the tester that automatically resets itself. If the fuse activates, disconnect power from the Isolation Module Tester and wait several minutes. Then resume the test.
- The table below lists the user-serviceable parts inside the Isolation Module Tester.

Replacement Parts		
Part	Qty	Description
26475	5	Replacement Lamps
26476	1	Replacement Harness Kit
26517	1	Replacement Case w/Label

ISOLATION MODULE ON-VEHICLE TEST

Set-Up

Before connecting the Isolation Module Tester to the Isolation Module, ensure the Isolation Module Tester switches are in the following positions.

Isolation Module Tester Switch	Position
POWER	OFF
PARK LAMPS	OFF
HEADLAMPS	LOW
PLOW ATTACHED	NO
IGNITION SWITCH	OFF
HEADLAMP COMMON	NEG (-)
HIGH BEAM #2	OFF
DEDICATED DRL BULB SYSTEM	OFF

Connection

Connect the Isolation Module Tester to the Isolation Module as follows:

- Connect the Isolation Module Tester power cable to a 12-volt power source by attaching the red alligator clip to positive and the black alligator clip to negative.
- Connect the Adapter Cable (part number 26472) to the Isolation Module Tester harness 2.
- Connect the molded connector of the Adapter Cable to the vehicle lighting harness connector located at the grille of the vehicle. Isolation Module Tester harnesses 1, 3, and 4 are not used for this test.

Test Procedure

- Turn the vehicle's ignition on, but **do not start engine**. Verify the vehicle's lights function properly by cycling the vehicle's park, turn, hazard, high beams, low beams, and DRL lamps. Then place the vehicle's headlamp switch in the low beam position. Turn off all vehicle lighting. Repair or replace any defective vehicle lamps before proceeding.
- Turn the Isolation Module Tester POWER switch to the ON position. Only the POWER indicator should light.

ISOLATION MODULE TEST PROCEDURE

3. Turn on the vehicle's parking lamps. Verify the vehicle's parking lamps are on.
4. Turn on the vehicle's headlamps. Verify the vehicle's low beams are on.
5. Place the Isolation Module Tester PLOW ATTACHED switch in the YES position. Verify the vehicle's low beams go off and the following Isolation Module Tester indicators are lit: PLOW ATTACHED, plow PARK LIGHTS, and both plow LOW BEAMS.
6. Place the vehicle's headlamps in the high beam position. The Isolation Module Tester plow HIGH BEAM indicators should light.
7. Turn on the vehicle's left turn signal. Verify the vehicle's left turn signal is functioning properly and the Isolation Module Tester left TURN SIGNAL indicator is lit. Turn off vehicle's left turn signal.
8. Turn on the vehicle's right turn signal. Verify the vehicle's right turn signal is functioning properly and the Isolation Module Tester right TURN SIGNAL indicator is lit. Turn off vehicle's right turn signal.
9. Activate the vehicle's four-way flashers. Both the vehicle's turn signal lamps and the Isolation Module Tester TURN SIGNAL indicators should be flashing. Turn off the vehicle's four-way flashers.
10. Place the Isolation Module Tester PLOW ATTACHED switch in the NO position. The Isolation Module Tester HIGH BEAM, PARK LIGHTS and PLOW ATTACHED indicators should go off and the vehicle's high beams should be on.
11. Place the vehicle in the DRL mode. Verify the vehicle's DRL's are functioning properly.
12. Place the Isolation Module Tester PLOW ATTACHED switch in the YES position. The vehicle's DRL's should transfer to the Isolation Module Tester. The Isolation Module Tester mimics the vehicle's DRL's when the PLOW ATTACHED switch is in the YES position.

NOTE: Due to the many DRL systems available, it is the responsibility of the installer to fully understand the operation of the system being tested.

13. Return the Isolation Module Tester PLOW ATTACHED switch to the NO position. Place the Isolation Module Tester POWER switch in the OFF position. Turn the vehicle's ignition off. The vehicle portion of the test is complete. If the system passes, remove the Isolation Module Tester from the vehicle.

If the system fails the vehicle portion of the test, remove the adapter cable (part number 26472) from the Isolation Module Tester cable. Unplug the vehicle lighting harness from position 2 of the Isolation Module. Connect the Isolation Module Tester harness 2 to position 2 of the Isolation Module. Rerun the vehicle portion of the test from the beginning.

ISOLATION MODULE TEST PROCEDURE

ISOLATION MODULE 26400 (WHITE LABEL) OFF-VEHICLE TEST

Set-Up

Before connecting the Isolation Module Tester to the Isolation Module, ensure the Isolation Module Tester switches are in the following positions.

Isolation Module Tester Switch	Position
POWER	OFF
PARK LAMPS	OFF
HEADLAMPS	LOW
PLOW ATTACHED	NO
IGNITION SWITCH	OFF
HEADLAMP COMMON	NEG (-)
HIGH BEAM #2	OFF
DEDICATED DRL BULB SYSTEM	OFF

Connection

Connect the Isolation Module Tester to the Isolation Module as follows:

1. Connect Isolation Module Tester cable 1 to Isolation Module connector 1.
2. Connect Isolation Module Tester cable 2 to Isolation Module connector 2.
3. Connect Isolation Module Tester cable 3 to Isolation Module connector 3.
4. Connect Isolation Module Tester cable 4 to Isolation Module connector 4.
5. Connect the Isolation Module Tester power cable to a 12-volt power source by attaching the red alligator clip to positive and the black alligator clip to negative.

Test Vehicle Lights

1. Place the Isolation Module Tester POWER switch in the ON position. The green power indicator should light.
2. Place the PARK LAMPS switch in the ON position. The left and right side tester vehicle LOW BEAM lamps should light.

3. Place the HEADLAMP COMMON switch in the NEG (-) position and listen for the "click" of the configuration relay inside the Isolation Module Tester. The LOW BEAM indicator flickers as the relay changes state. Cycle the switch several times to verify the relay is functioning properly. Return the switch to the NEG(-) position.
4. Place the HEADLAMP switch in the HIGH position. The tester vehicle HIGH BEAM indicators should light.
5. Place the HIGH BEAM #2 switch in the ON position. The tester vehicle HIGH BEAM and HIGH BEAM #2 indicators should light. Release the switch and only the HIGH BEAM indicators should remain on.

Test Snowplow Lights

1. Place the PLOW ATTACHED switch in the YES position. The green PLOW ATTACHED indicator should light and both plow HIGH BEAM indicators and the plow PARK LIGHTS indicator should light.
2. Place the HEADLAMPS switch in the LOW position. The plow LOW BEAM indicators and PARK LIGHTS should light.
3. Place the IGNITION switch in the ON position. The green IGNITION SWITCH and CONTROL POWER indicators should light.
4. Press and hold the TURN SIGNAL switch in the LEFT position. The plow left TURN SIGNAL indicator should light. Release the switch.
5. Press and hold the TURN SIGNAL switch in the RIGHT position. The plow right TURN SIGNAL indicator should light. Release the switch.

The Isolation Module Test is complete. Turn the Isolation Module Tester OFF and disconnect the Isolation Module. Disconnect the Isolation Module Tester from the power source.

ISOLATION MODULE TEST PROCEDURE

ISOLATION MODULE 27781 (LIGHT GREEN LABEL) OFF-VEHICLE TEST

Set-Up

Before connecting the Isolation Module Tester to the Isolation Module, ensure the Isolation Module Tester switches are in the following positions.

Isolation Module Tester Switch	Position
POWER	OFF
PARK LAMPS	OFF
HEADLAMPS	LOW
PLOW ATTACHED	NO
IGNITION SWITCH	OFF
HEADLAMP COMMON	NEG (-)
HIGH BEAM #2	OFF
DEDICATED DRL BULB SYSTEM	OFF

Connection

Connect the Isolation Module to the Isolation Module Tester as follows:

1. Connect Isolation Module Tester cable 1 to Isolation Module connector 1.
2. Connect Isolation Module Tester cable 2 to Isolation Module connector 2.
3. Connect Isolation Module Tester cable 3 to Isolation Module connector 3.
4. Connect Isolation Module Tester cable 4 to Isolation Module connector 4.
5. Connect the Isolation Module Tester power cable to a 12-volt power source by attaching the red alligator clip to positive and the black alligator clip to negative.

Test Vehicle Lights

1. Place the Isolation Module Tester POWER switch in the ON position. The green power indicator should light.
2. Place the PARK LAMPS switch in the ON position. The left and right side tester vehicle LOW BEAM indicators should light.
3. Place the HEADLAMPS switch in the HIGH position. The tester vehicle HIGH BEAM indicators should light.

Test Snowplow Lights

1. Place the PLOW ATTACHED switch in the YES position. The green PLOW ATTACHED indicator should light and both plow HIGH BEAM indicators and the plow PARK LIGHTS indicator should light.
2. Place the HEADLAMPS switch in the LOW position. The plow LOW BEAM and PARK LIGHTS indicators should now light.
3. Place the IGNITION switch in the ON position. The green IGNITION SWITCH and CONTROL POWER indicators should light.
4. Press and hold the TURN SIGNAL switch in the LEFT position. The plow left TURN SIGNAL indicator should light. Release the switch.
5. Press and hold the TURN SIGNAL switch in the RIGHT position. The plow right TURN SIGNAL lamp should light. Release the switch.
6. Place the HEADLAMPS switch in the LOW position. The plow LOW BEAM indicators should light.
7. Place the DEDICATED DRL BULB SYSTEM switch in the ON position. The plow LOW BEAM indicators should dim.
8. Return the DEDICATED DRL BULB SYSTEM switch to the OFF position. The plow LOW BEAM indicators should return to their full brightness.

The Isolation Module Test is complete. Turn the Isolation Module Tester OFF and disconnect the Isolation Module. Disconnect the Isolation Module Tester from the power source.

ISOLATION MODULE TEST PROCEDURE

ISOLATION MODULE 26401 (YELLOW LABEL) OFF-VEHICLE TEST

Set-Up

Before connecting the Isolation Module Tester to the Isolation Module, ensure the Isolation Module Tester switches are in the following positions.

Isolation Module Tester Switch	Position
POWER	OFF
PARK LAMPS	OFF
HEADLAMPS	LOW
PLOW ATTACHED	NO
IGNITION SWITCH	OFF
HEADLAMP COMMON	POS (+)
HIGH BEAM #2	OFF
DEDICATED DRL BULB SYSTEM	OFF

Connection

Connect the Isolation Module to the Isolation Module Tester as follows:

1. Connect Isolation Module Tester cable 1 to Isolation Module connector 1.
2. Connect Isolation Module Tester cable 2 to Isolation Module connector 2.
3. Connect Isolation Module Tester cable 3 to Isolation Module connector 3.
4. Connect Isolation Module Tester cable 4 to Isolation Module connector 4.
5. Connect the Isolation Module Tester power cable to a 12-volt power source by attaching the red alligator clip to positive and the black alligator clip to negative.

Test Vehicle Lights

1. Place the Isolation Module Tester POWER switch in the ON position. The green power indicator should light.
2. Place the PARK LAMPS switch in the ON position. The left and right side tester vehicle LOW BEAM indicators should light.
3. Place the HEADLAMPS switch in the HIGH position. The tester vehicle HIGH BEAM indicators should light.

Test Snowplow Lights

1. Place the PLOW ATTACHED switch in the YES position. The green PLOW ATTACHED indicator should light and both plow HIGH BEAM indicators and the plow PARK LIGHTS indicator should light.
2. Place the HEADLAMPS switch in the LOW position. The plow LOW BEAM and PARK LIGHTS indicators should now light.
3. Place the IGNITION switch in the ON position. The green IGNITION SWITCH and CONTROL POWER indicators should light.
4. Press and hold the TURN SIGNAL switch in the LEFT position. The plow left TURN SIGNAL indicator should light. Release the switch.
5. Press and hold the TURN SIGNAL switch in the RIGHT position. The plow right TURN SIGNAL lamp should light. Release the switch.
6. Place the HEADLAMPS switch in the HIGH position. The plow HIGH BEAM indicators should light.
7. Place the DEDICATED DRL BULB SYSTEM switch in the ON position. The plow HIGH BEAM indicators should dim.
8. Return the DEDICATED DRL BULB SYSTEM switch to the OFF position. The plow HIGH BEAM indicators should return to their full brightness.

The Isolation Module Test is complete. Turn the Isolation Module Tester OFF and disconnect the Isolation Module. Disconnect the Isolation Module Tester from the power source.



Fisher Engineering
P.O. Box 529
Rockland, ME 04841



A DIVISION OF DOUGLAS DYNAMICS, L.L.C.

Copyright© 2003 Douglas Dynamics, L.L.C. All rights reserved. This material may not be reproduced or copied, in whole or in part, in any printed, mechanical, electronic, film or other distribution and storage media, without the written consent of Fisher Engineering. Authorization to photocopy items for internal or personal use by Fisher Engineering outlets or snowplow owner is granted.

Fisher Engineering reserves the right under its product improvement policy to change construction or design details and furnish equipment when so altered without reference to illustrations or specifications used. Fisher Engineering and the vehicle manufacturer may require and/or recommend optional equipment for snow removal. Do not exceed vehicle ratings with a snowplow. Fisher Engineering offers a limited warranty for all snowplows and accessories. See separately printed page for this important information. The following are registered (®) and unregistered (™) trademarks of Douglas Dynamics, L.L.C.: EZ-V® FISHER®, Fish-Stik®, Homesteader™, Minute Mount®, Minute Mount® 2.

Printed in USA

April 28, 2003

Lit. No. 26473