

Fisher Engineering

September 11, 2003
Lit. No. 27448

HYDRAULIC AND ELECTRICAL HARNES REFERENCE GUIDE

**FOR EZ-V[®] AND STRAIGHT BLADE SNOWPLOWS
EQUIPPED WITH Insta-Act[®] OR SEHP HYDRAULIC SYSTEMS**

STRAIGHT BLADE WITH 8225/8240/8425 (SEHP) HYDRAULIC SYSTEM AND 8416-X⁽¹⁾/8417/8430-X⁽¹⁾ LIGHTING

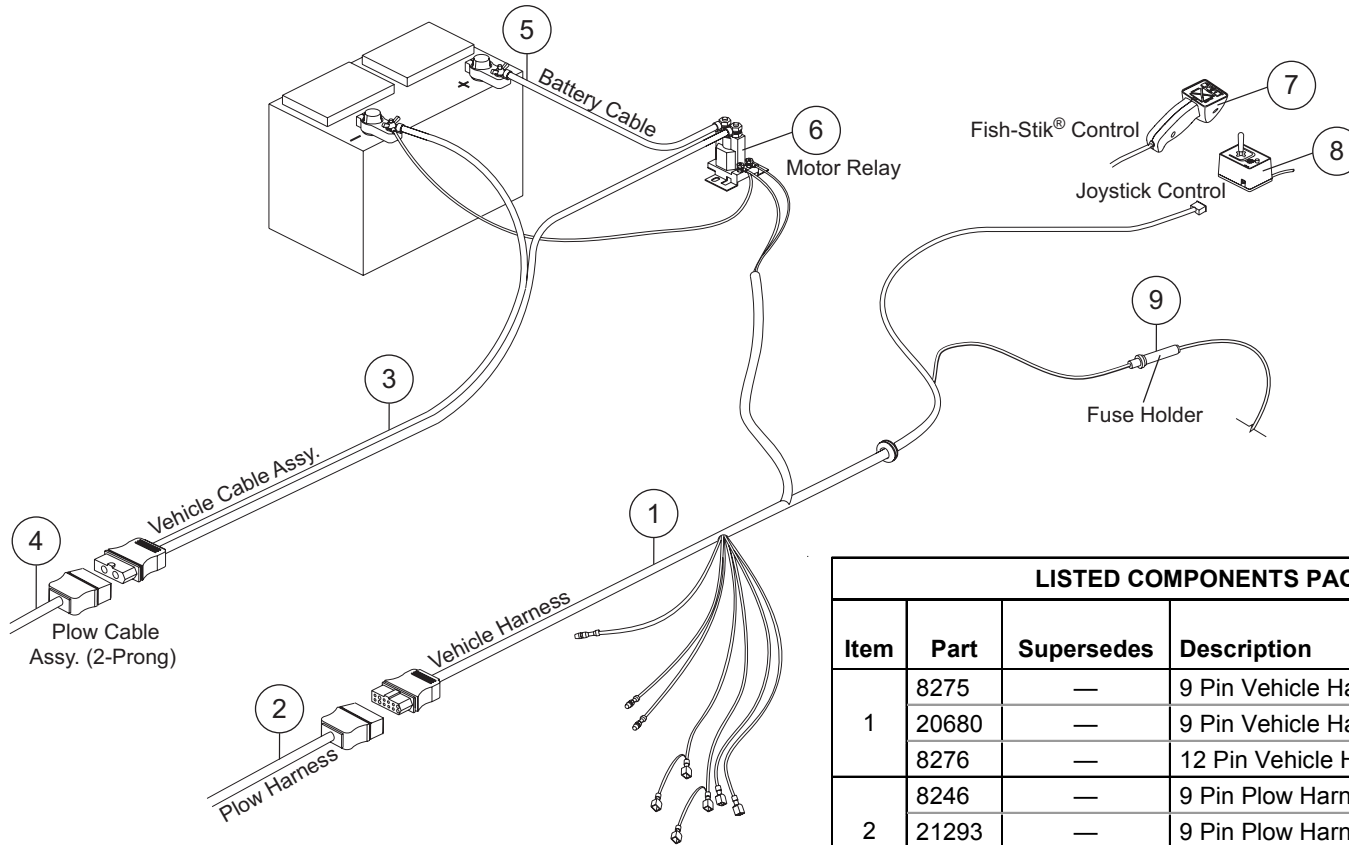

LISTED COMPONENTS PACKED IN THE FOLLOWING KITS:

Item	Part	Supersedes	Description	Hydraulic Kits	Common Light Kits ⁽¹⁾
1	8275	—	9 Pin Vehicle Harness	—	8416-X
	20680	—	9 Pin Vehicle Harness	—	8430-X
	8276	—	12 Pin Vehicle Harness	—	8417
2	8246	—	9 Pin Plow Harness	—	8416
	21293	—	9 Pin Plow Harness	—	8416-1,8430-X
	8273	—	12 Pin Plow Harness	—	8417
3	61169	8274	Vehicle Cable Assembly	8225,8240	—
	21330	—	Vehicle Cable Assembly	8425	—
4	8245	—	Plow Cable Assembly	8225,8240,8425	—
5	22511	5799	Battery Cable-22" Red	8225,8240	—
	20681	—	Battery Cable-50" Red	8425	—
6	5794K	—	Motor Relay	8225,8240,8425	—
7	9400	—	Fish-Stik [®] Control	Sold Separately	—
8	8292	—	Joystick Control		—
9	80168	—	Replacement Fuse (5 Pack)		—

⁽¹⁾ "X" indicates information is applicable to all revisions of the kit.

EZ-V® PLOW WITH 8428 Insta-Act® HYDRAULIC SYSTEM AND 8427 LIGHTING

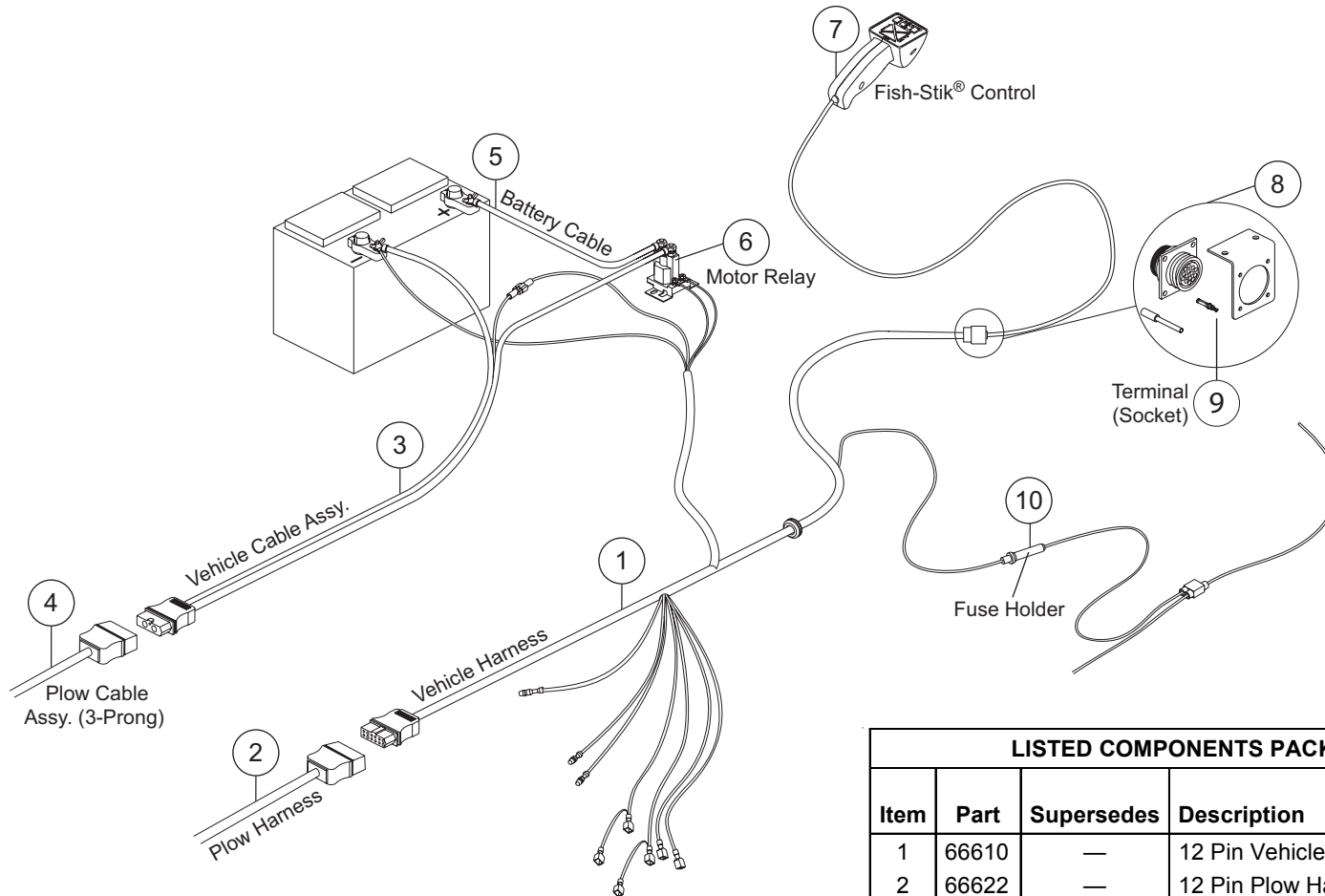

3

LISTED COMPONENTS PACKED IN THE FOLLOWING KITS:

Item	Part	Supersedes	Description	Hydraulic Kits	Common Light Kits
1	66610	—	12 Pin Vehicle Harness	—	8427
2	66622	—	12 Pin Plow Harness	—	8427
3	66623	—	Vehicle Cable Assembly	8428	—
4	66624	—	Plow Cable Assembly	8428	—
5	22511	5799	Battery Cable-22" Red	8428	—
6	5794K	—	Motor Relay	8428	—
7	66636	—	V-Plow Control	8428	—
8	56496	—	V-Plow Connector, Bagged Assy.	9828-X ⁽¹⁾	8427
9	22123	—	Replacement Terminal (10 Pack)	Sold Separately	
10	80168	—	Replacement Fuse (5 Pack)		

(1) "X" indicates information is applicable to all revisions of the kit.

STRAIGHT-BLADE OR EZ-V® PLOW WITH Insta-Act® HYDRAULIC SYSTEM AND 8435 E-FORCE LIGHTING

PARTS LOCATION MATRIX			LISTED COMPONENTS PACKED IN THE FOLLOWING KITS:		
Item	Part	Description	Plug-In Harness Kits	Hydraulic Kits ⁽³⁾	Headlamp Kit
1	26400	E-Force Isolation Module (White Label)	8436,8438,8439,8442,8443,27480,27890,28028,28400	-	-
	27781	E-Force Isolation Module (Light Green Label) ⁽¹⁾	8437,27780	-	-
2	26357	Vehicle Lighting Harness – 11 Pin	All	-	-
3	26349	Plug-In Harness, Short, HB-1/HB-5	8436	-	-
	26361	Plug-In Harness, Short, GMC Sierra/Chevy Silverado	8437,27480 ⁽²⁾	-	-
	26351	Plug-In Harness, Short, HB-3/HB-4	8438,27780 ⁽²⁾	-	-
	26356	Plug-In Harness, Short, 2B/2D/HB2	8439	-	-
	26372	Plug-In Harness, Short, HB-1/HB-5 Dodge 4 Light	8442	-	-
	27885	Plug-In Harness, Short, GM 4500/5500	27890	-	-
	28032	Plug-In Harness, Short, GMC Envoy/Chevy Trail Blazer	28028	-	-
	28244	Plug-In Harness, Short, H13	28400	-	-
4	26354	Plug-In Harness, Long, HB-1/HB-5	8436	-	-
	26360	Plug-In Harness, Long, GMC Sierra/Chevy Silverado	8437,27480 ⁽²⁾	-	-
	26352	Plug-In Harness, Long, HB-3/HB-4	8438,27780 ⁽²⁾	-	-
	26353	Plug-In Harness, Long, 2B/2D/HB2	8439	-	-
	26370	Plug-In Harness, Long, HB-1/HB-5 Dodge 4 Light	8442	-	-
	27886	Plug-In Harness, Long, GM 4500/5500	27890	-	-
	28030	Plug-In Harness, Long, GMC Envoy/Chevy Trail Blazer	28028	-	-
	28242	Plug-In Harness, Long, H13	28400	-	-
not shown	22381	Adapter Kit, Side-Post Battery	8437,8438,27480,27780,28028	-	-
	26273	Adapter Kit, Dodge Sport Package	8442	-	-
	26636	Plug-In Harness Extension – 90", Ford/International MC	26640 Adapter Kit	-	-
	26638	Plug-In Harness, Topkick/Kodiak	8443	-	-
	26642	Adapter Cable, HB-5 Female to 1A/2A (Set of 2), Mitsubishi FG	26641 Adapter Kit	-	-
	26643	Adapter Cable, HB-5 Male to 1A/2A (Set of 2), Mitsubishi FG	26641 Adapter Kit	-	-
	26661	Cable Clamp Kit	8443	-	-
	27968	Adapters, 2B to 2E (Set of 2)	Sold Separately	-	-
	28027	Adapter Kit, In-Line, Ford Explorer	Sold Separately	-	-
	64128	Motor Relay Bracket	27890	-	-
5	26347	Plow Lighting Harness - 11 Pin	-	-	8435
6	26420	Dust Cover Plug	8437,27780	-	-
	26421	Configuration Plug	8436,8438,8439,8442,8443,27480,27890,28028,28400	-	-
7	63411	Vehicle Battery Cable	-	9825-X,9835-1,9840-X,9828-X	-
8	22511	Battery Cable 22" Red	-	9825-X,9835-1,9840-X,9828-X	-
	20681	Battery Cable 50" Red	8443,26641 Adapter Kit	-	-
	21563	Battery Cable 90" Red	26640 Adapter Kit	-	-
9	5794K	Motor Relay	-	9825-X,9835-1,9840-X,9828-X	-
10	26359	3 Pin Plow Control Harness (Straight Blade)	-	9825-X,9835-1,9840 – X	-
	26358	7 Pin Plow Control Harness (V-Plow)	-	9828-X	-
11	21294	Plow Battery Cable	-	9825-X,9835-1,9840-X,9828-X	-
12	26345	3 Pin Vehicle Control Harness (Straight Blade)	-	9825-X,9835-1,9840 – X	-
	26346	7 Pin Vehicle Control Harness (V-Plow)	-	9828-X	-
13	66636	V-Plow Fish-Stik® Control	-	9828-X	-
14	56496	V-Plow Connector, Bagged Assembly	-	9828-X	-
15	9400	Fish-Stik Control (Straight Blade)	Sold Separately	-	-
16	8292	Joystick Control (Straight Blade)		-	-

⁽¹⁾ Supersedes Yellow Label.

⁽²⁾ Requires Rev. 3 harness or higher.

⁽³⁾ "-X" indicates information is applicable to all revisions of the kit.

STRAIGHT-BLADE OR EZ-V® PLOW WITH Insta-Act® HYDRAULIC SYSTEM⁽¹⁾ AND 8435 E-FORCE LIGHTING

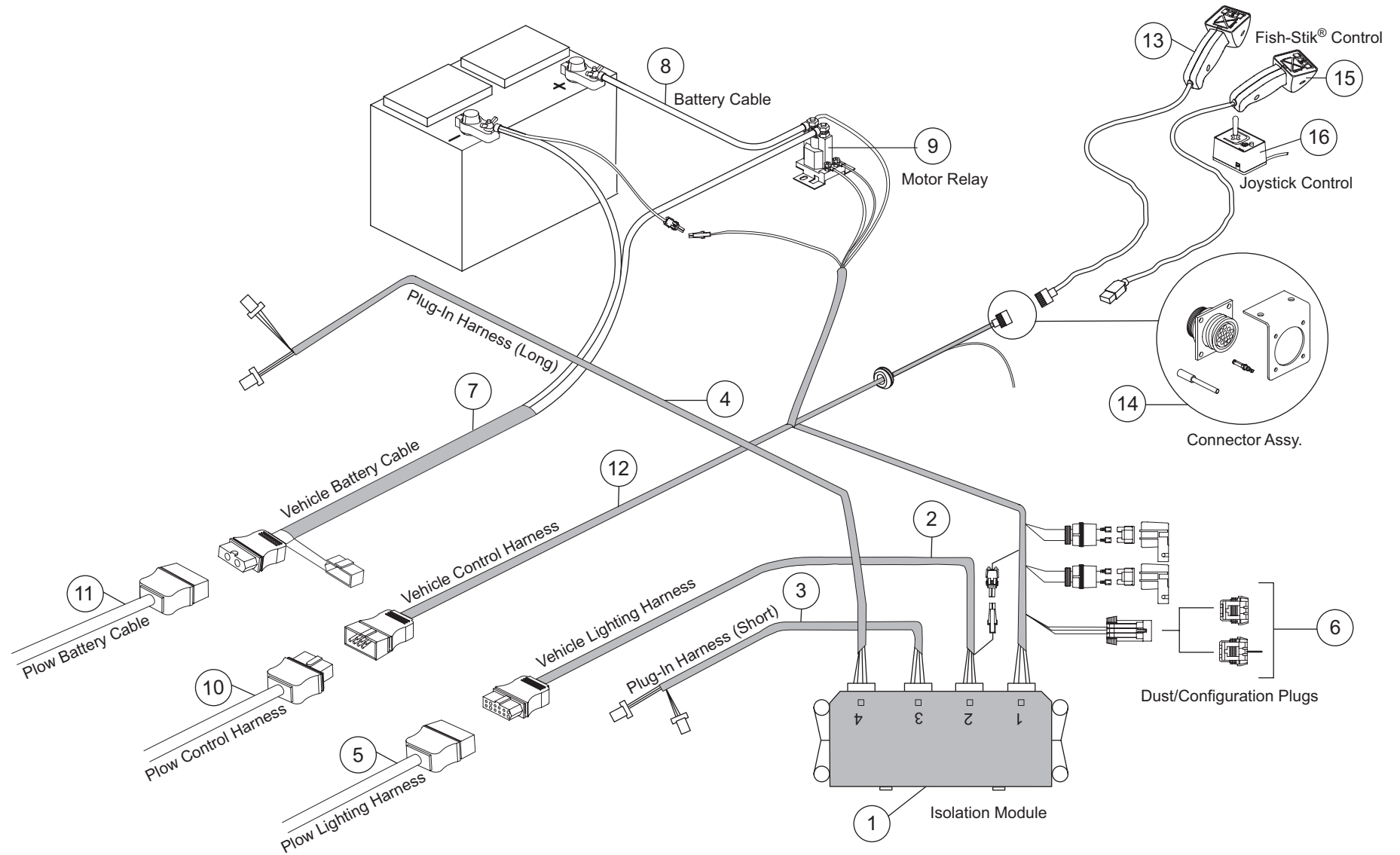

RAM AND CONTROL HARNESS SELECTION CHARTS

Insta-Act [®] System Control Harnesses					
	Kit Number				
	9825-X	9828-X	9835	9835-1	9840-X
Vehicle Control Harness	26345	26346	NA – In 8430-X Light Kit	26345	26345
Plow Control Harness	26359	26358		26359	26359

Harness Repair Ends		
	Harness	Repair End
E-Force Lighting	26345	27063K
	26346	27067K
Original MM Lighting	8612	22334K
	8246/ 21293	22335K
	8275	22336K
	8273/ 21713	22337K
	8276	22338K

Ram Selection Chart											
	Kit Number										
	9825	9825-1	9828	9828-1	9828-2	9828-3	9835	9835-1	9840	9840-1**	9840-2
Lift Ram	A5096	56718*	20116K	20116K	56600K*	56600K*	A3463	56740*	20116K	56600K*	56600K*
Angle Ram	20116K	56600K*	66375	56546	56546	64297*	A5166K	A5166K	20117K	20117K	56603K*

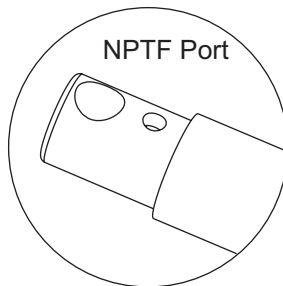

** In 9840-1 kit only, lift ram requires part #56723 adapter fitting.

Replacement Rod Assemblies		
Ram	Stroke	Rod Part #
A3463	2" x 10"	3626
A5096	1-1/2" x 6"	21824
A5166K	2" x 16"	6995
20116K	1-1/2" x 10"	20618
20117K	1-1/2" x 12"	20601
56600K*	1-1/2" x 10"	26981
56603K*	1-1/2" x 12"	56715
64297*	2" x 10"	66394
56718*	1-1/2" x 6"	56717
56740*	2" x 10"	64152

E-FORCE PLUG-IN REFERENCE GUIDE

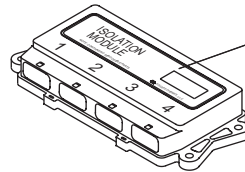

Part Description

26400 Isolation Module (White Label)

26401 Isolation Module (Yellow Label)

1999–2002 GMC Sierra & Chevy Silverado

27781 Isolation Module (Light Green Label)

1999–20__ GMC Sierra & Chevy Silverado**

8436, 8437, 8438, 8439, 8442, 8443, 27480, 27780, 27890, 28028, 28400 Plug-In Harness Kits												
Part	Description	Qty										
		8436	8437	8438	8439	8442	8443	27480	27780	27890	28028	28400
26354	Plug-In Harness, HB-1/HB-5, Long	1										
26349	Plug-In Harness, HB-1/HB-5, Short	1										
26360	Plug-In Harness, HB-3/HB-4, Long 1999–20__ GMC Sierra/Chevy Silverado		1					1**				
26361	Plug-In Harness, HB-3/HB-4, Short 1999–20__ GMC Sierra/Chevy Silverado		1					1**				
26352	Plug-In Harness, HB-3/HB-4, Long			1					1**			
26351	Plug-In Harness, HB-3/HB-4, Short			1					1**			
26353	Plug-In Harness, 2B/2D, Long				1							
26356	Plug-In Harness, 2B/2D, Short				1							
26370	Plug-In Harness, Dodge Quad, Long					1						
26372	Plug-In Harness, Dodge Quad, Short					1						
26638	Plug-In Harness, Topkick/Kodiak						1					
27886	Plug-In Harness, GM 4500/5500, Long									1		
27885	Plug-In Harness, GM 4500/5500, Short									1		
28030	Plug-In Harness, GMC Envoy/Chevy Trail Blazer, Long										1	
28032	Plug-In Harness, GMC Envoy/Chevy Trail Blazer, Short										1	
28242	Plug-In Harness. H13, Long											1
28244	Plug-In Harness. H13, Short											1
26357	Vehicle Lighting Harness – 11-pin	1	1	1	1	1	1	1	1	1	1	1
26400	Isolation Module (White Label)	1		1	1	1	1	1		1	1	1
27781	Isolation Module (Light Green Label) * 1999–20__ GMC Sierra & Chevy Silverado		1						1			

* Supersedes the Yellow Label.

** Must be Revision 3 or higher.



Fisher Engineering
P.O. Box 529
Rockland, ME 04841

8

 A DIVISION OF DOUGLAS DYNAMICS, L.L.C.

Copyright © 2003 Douglas Dynamics, L.L.C. All rights reserved. This material may not be reproduced or copied, in whole or in part, in any printed, mechanical, electronic, film or other distribution and storage media, without the written consent of Fisher Engineering. Authorization to photocopy items for internal or personal use by Fisher Engineering outlets or snowplow owner is granted.

Fisher Engineering reserves the right under its product improvement policy to change construction or design details and furnish equipment when so altered without reference to illustrations or specifications used. Fisher Engineering and the vehicle manufacturer may require and/or recommend optional equipment for snow removal. Do not exceed vehicle ratings with snowplow. This product is manufactured under the following US patents: 4,999,935; 5,353,530; 5,420,480; 6,253,470; RE35700; CAN Patent 2,060,425; and other patents pending. Fisher Engineering offers a limited warranty on all snowplows and accessories. See separately printed page for this important information. The following are registered® and unregistered™ trademarks of Douglas Dynamics, L.L.C.: EZ-V®, FISHER®, Fish-Stik®, Insta-Act®.

Printed in U.S.A.