

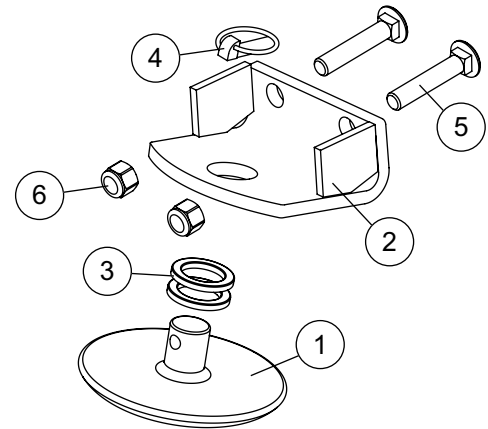

Curb & Wear Shoe Kits for XBLADE™ Snowplows

| 28367 XBLADE Wear Shoe Kit | | | |
|-----------------------------------------------------------|-------|-----|-----------------------------|
| Item | Part | Qty | Description |
| 1 | 26229 | 2 | Shoe – 7" Solid Cast |
| 2 | 26232 | 2 | Shoe Bracket |
| ns | 28371 | 1 | Bolt Bag for Wear Shoe Kit |
| 28371 Bolt Bag for Wear Shoe Kit | | | |
| 3 | 307-1 | 4 | Shoe Spacer |
| 4 | 308K | 2 | Packet – Shoe Pin |
| 5 | 90264 | 4 | 5/8-11 x 3 Carriage Bolt G5 |
| 6 | 91337 | 4 | 5/8-11 Hex Locknut GB |
| ns = not shown G = grade ZYC = zinc yellow chromate | | | |



| 27487-1 XBLADE Curb Shoe Kit | | | |
|----------------------------------|-------|-----|-----------------------------|
| Item | Part | Qty | Description |
| 7 | 26233 | 1 | Curb Shoe – DS |
| 8 | 26234 | 1 | Curb Shoe – PS |
| ns | 27513 | 1 | Bolt Bag for Curb Shoe Kit |
| 27513 Bolt Bag for Curb Shoe Kit | | | |
| 5 | 90264 | 4 | 5/8-11 x 3 Carriage Bolt G5 |
| 6 | 91337 | 4 | 5/8-11 Hex Locknut GB |
| ns = not shown G = grade | | | |

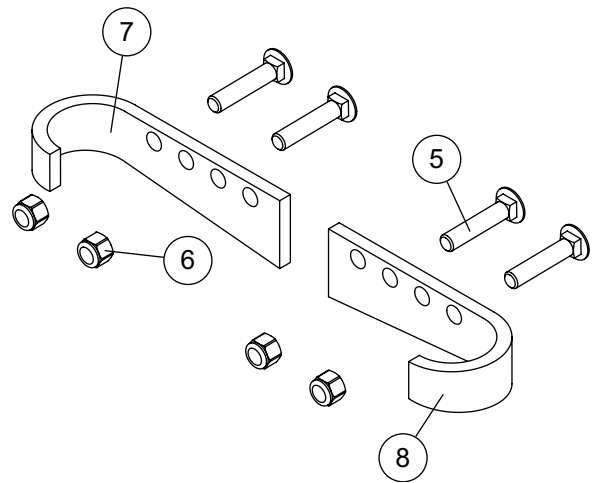

⚠ WARNING

Do not exceed GVWR or GAWR including blade and ballast. The rating label is found on the driver-side vehicle door cornerpost.

⚠ CAUTION

See your FISHER® outlet for application recommendations. Shoe Kit weight information may be found in the Kit Selection Guide.

INSTALLATION INSTRUCTIONS

NOTE: If a cutting edge is currently installed, the last two carriage bolts on both ends of the base must be removed.

⚠ CAUTION

If a cutting edge is not installed, 3" carriage bolts are too long; 2-1/2" carriage bolts must be used.

1. Insert carriage bolts through the base angle from the front.

8' Blade

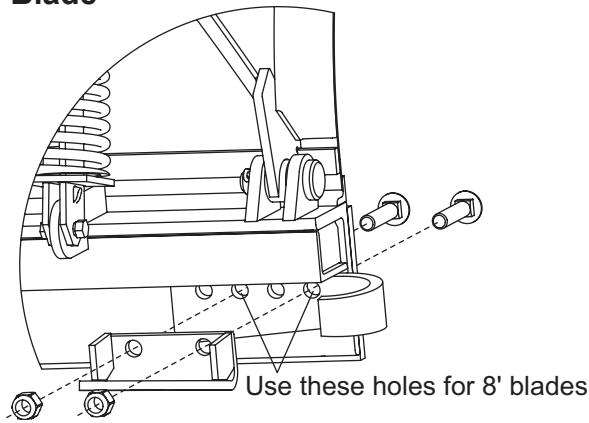

9' Blade

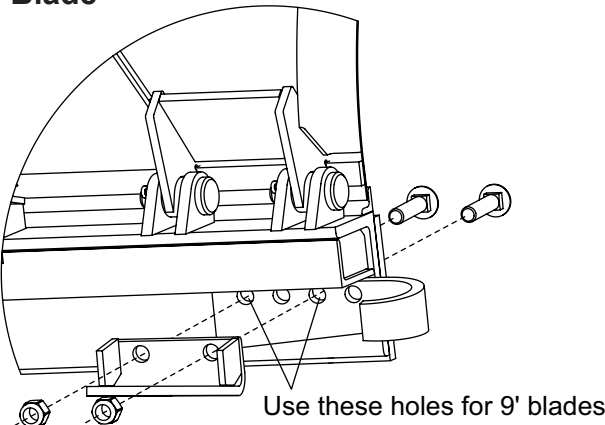

2. If installing curb shoes, place one onto the carriage bolts on the back side of the base angle (as shown in the illustration).
3. If installing wear shoes, place a wear shoe bracket onto the carriage bolts on the back side of the base angle (as shown in the illustration).
4. Put a locknut on each carriage bolt and tighten according to the torque chart.
5. If installing wear shoes, assemble two spacers on a shoe. Insert the shoe into the installed shoe bracket. Secure the shoe by inserting a shoe pin into the holes at the top of the shoe pipe, then snapping the ring on the pin over the pipe. Shoe height can be adjusted by removing spacer rings as required.
6. Repeat on opposite end.

| Recommended Fastener Torque Chart (Ft.-Lb.) | | | |
|-------------------------------------------------------------------------------|-------------|-------------|-------------|
| Size | SAE Grade 2 | SAE Grade 5 | SAE Grade 8 |
| 1/4-20 | 6 | 9 | 13 |
| 5/16-18 | 11 | 18 | 28 |
| 3/8-16 | 19 | 31 | 46 |
| 3/8-24 | 24 | 46 | 68 |
| 7/16-14 | 30 | 50 | 75 |
| 1/2-13 | 45 | 75 | 115 |
| 9/16-12 | 66 | 110 | 165 |
| 5/8-11 | 93 | 150 | 225 |
| 3/4-10 | 150 | 250 | 370 |
| 7/8-9 | 150 | 378 | 591 |
| 1-8 | 220 | 583 | 893 |
| Metric Grade 8.8 (Ft.-Lb.) | | | |
| Size | Torque | Size | Torque |
| M 6 | 7 | M 12 | 60 |
| M 8 | 17 | M 14 | 95 |
| M 10 | 35 | M 16 | 155 |
| These torque values apply to fasteners except those noted in the instruction. | | | |

Copyright© 2003 Douglas Dynamics, L.L.C. All rights reserved. This material may not be reproduced or copied, in whole or in part, in any printed, mechanical, electronic, film or other distribution and storage media, without the written consent of Fisher Engineering. Authorization to photocopy items for internal or personal use by Fisher Engineering outlets or snowplow owner is granted.

Fisher Engineering reserves the right under its product improvement policy to change construction or design details and furnish equipment when so altered without reference to illustrations or specifications used. Fisher Engineering and the vehicle manufacturer may require and/or recommend optional equipment for snow removal. Do not exceed vehicle ratings with a snowplow. Fisher Engineering offers a limited warranty for all snowplows and accessories. See separately printed page for this important information. The following are registered (®) and unregistered (™) trademarks of Douglas Dynamics, L.L.C.: FISHER®, XBLADE™.