

HYDRAULIC COMPONENTS

Item	Part	Description	Item	Part	Description	Item	Part	Description
1	48601	Hydraulic Unit Assembly	18	27746	Hydraulic Pump Kit - IA	35	56769	1 x 7 Cylinder
2	27753	Motor Assembly 3"	19	56274	O-Ring - 013	36	66699K	Gland Nut
3	73897	Magnet	20	90073	5/16-18 x 2-1/4 Hex Cap Screw G5	37	56771F	1" Split Bearing Kit
4	64566	Bearing, Sleeve	21	66763-1	Inlet Fitting/Filter Kit	38	27786	1 x 7 Ram Rod Kit
5	66515	Pump Shaft Seal	22	26781-3	Suction Filter	39	27787	1" Bore Ram Seal Kit
6	66519	O-Ring 2 - 250	23	48538	Reservoir Kit	40	56803	Spacer
7	7637K-1	Cartridge Valve 4-Way with Nut	24	66607	#10-24 x 5/16 Machine Screw	41	48600	1-1/2 x 6 Double-Acting Ram Assembly
8	66608K-1	Cartridge Valve 3-Way with Nut	25	48464	Plate Baffle	42	92960	3/8-24 O-Ring Boss Plug
9	7634K-2	Valve 2-Way w/Nut	26	56908	Plug	43	48606	1-1/2 Piston with Seals
10	7639K-2	Coil with Spade Terminals	27	56416	O-Ring - 014	44	27790	1-1/2 x 6 Double-Acting Rod Assembly
11	7629K-3	Relief Valve Kit - Set	28	21727-2	Breather 3/8 NPT Kit	45	27788-1	1-1/2 Bore Double-Acting Ram Seal Kit
12	7630K	Poppet Check Valve Kit	29	44311	1/4 x 12 Hose w/FJIC Ends	46	48518	Check Valve Assembly
13	48517	Quill	30	56598	1/4 x 22 Hose w/FJIC Ends	47	27792-1	Relief Valve Repair Kit
14	44333-1	Check Valve CV08-20	31	56599	1/4 x 36 Hose w/FJIC Ends	ns	7632K-3	Back-Up / O-Ring Kit
15	21394	Cover Assembly	32	56725	Elbow 90° - 6	ns	49258-2	Seal Kit Cartridge 2-Way Valve
16	90650	Cover Screw	33	44361	Elbow, Long 90° - 6	ns	49259-2	Seal Kit Cartridge 3-Way & 4-Way Valve
17	92079	Plug 3/8 NPTF	34	56772K	1 x 7 Ram Assembly			

G = Grade ns = not shown HP = High Pressure

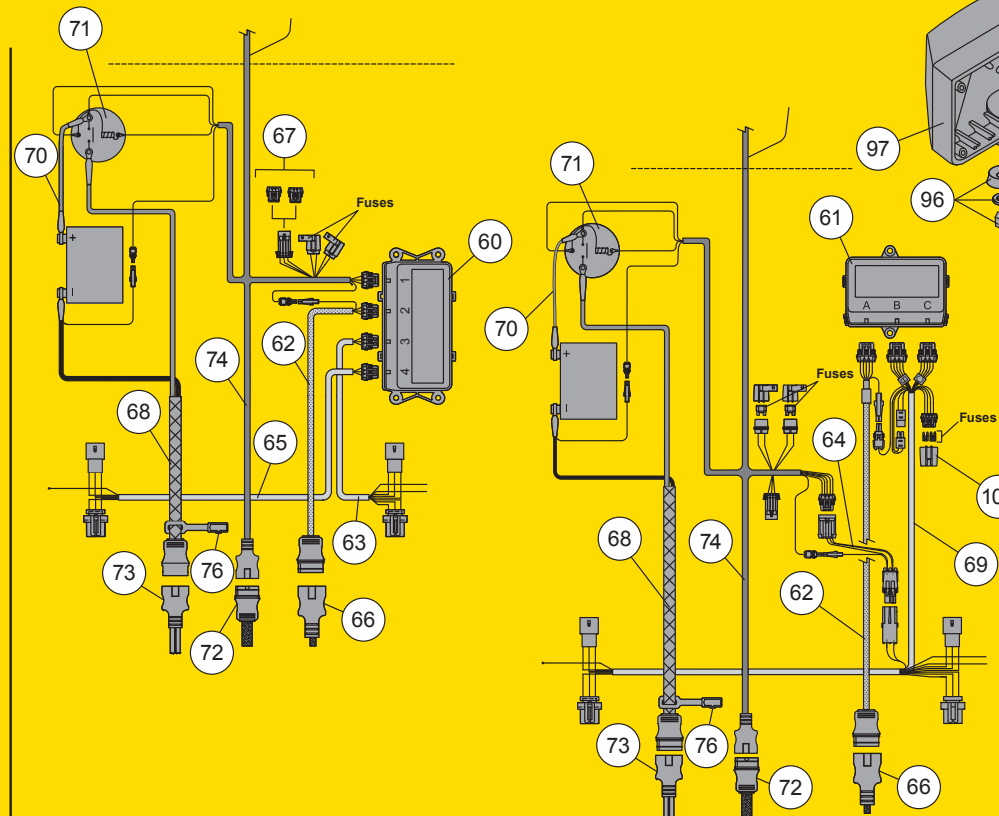

ELECTRICAL COMPONENTS

Item	Part	Description	Item	Part	Description	Item	Part	Description
60	26400	Isolation Module (White Label)	72	26359	3-Pin Plow Control Harness	89	8334	Joystick PCB w/Lever (Style 3)
61	29070-1	Isolation Module (Light Green Label)	73	21294	Plow Battery Cable	90	7646	Joystick Control Base
62	26357	11-Pin Vehicle Lighting Harness	74	26345	3-Pin Vehicle Control Harness	91	93153	6-19 x 3/8 Tapping Screw
63	29047	Adapter	75	27063K	3-Pin Vehicle-Side Repair End	92	93154	8-18 x 5/8 Tapping Screw
64	29047	Adapter	76	8291K	Plug Cover	93	7714	Control Bracket w/Fasteners
65	26347	Long Plug-In Harness	77	9400	Straight Blade Fish-Stik® Control	94	20254K	Dual Lock Mounting Kit
66	26347	Long Plug-In Harness	78	96456	Right Control Body	95	8328	Headlamp Replacement - DS or PS
67	26420	Dust Cover Plug	79	96457	Left Control Body	96	6128	Headlamp Swivel and Fasteners
68	26421	Configuration Plug	80	96440	Keypad, Split Lights	97	8796	Headlamp Housing
69	63411	Vehicle Battery Cable	81	56473	PCB Assembly	98	6728	2E1 Glass Sealed Beam Light
70	22511	22" Battery Cable	82	96437	Coiled Cord	99	6664	Sealed Beam Gasket Set
71	5794K-1	Motor Relay	83	93173	8-18 x 3/4 Tapping Screw	100	A6153	2E1 Retainer Fingers w/Screws (4 each)
			84	93174	8-18 x 1-1/4 Tapping Screw	101	6122	Bezel w/Fasteners - DS or PS
			85	56436	Control Bracket	102	6123	Lens w/Fasteners - DS or PS
			86	8292	Style 3 Solenoid Control	103	7436K	Socket and Wire Assembly
			87	7641	Joystick Control Shield	104	22400K	2 oz Dielectric Grease Tube
			88	8333	Body w/Label and Lens	105	29998	Fuse Cover - 5 Pack
						106	55923	Conical Spring

Supersedes Yellow Label.

PLOW GEAR, A-FRAME & BLADES

Item	Description	Item	Part	Description	
120	27547	6"-8" Homesteader™ Blade Assembly	143	27461	Compression Spring
121	27549	7"-4" Homesteader™ Blade Assembly	144	27149	Spring Bar Tube
122	27195	26" Flexible Blade Guide Set	145	27351	Elastomeric Trip Spring
123	59900	Label - Information (Warning)	146	27530	Trip Spring Spacer
124	27573	Moldboard Fastener Kit	147	27711F	Lower Trip Spring Pin Kit
125	27717	6"-8" Moldboard Kit w/Fasteners	148	27360	Jack Leg Assembly
126	27679	Label - Identity, Homesteader	149	27355	Jack Leg
127	27574	Cutting Edge Fastener Kit	150	27357	Jack Sleeve
128	27713	6"-8" Cutting Edge Kit w/Fasteners	151	27358	Jack Handle
129	27111	6"-8" Blade Structure, Personal Plow	152	27692	Square Vinyl Cap
130	91377	3/8-16 Hex Flange Locknut	153	27141F	Pivot Tube Kit
131	98043	3/8-16 x 1 Button Cap Screw	154	27615	Trip Bumper
132	28940	3/8-16 Hex Flange Locknut GF	155	4433	1/2 Flat Washer
133	92023	3/8-16 x 1-1/2 Carriage Bolt G5	156	20639K	3/4 x 3-15/32 Machine Pin Packet
134	27710	Poly Shoe Kit - Pair (Optional)	157	27529	3/8-16 x 3-1/2 Hex Cap Screw G5
135	27126	Plow Gear Frame, Personal Plow	158	63925	3/8 Flat Washer
136	27138	A-Frame, Personal Plow	159	90039	3/8-16 x 1 Hex Cap Screw G5
137	27112	Quadrant, Personal Plow	160	90313	5/16 Flat Washer
138	27577	Trip Clamp Replacement Kit w/Fasteners	161	90602	5/16-18 x 5 Hex Cap Screw G5
139	27146	Receiver - DS	162	91911	5/32 x 1-1/2 Cotter Pin
140	27611	Receiver - PS	163	91332	5/16-18 Hex Locknut GB
141	27575F	Receiver Mounting Pin Kit	164	91333	3/8-16 Hex Locknut GB
142	27576	Receiver Pull Pin Kit	165	91413	3/8-16 Hex Nut G5
			166	91962	1/8 Hairpin Cotter
			167	27654	Receiver Assembly - DS
			168	27755	Receiver Assembly - PS
			169	8284K	Cable Boot

G = Grade ns = not shown

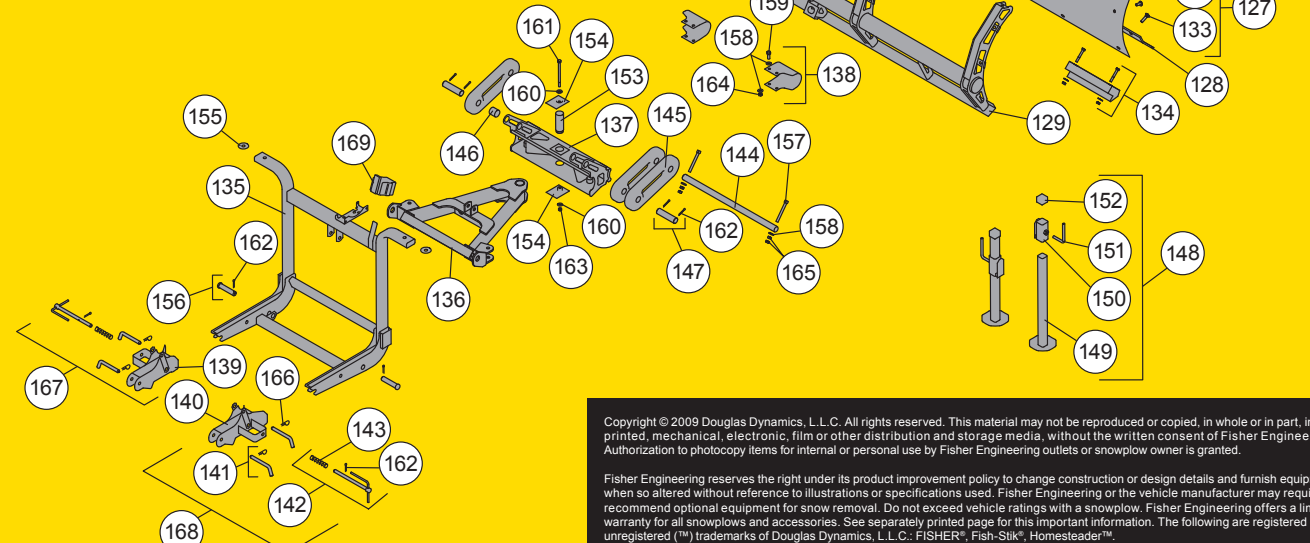
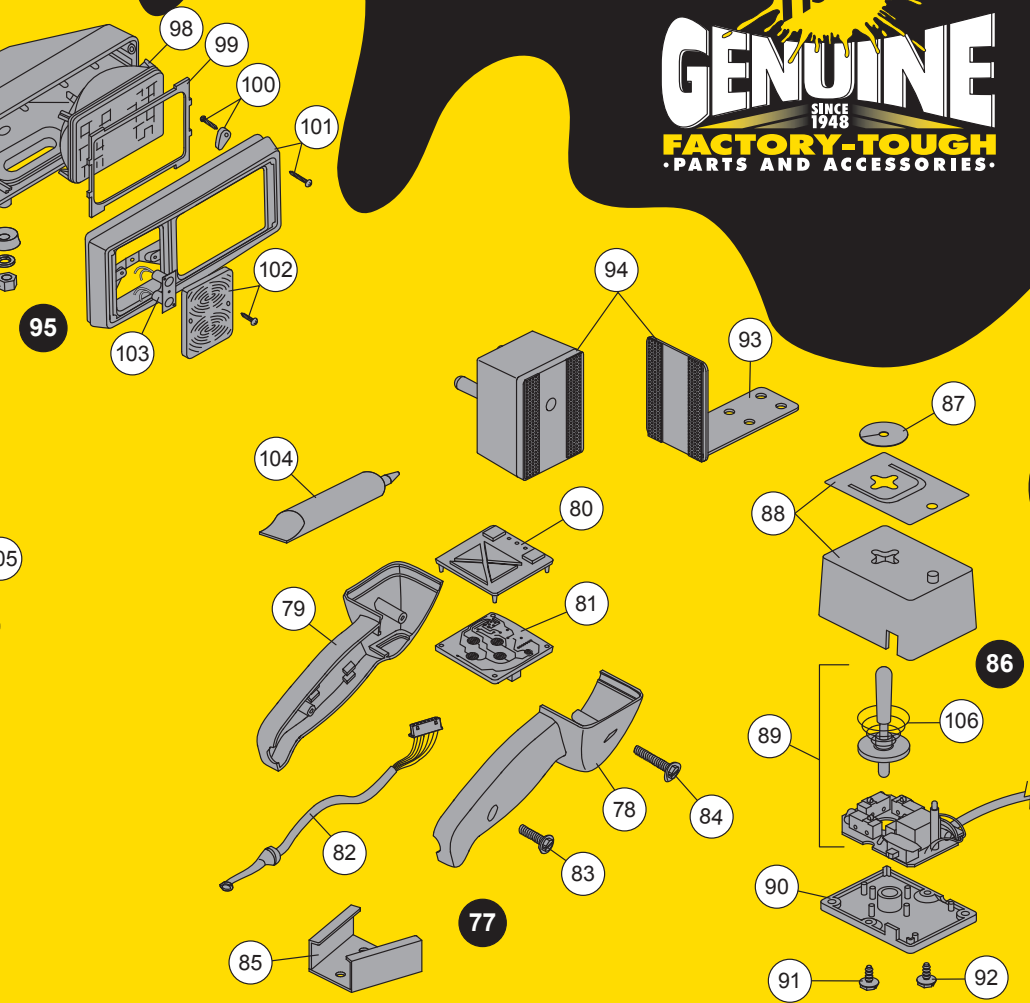

Copyright © 2009 Douglas Dynamics, L.L.C. All rights reserved. This material may not be reproduced or copied, in whole or in part, in any printed, mechanical, electronic, film or other distribution and storage media, without the written consent of Fisher Engineering. Authorization to photocopy items for internal or personal use by Fisher Engineering outlets or snowplow owner is granted.

Fisher Engineering reserves the right under its product improvement policy to change construction or design details and furnish equipment when so altered without reference to illustrations or specifications used. Fisher Engineering or the vehicle manufacturer may require or recommend optional equipment for snow removal. Do not exceed vehicle ratings with a snowplow. Fisher Engineering offers a limited warranty for all snowplows and accessories. See separately printed page for this important information. The following are registered (®) or unregistered (™) trademarks of Douglas Dynamics, L.L.C.: FISHER®, Fish-Stik®, Homesteader™.