

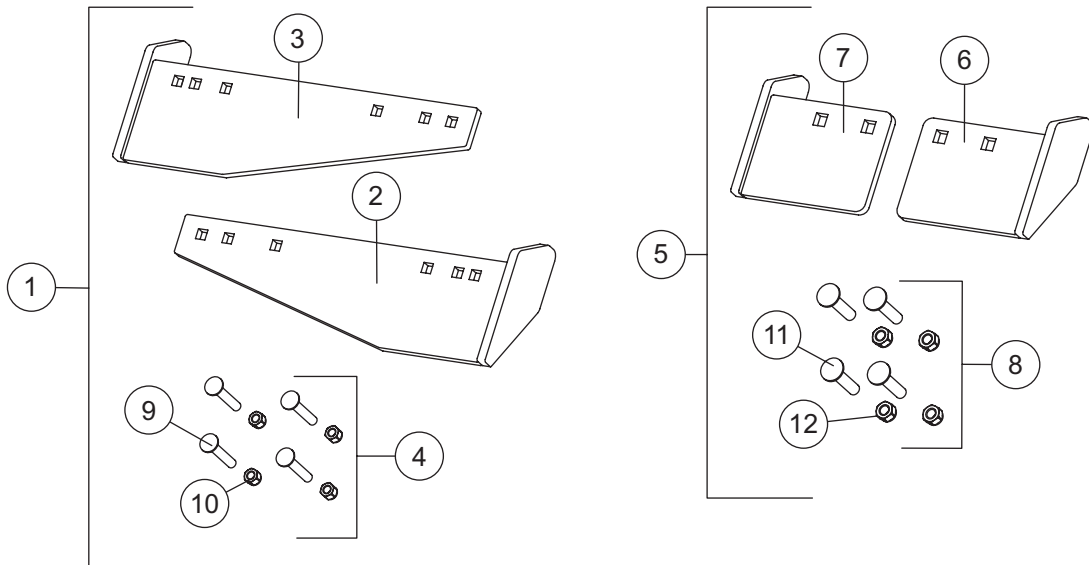

Wear/Curb Guard Kit

HD2™ and HDX™ Snowplows

PARTS LIST



Wear/Curb Guard Kit – HD2 and HDX							
Item	Part	Qty	Description	Item	Part	Qty	Description
1	51879		Wear/Curb Guard Kit, 7-1/2', 8' or 8-1/2' Blade	5	51880		Wear/Curb Guard Kit, 9' Blade
2	52123	1	Curb Guard 7-1/2', 8', 8-1/2' Bld – DS	6	52121	1	Curb Guard 9' Blade – DS
3	52124	1	Curb Guard 7-1/2', 8', 8-1/2' Bld – PS	7	52122	1	Curb Guard 9' Blade – PS
4	52127	1	Bolt Bag, 7-1/2', 8' or 8-1/2' Blade	8	52126	1	Bolt Bag, 9' Blade
Item 4		52127 Bolt Bag – 7-1/2', 8' and 8-1/2' Blades					
	9	4	1/2-13 x 3 Carriage Bolt G8		10	4	1/2-13 Hex Locknut GB
Item 8		52126 Bolt Bag – 9' Blade					
	11	4	5/8-11 x 3 Carriage Bolt G5		12	4	5/8-11 Hex Locknut GB
G = Grade							

INSTALLATION INSTRUCTIONS

⚠ WARNING

Do not exceed GVWR or GAWR, including blade and ballast. The rating label is found on the driver-side vehicle door cornerpost.

⚠ WARNING

Blade can drop unexpectedly. Place blade on jack stands. Failure to do so could result in serious personal injury.

⚠ CAUTION

Read this document before installing the wear/curb guards.

⚠ CAUTION

Use standard methods and practices when attaching snowplow and installing accessories, including proper personal protective safety equipment.

⚠ CAUTION

See your FISHER® outlet/Web site for specific vehicle application recommendations before installation. Wear/curb guard weight information may be found in the eMatch selection system.

1. Park the vehicle on a smooth, level, hard surface, such as concrete. Raise the blade, then turn the control OFF. From the side of the blade assembly, place jack stands under the blade.
2. Turn the control ON and lower the blade so the blade rests securely on the jack stands. Turn the control OFF. Turn the vehicle ignition to the "OFF" position and remove the key.
3. Remove the two outermost carriage bolts from one end of the blade.
4. Align the holes in the curb guard with the holes in the blade.

The curb guards in the 51879 kit have 3 sets of holes to align with the existing holes in 7-1/2', 8', or 8-1/2' blades, as shown.

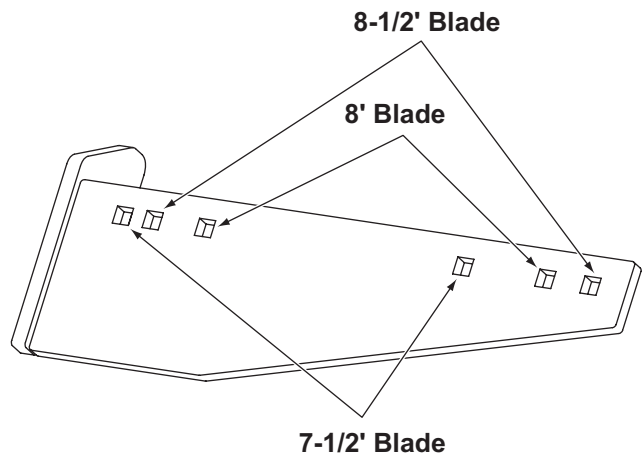

5. Install the curb guard to the blade using two carriage bolts and locknuts. Hand tighten.

8-1/2' Blade shown

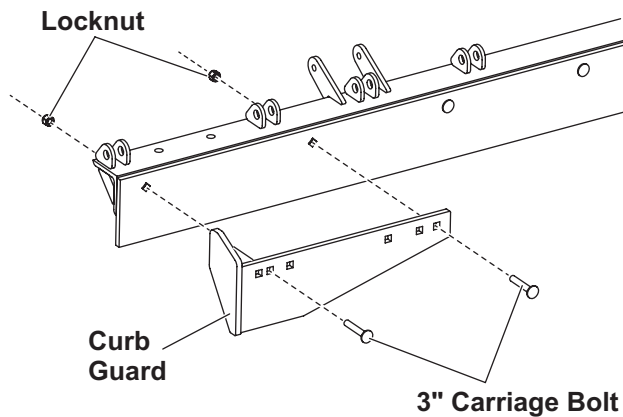

6. Repeat Steps 3–5 on the other end of the blade.
7. Fully tighten the fasteners.
 - 7-1/2', 8' or 8-1/2' blade: 75 ft-lb
 - 9' blade: 150 ft-lb

8. Turn the vehicle ignition and snowplow control ON. Raise the blade slightly. Turn the control OFF and remove the jack stands.
9. Stand 8 feet clear of the blade, and lower the blade to the ground.
10. Level the A-frame according to the snowplow Installation Instructions or Owner's Manual.

Copyright © 2015 Douglas Dynamics, LLC. All rights reserved. This material may not be reproduced or copied, in whole or in part, in any printed, mechanical, electronic, film or other distribution and storage media, without the written consent of Fisher Engineering. Authorization to photocopy items for internal or personal use by Fisher Engineering outlets or snowplow owner is granted.

Fisher Engineering reserves the right under its product improvement policy to change construction or design details and furnish equipment when so altered without reference to illustrations or specifications used. Fisher Engineering or the vehicle manufacturer may require or recommend optional equipment for snow removal. Do not exceed vehicle ratings with a snowplow. Fisher Engineering offers a limited warranty for all snowplows and accessories. See separately printed page for this important information. The following are registered (®) or unregistered (™) trademarks of Douglas Dynamics, LLC: FISHER®, HD2™, HDX™.

Printed in U.S.A.
