



**Fisher Engineering**

50 Gordon Drive, Rockland, Maine 04841-2139 • www.fisherplows.com

**52168, 52169, 52170**

April 1, 2015

Lit. No. 41858, Rev. 00

# Polyurethane Cutting Edge Kit

## HD2™ and HDX™ Snowplows

### PARTS LIST

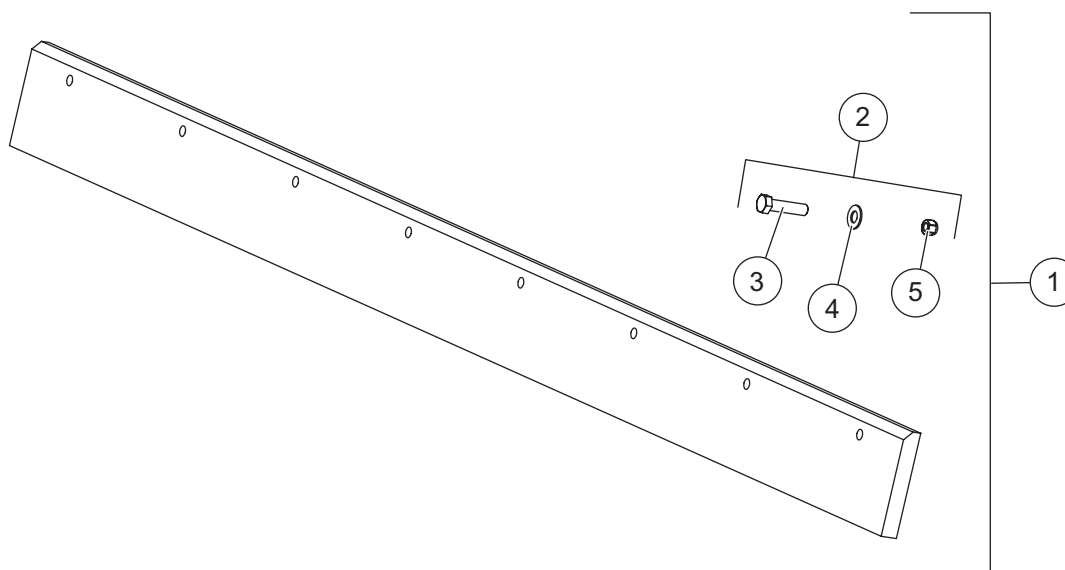

Polyurethane Cutting Edge Kit – HD2 and HDX					
Item	Description	Part Number			
		7-1/2' Blade	8' Blade	8-1/2' Blade	9' Blade
1	Polyurethane Cutting Edge Kit	52168		52169	52170
2	Bolt Bag – Polyurethane Cutting Edge	52139			52140

52139 Bolt Bag – 7-1/2', 8', 8-1/2' Blades					
Item	Qty	Description	Item	Qty	Description
3	8	1/2-13 x 2-1/4 Hex Cap Screw G8	5	8	1/2-13 Hex Locknut GB
4	8	1/2 Flat Washer Wide			
52140 Bolt Bag – 9' Blade					
3	11	5/8-11 x 2-1/2 Hex Cap Screw G5	5	11	5/8-11 Hex Locknut GB
4	11	5/8 Flat Washer Narrow			
G = Grade					

## INSTALLATION INSTRUCTIONS

### ⚠ WARNING

Do not exceed GVWR or GAWR, including blade and ballast. The rating label is found on the driver-side vehicle door cornerpost.

### ⚠ WARNING

Blade can drop unexpectedly. Place A-frame on jack stands. Failure to do so could result in serious personal injury.

### ⚠ CAUTION

Read this document before installing the polyurethane cutting edge.

### ⚠ CAUTION

Use standard methods and practices when attaching snowplow and installing accessories, including proper personal protective safety equipment.

### ⚠ CAUTION

See your FISHER® outlet/Web site for specific vehicle application recommendations before installation. Polyurethane cutting edge weight information may be found in the eMatch selection system.

1. Park the vehicle on a smooth, level, hard surface, such as concrete. Raise the blade, then turn the control OFF. From the side of the blade assembly, place jack stands under the A-frame.
2. Turn the control ON and lower the blade so the A-frame rests securely on the jack stands. Turn the control OFF. Turn the vehicle ignition to the "OFF" position and remove the key.

3. Remove the existing cutting edge and fasteners from the blade.
4. If the polyurethane cutting edge is being installed on a 7-1/2" blade, remove 3" from each end of the cutting edge, as shown.

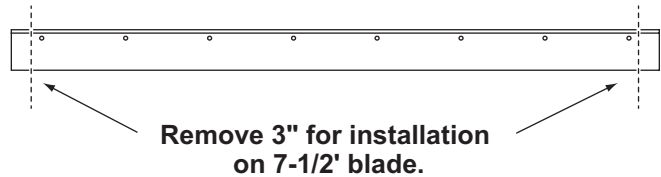

5. Insert the supplied cap screws through the washers, polyurethane cutting edge, and base angle. Install a locknut onto each cap screw and torque to 50 ft-lb.

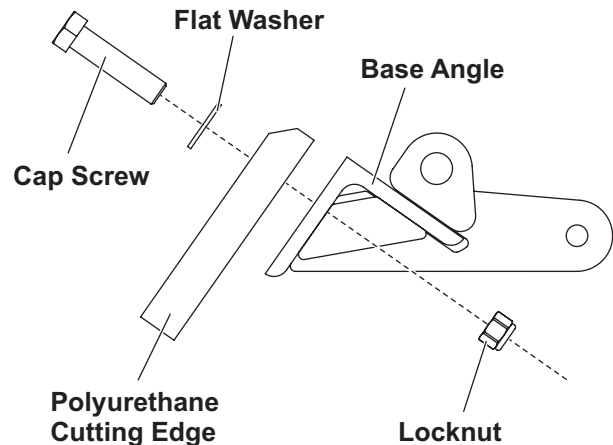

6. Turn the vehicle ignition and snowplow control ON. Raise the blade slightly. Turn the control OFF and remove the jack stands.
7. Stand 8 feet clear of the blade, and lower the blade to the ground.
8. Level the A-frame according to the snowplow Installation Instructions or Owner's Manual.

Copyright © 2015 Douglas Dynamics, LLC. All rights reserved. This material may not be reproduced or copied, in whole or in part, in any printed, mechanical, electronic, film or other distribution and storage media, without the written consent of Fisher Engineering. Authorization to photocopy items for internal or personal use by Fisher Engineering outlets or snowplow owner is granted.

Fisher Engineering reserves the right under its product improvement policy to change construction or design details and furnish equipment when so altered without reference to illustrations or specifications used. Fisher Engineering or the vehicle manufacturer may require or recommend optional equipment for snow removal. Do not exceed vehicle ratings with a snowplow. Fisher Engineering offers a limited warranty for all snowplows and accessories. See separately printed page for this important information. The following are registered (®) or unregistered (™) trademarks of Douglas Dynamics, LLC: FISHER®, HD2™, HDX™.

Printed in U.S.A.