

SERIES  
G & H

FORD F250  
FORD F350

1980-1986  
1980-1985

AL256

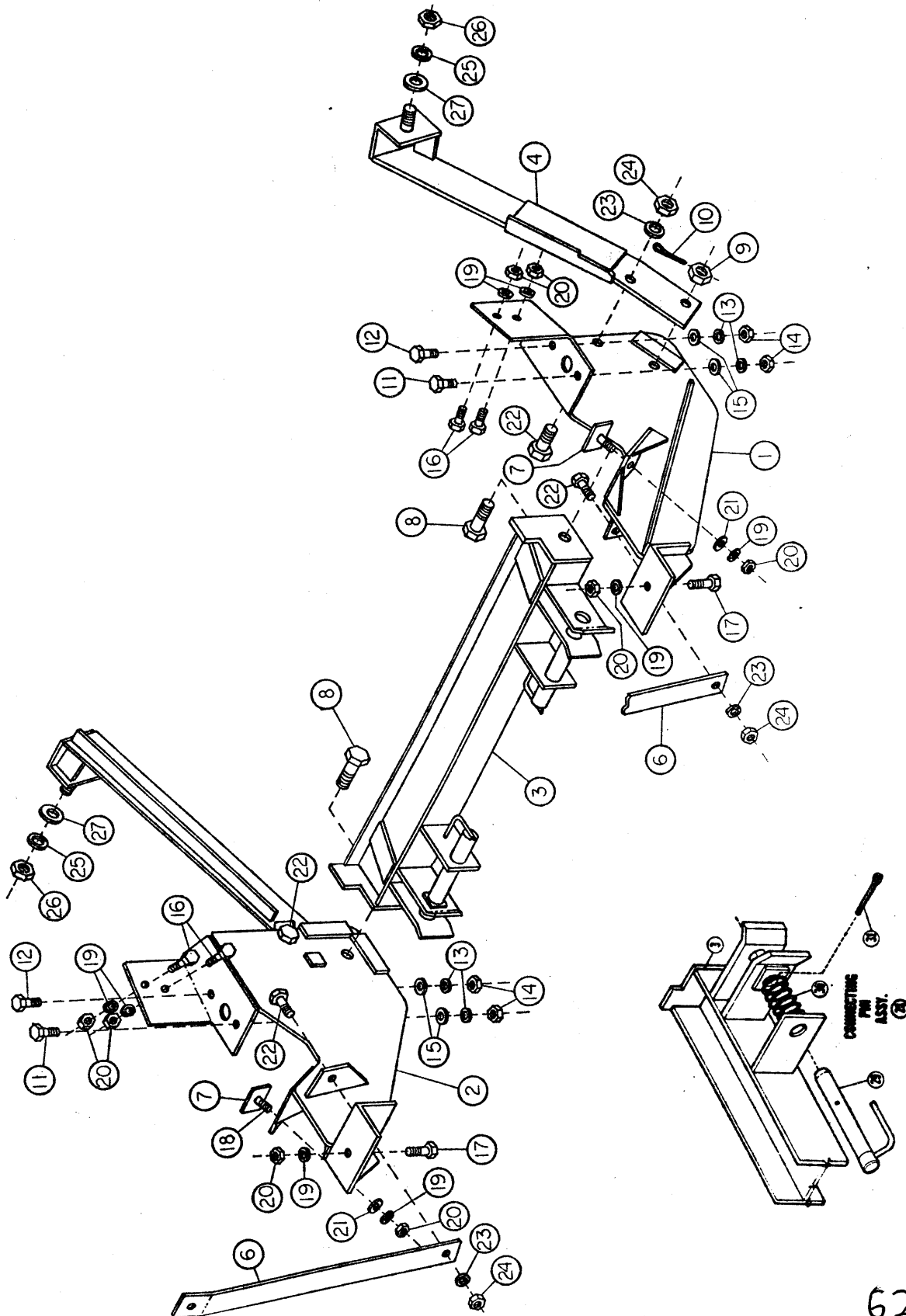



6240

**PARTS LIST**

**AL256**

REF#	PART#	QTY.	DESCRIPTION	* PART OF P/N 6773 BOLT BAG
1	5603	1	PUSHPLATE, DRIVER SIDE	
2	5604	1	PUSHPLATE, PASSENGER SIDE	
3	5605	1	PUSHBEAM	
4	6044	1	PUSHBAR, (DRIVERS SIDE)	
5	6045	1	PUSHBAR, (PASSENGER SIDE)	
6	3954	2	HEADGEAR BRACE	
7	5210	2	* BUMPER DOUBLER	
8	5350	2	* 5/8-11 X 2 (NC) DRILLED CAPSCREW	
9	90446	2	* 5/8-11 (NC) SLOTTED NUT	
10	90012	2	* 3/16 X 1-3/4 COTTER PIN	
11	90106	2	* 3/8 X 1-1/4 (NC) GR.5 CAPSCREW	
12	90111	2	* 3/8 X 1-1/2 (NC) GR.5 CAPSCREW	
13	90361	4	* 3/8 LOCKWASHER	
14	90334	4	* 3/8 (NC) NUT	
15	90315	4	* 3/8 FLATWASHER	
16	90575	4	* 1/2 X 1-1/4 (NC) GR.5 CAPSCREW	
17	90210	2	* 1/2 X 1-1/2 (NC) GR.5 CAPSCREW	
18	90214	2	* 1/2 X 1-3/4 (NC) GR.5 CAPSCREW	
19	90364	8	* 1/2 LOCKWASHER	
20	90337	8	* 1/2 (NC) NUT	
21	90319	2	* 1/2 FLATWASHER	
22	90244	6	* 5/8 X 1-1/2 (NC) GR.5 CAPSCREW	
23	90366	6	* 5/8 LOCKWASHER	
24	90343	6	* 5/8 (NC) NUTS	
25	90367	2	* 3/4 LOCKWASHER	
26	90345	2	* 3/4 (NC) NUTS	
27	90325	2	* 3/4 FLATWASHER	
	3	1	CONNECTING PIN RELEASE	
	4289	2	* 3/4 X 1-7/8 MACHINE PIN	
	90658	2	* 5/32 X 1-1/4 COTTER PIN	
	A5872	1	DASH BRACKET BAG	
28	6920	2	CONNECTING PIN ASSEMBLY	
29	6815	2	CONNECTING PIN W/HANDLE	
30	821	2	* SPRING	
31	90601	2	* 1/4 X 1-1/2 COTTER PIN	

FASTENER TORQUE (FT-LB)			
DIAMETER- THREADS PER INCH	GRADE DESIGNATION		
	 GRADE 2	 GRADE 5	 GRADE 8
1/4 - 20	6	9	13
5/16 - 18	11	18	28
3/8 - 16	19	31	46
7/16 - 14	30	50	75
1/2 - 13	45	75	115
9/16 - 12	66	110	165
5/8 - 11	93	150	225
3/4 - 10	150	250	370
7/8 - 9	150	378	591
1 - 8	220	583	893

**IMPORTANT NOTICE**

1. 1980-83 FORD F250 AND F350 TRUCKS MUST BE EQUIPPED WITH SNOW PLOW PREP PACKAGE TO USE AL256.
2. AL256 IS NOT TO BE USED ON FORD MONOBEAM FRONT AXLE F350 TRUCKS. ATTACHMENTS INTERFERE WITH STEERING LINKAGE.

---

A. REMOVE LOWER BUMPER BOLTS AND LOOSEN UPPER BUMPER BOLTS. (BUMPER MUST BE REALIGNED AFTER INSTALLING PUSHPLATES). IF VEHICLE IS EQUIPPED WITH EVAPORATOR CAN MOUNTED ON INNER PASSENGER SIDE FRAME RAIL, REMOVE AND SAVE FASTENERS. (RE-INSTALL AFTER PUSHPLATES ARE INSTALLED).

B. ALIGN FRONT TAB OF DRIVERS SIDE PUSHPLATE (1) WITH BOTTOM BUMPER HOLE AND REAR ANGLE OF PUSHPLATE WITH HOLES IN FRAME. INSTALL ONE 3/8 X 1-1/4 CAPSCREW (11) DOWN THROUGH THE BOTTOM FLANGE OF THE VEHICLE FRAME AND THE FORWARD HOLE IN THE REAR ANGLE OF EACH PUSHPLATE. SECURE WITH A 3/8 FLATWASHER (15), LOCKWASHER (13) AND NUT (14). INSTALL ONE 3/8 X 1-1/2 CAPSCREW (12) DOWN THROUGH THE FRAME AND THE REAR HOLE IN THE ANGLE OF THE PUSHPLATE (REAR OF CAPSCREW JUST INSTALLED). SECURE WITH 3/8 FLATWASHER (15), LOCKWASHER (13), AND NUT (14). DO NOT FULLY TIGHTEN, REPEAT FOR PASSENGER SIDE PUSHPLATE (2).

C. PLACE A 1/2 X 1-3/4 CAPSCREW (18) THROUGH A BUMPER DOUBLER (7) AND WITH LENGTH OF DOUBLER RUNNING VERTICALLY INSERT CAPSCREW OUT THROUGH SLOTTED HOLE IN FRONT OF FRAME FLANGE, OUT THROUGH BUMPER (MAY HAVE TO ALIGN BY LIFTING), AND THROUGH PUSHPLATE HANGER HOLE. SECURE IN POSITION WITH A 1/2 FLATWASHER (21), LOCKWASHER (19) AND NUT (20). REPEAT FOR OPPOSITE SIDE.

D. ON THE DRIVERS SIDE FRAME LOCATE A 3/4" SLOTTED HOLE JUST TO THE REAR OF THE SHOCK ABSORBER MOUNTING BRACKET. INSERT THE WELDED IN BOLT ON THE DRIVERS SIDE PUSHBAR (4) INTO THIS HOLE AND OUT THROUGH FRAME. SECURE WITH A 3/4 FLATWASHER (27) LOCKWASHER (25) AND A NUT (26). DO NOT TIGHTEN. ATTACH OTHER END OF PUSH BAR TO THE OUTSIDE OF PUSHPLATE WITH A 5/8 X 1-1/2 CAPSCREW (22) THROUGH THE REAR OF HIGHEST HOLE IN THE SIDE OF THE PUSHPLATE. SECURE WITH A 5/8 LOCKWASHER (23) AND A NUT (24). REPEAT FOR THE ATTACHMENT OF PASSENGER SIDE PUSHBAR (5) TO PUSHPLATE.

E. ASSEMBLE CONNECTING PINS (28) TO PUSHBEAM (3). FIRST INSERT SPRINGS (30) BETWEEN TWO INNER EARS ON EACH SIDE OF PUSHBEAM. THEN INSERT CONNECTING PIN (29) THROUGH ALL THREE EARS WITH HANDLE OF PIN TOWARDS THE CENTER OF THE BEAM. LEAVING THE HOLE IN THE PIN BETWEEN THE INNER TWO EARS, PULL BACK ON SPRING AND INSTALL COTTER PIN (31).

F. INSTALL PUSHBEAM BETWEEN PUSHPLATES AND FASTEN WITH A 5/8 X 2 DRILLED CAPSCREW (8), SLOTTED NUT (9) AND A 3/16 COTTER PIN (10) ON EACH END.

- G.** PLACE THE HEADGEAR (NOT SHOWN) ON THE FRONT PUSHPLATE PADS AND SECURE USING TWO 1/2 X 1-1/2 CAPSCREWS (17), LOCKWASHERS (19) AND NUTS (20) WITH BOLTS FACING UPWARDS.
- H.** INSTALL HEADGEAR BRACES (6) TO EACH SIDE OF HEADGEAR (BENT END ON TOP) AND TO PUSHPLATE TABS USING 5/8 X 1-1/2 CAPSCREWS (22) LOCKWASHERS (23) AND NUTS (24). TIGHTEN ALL FASTENERS THUS FAR INSTALLED INSURING THAT ALL VEHICLE BRAKE, WIRING AND GAS LINES ARE SECURED WELL AWAY FROM ADDED PLOW COMPONENTS. ALSO INSURE BUMPER IS ALIGNED AND BUMPER BOLTS TIGHTENED.
- I.** ON EACH SIDE USING THE OUTSIDE FLANGE OF THE PUSHPLATE AS DRILLING GUIDE DRILL TWO 17/32" DIA. HOLES THROUGH THE VEHICLE FRAME. SECURE PUSHPLATE FLANGE TO FRAME USING TWO 1/2 X 1-1/4 CAPSCREWS (16), LOCKWASHERS (19) AND NUTS (20) ON EACH SIDE. TIGHTEN.
- J.** RECHECK AND ASSURE ALL FASTENERS ARE TIGHT.