

SERIES  
G & H

CHEV C30, R30 2WD  
GMC C35, R35 2WD

1983-19  
1983-19

AL262  
REV C

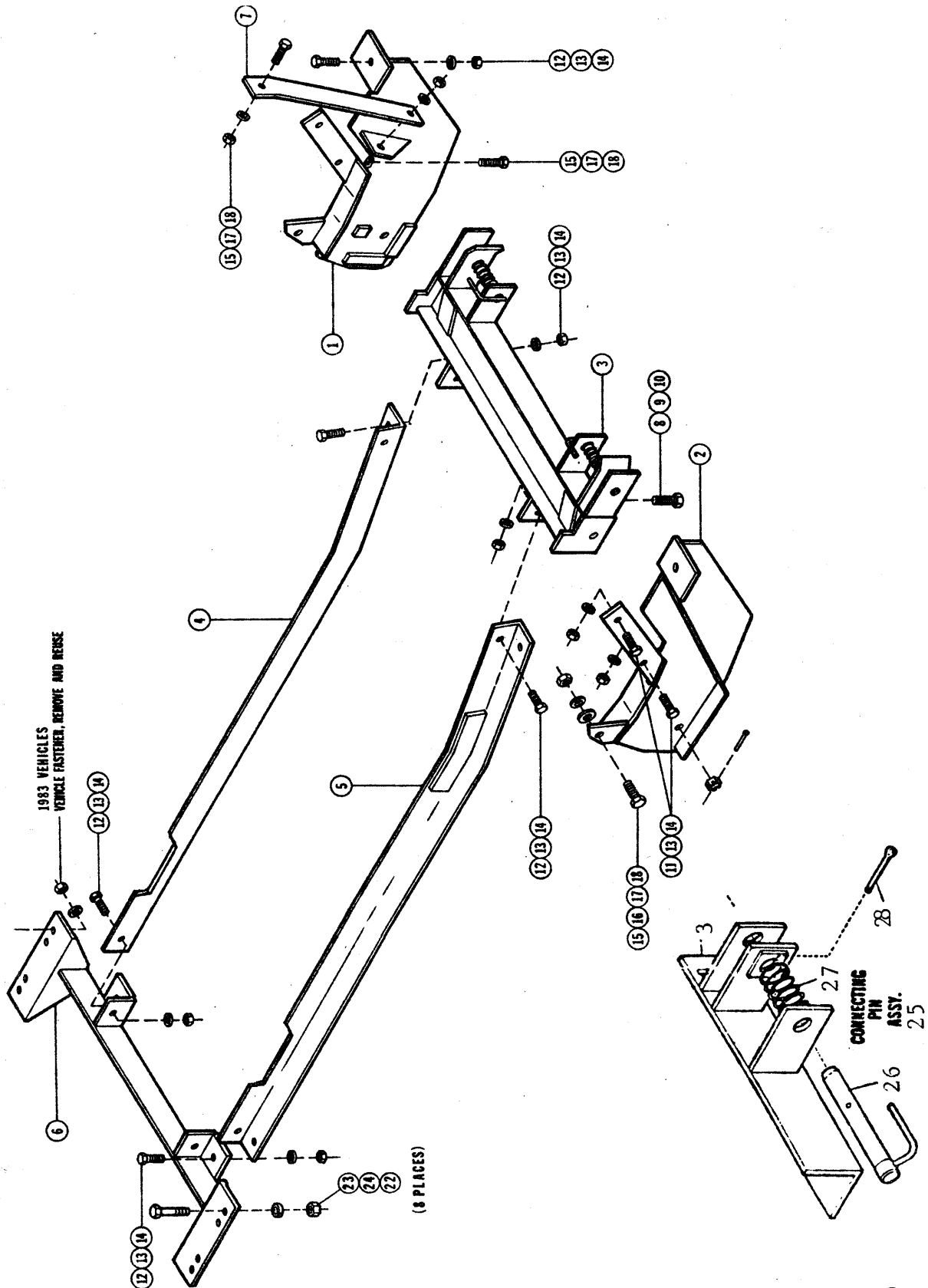



6245

## PARTS LIST

AL262 REV C

REF#	PART#	QTY	DESCRIPTION	* PART OF 6779 BOLT BAG
1	5706	1	PUSHPLATE, DRIVER SIDE	
2	5707	1	PUSHPLATE, PASSENGER SIDE	
3	5697	1	PUSHBEAM	
4	5698	1	PUSHARM, DRIVER SIDE	
5	5699	1	PUSHARM, PASSENGER SIDE	
6	5702	1	REAR PUSHBEAM	
7	3954	2	HEADGEAR BRACES	
8	5005	2	* 5/8 X 1-1/2 (NC) DRILLED CAPSCREW	
9	90446	2	* 5/8 X 11 (NC) SLOTTED NUTS	
10	90012	2	* 3/16 X 1-3/4 COTTER PINS	
11	90214	4	* 1/2 X 1-3/4 (NC) GR.5 CAPSCREW	
12	90210	10	* 1/2 X 1-1/2 (NC) GR.5 CAPSCREW	
13	90364	14	* 1/2" LOCKWASHER	
14	90337	14	* 1/2" (NC) NUTS	
15	90244	6	* 5/8 x 1-1/2 (NC) GR.5 CAPSCREWS	
16	90323	2	* 5/8" FLATWASHERS	
17	90366	6	* 5/8" LOCKWASHERS	
18	90343	6	* 5/8" (NC) NUTS	
19	4289	2	* 3/4 X 1-7/8 MACHINE PIN	
20	90658	2	* 5/32 X 1-1/4 COTTER PIN	
21	3	1	CONNECTING PIN RELEASE	
22	90177	8	* 7/16 X 1-1/2 (NC) GR.5 CAPSCREW	
23	90335	8	* 7/16 (NC) NUT	
24	90362	8	* 7/16 LOCKWASHER	
25	6920	2	CONNECTING PIN ASSEMBLY	
26	6815	2	CONNECTING PIN W/HANDLE	
27	821	2	* SPRING	
28	90601	2	* 1/4 X 1-1/2 COTTER PIN	
	A5871	1	DASH BRACKET BAG	

FASTENER TORQUE (FT-LB)			
DIAMETER- THREADS PER INCH	GRADE DESIGNATION		
	 GRADE 2	 GRADE 5	 GRADE 8
1/4 - 20	6	9	13
5/16 - 18	11	18	28
3/8 - 16	19	31	46
7/16 - 14	30	50	75
1/2 - 13	45	75	115
9/16 - 12	66	110	165
5/8 - 11	93	150	225
3/4 - 10	150	250	370
7/8 - 9	150	378	591
1 - 8	220	583	893

**A.** REMOVE AND DISCARD THE TWO 1/2" BOLTS, WASHERS AND NUTS HOLDING THE FRONT BUMPER BRACKETS TO EACH SIDE OF THE FRAME. PLACE ONE 5/8 X 1-1/2 CAPSCREW (15) IN THROUGH THE REAR TAB OF EACH PUSHPLATE (1,2) BEFORE PLATE IS INSTALLED. ALIGN THE TWO HOLES IN THE FORWARD TAB OF PUSHPLATE WITH THE TWO BUMPER BRACKET HOLES IN THE FRAME. ROTATE REAR OF PLATE UP AND INSTALL 5/8 X 1-1/2 CAPSCREW (15) INTO HOLE NEXT TO BUMPER BRACE BOLT. FASTEN WITH 5/8 FLATWASHERS (16), LOCKWASHERS (17) AND NUTS (18). REALIGN FRONT HOLES AND INSTALL TWO 1/2 X 1-3/4 CAPSCREWS (11) ON EACH SIDE. FASTEN WITH FOUR 1/2 LOCKWASHERS (13) AND NUTS (14).

**NOTE:** DO NOT TIGHTEN ANY FASTENERS UNTIL ALL THE ATTACHMENT PIECES ARE INSTALLED.

**B.** ASSEMBLE CONNECTING PINS (25) TO PUSHBEAM (3). FIRST INSERT SPRINGS (27) BETWEEN TWO INNER EARS ON EACH SIDE OF PUSHBEAM. THEN INSERT CONNECTING PIN (26) THROUGH ALL THREE EARS WITH HANDLE OF PIN TOWARDS THE CENTER OF THE BEAM. LEAVING THE HOLE IN THE PIN BETWEEN THE INNER TWO EARS, PULL BACK ON SPRING AND INSTALL COTTER PIN (28).

**C.** INSTALL THE FRONT PUSHBEAM (3) BETWEEN THE DRIVER'S AND PASSENGER'S SIDE PUSHPLATES. PLACE ONE 5/8 X 1-1/2 (NC) DRILLED CAPSCREW (8) OUT THROUGH EACH SIDE OF THE PUSHBEAM AND PUSHPLATES. SECURE WITH 5/8 (NC) SLOTTED NUTS (9). COTTER PIN WILL BE INSTALLED IN A LATER STEP.

**D.** TO MOUNT THE REAR PUSHBEAM (6) LOCATE THE TRANSMISSION SUPPORT CROSSMEMBER AND PROCEED AS FOLLOWS:

**1983 VEHICLES:** REMOVE THE FRONT FOUR 7/16 NUTS AND WASHERS ON EACH SIDE THAT CONNECT THE CROSSMEMBER TO THE LOWER FLANGE OF THE FRAME (SAVE FASTENERS). INSTALL THE PUSHBEAM ON OVER THE EIGHT CROSSMEMBER BOLTS SO THAT THE PUSHBEAM TABS POINT FORWARD. SECURE PUSHBEAM WITH REMOVED 7/16 NUTS AND WASHERS.

**1984-1989 VEHICLES:** REMOVE AND DISCARD THE FRONT TWO 7/16 FASTENERS ON EACH SIDE THAT CONNECT THE TRANSMISSION SUPPORT CROSSMEMBER TO THE LOWER FLANGE OF THE FRAME. ALIGN THE REAR PUSHBEAM WITH THESE HOLES AND INSERT ONE 7/16 X 1-1/2 (NC) CAPSCREW (22) DOWN THROUGH THE FRAME AND EACH OF THE MATCHING HOLES. FASTEN WITH 7/16 LOCKWASHERS (24) AND NUTS (23). IF ANY HOLES IN THE REAR PUSHBEAM DO NOT ALIGN WITH HOLES IN THE FRAME, THE FRAME MUST BE DRILLED AND SHOULD BE DONE AS DESCRIBED DURING STEP "H".

**E.** INSTALL THE DRIVER'S AND PASSENGER'S SIDE PUSHARMS (4,5) BETWEEN THE EARS OF THE FRONT AND REAR PUSHBEAMS WITH THE BENT ENDS FORWARD. SECURE EACH PUSHARM WITH FOUR 1/2 X 1-1/2 (NC) CAPSCREWS (12), LOCKWASHERS (13) AND NUTS (14).

**F.** PLACE HEADGEAR (FROM COMMON ATTACHING BOX) ONTO PUSHPLATES AND INSTALL TWO 1/2 X 1-1/2 CAPSCREWS (12) DOWN THROUGH HEADGEAR AND PUSHPLATE. SECURE WITH 1/2" LOCKWASHERS (13) AND NUTS (14).

**G.** INSTALL HEADGEAR BRACES (7) TO MOUNTING TABS ON PUSHPLATES WITH BENT END UP. SECURE THE HEADGEAR BRACES WITH FOUR 5/8 X 1-1/2 CAPSCREWS (15), LOCKWASHERS (17) AND NUTS (18).

H. WITH ALL PARTS INSTALLED BEGIN TIGHTENING FASTENERS AT THE HEADGEAR AND PROCEED TO THE REAR PUSHBEAM.

**NOTE:** USE CAUTION IN DRILLING ALL HOLES. BE SURE VEHICLE WIRING, BRAKE LINES, ETC. WILL NOT BE DAMAGED BY DRILLING.

IF NECESSARY, USE THE REMAINING HOLES IN REAR PUSHBEAM AS GUIDES AND DRILL OR REAM FOUR 15/32" HOLES THROUGH THE VEHICLE FRAME. PLACE A 7/16 X 1-1/2 (NC) CAPSCREW (22) DOWN THROUGH EACH HOLE AND FASTEN WITH 7/16 LOCKWASHERS (24) AND 7/16 (NC) NUTS (23). AFTER TIGHTENING FRONT PUSHBEAM BOLTS INSTALL ONE 3/16 X 1-3/4 COTTER PIN (10) INTO EACH BOLT.