

SERIES
HS

MAZDA B2600

1987-1990

AM291

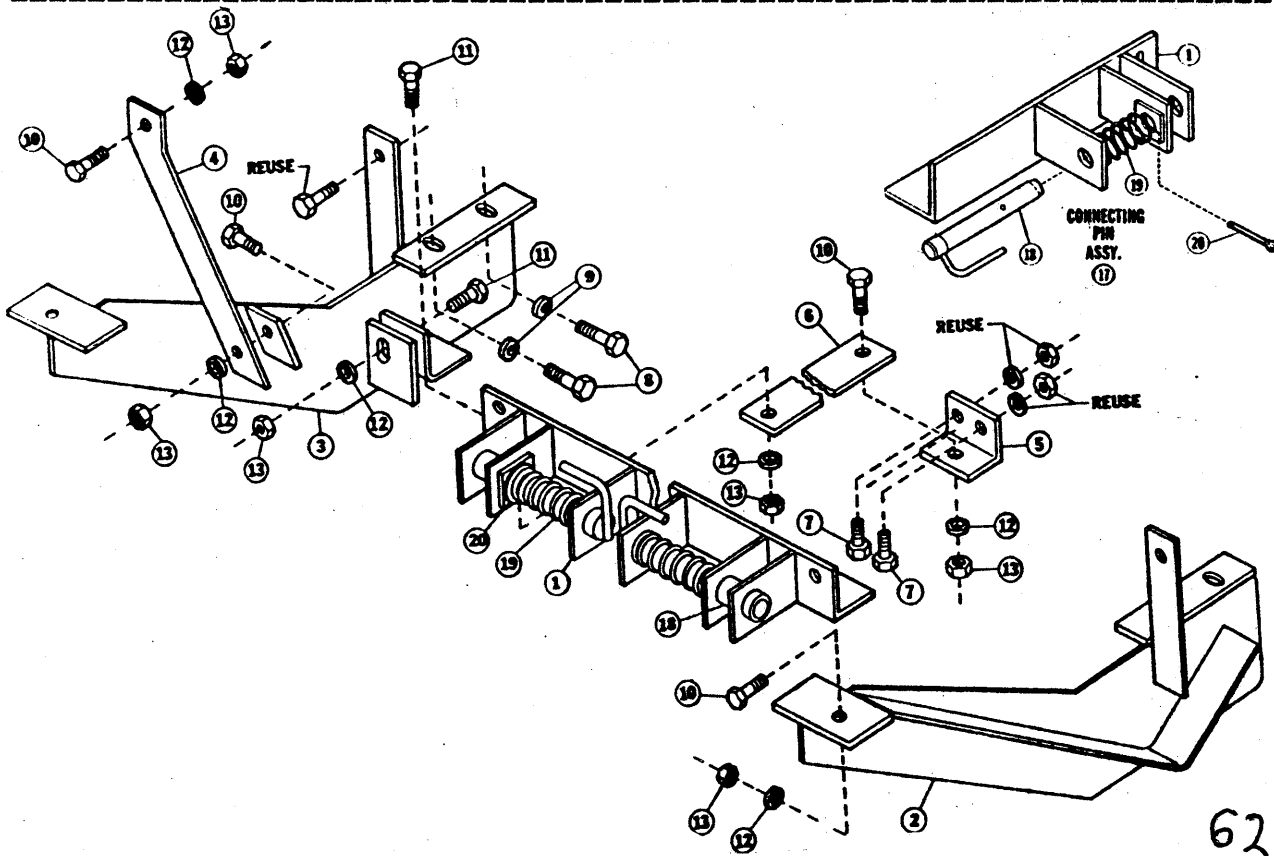

REF# PART# QTY DESCRIPTION
* PART OF 6782 BOLT BAG

REF#	PART#	QTY	DESCRIPTION
1	A5993	1	PUSHBEAM (27" DAL)
2	6105	1	PUSHPLATE, DRIVER'S SIDE
3	6106	1	PUSHPLATE, PASSENGER'S SIDE
4	5128	2	HEADGEAR BRACE
5	6101	2	ANGLE BRACKET
6	6104	2	STRAP
7	90405	4	* M12 X 1.5 X 100 GR 10.9 CAPSCREW
8	90573	4	* M12 X 1.5 X 35 GR.10.9 CAPSCREW
9	90430	4	* M12 LOCKWASHERS
10	90575	8	* 1/2 X 1-1/4 (NC) GR.5 CAPSCREW
11	90210	4	* 1/2 X 1-1/2 (NC) GR.5 CAPSCREW
12	90364	12	* 1/2 LOCKWASHER
13	90337	12	* 1/2 (NC) NUT
14	4289	2	* 3/4 X 1-7/8 MACHINE PIN
15	90658	2	* 5/32 X 1-1/4 COTTER PIN
16	3	1	CONNECTING PIN RELEASE
17	6920	2	CONNECTING PIN ASSEMBLY
18	6815	2	CONNECTING PIN W/ HANDLE
19	821	2	* SPRING
20	90601	2	* 1/4 X 1-1/2 COTTER PIN
21	7273	1	* CHAIN - 1/4 X 5-3/4
22	7275	1	* CHAIN CONNECTING LINK
	A6109	1	DASH BRACKET BAG

DIAMETER- THREADS PER INCH	FASTENER TORQUE (FT-LB)		
	GRADE DESIGNATION		
	GRADE 2	GRADE 5	GRADE 8
1/4 - 20	6	9	13
5/16 - 18	11	18	28
3/8 - 16	19	31	46
7/16 - 14	30	50	75
1/2 - 13	45	75	115
9/16 - 12	66	110	165
5/8 - 11	93	150	225
3/4 - 10	150	250	370
7/8 - 9	150	378	591
1 - 8	220	533	893

SERIES
HS

MAZDA B2600 1987-1990

AM291

INSTALLATION INSTRUCTIONS

PECULIAR ATTACHMENTS

1. REMOVE BOTH FRONT AND REAR SPLASH PANS FROM UNDER FRONT OF VEHICLE. REMOVE SMALL PLATE FROM UNDER RADIATOR. REMOVE BOTH TIE DOWN BRACKETS FROM UNDER FRONT OF FRAME. ONLY THE REAR SPLASH PAN WILL BE REINSTALLED AFTER THE ATTACHMENTS ARE IN PLACE.
2. REMOVE TWO BOLTS VISIBLE AND ACCESSIBLE FROM OPENING IN AIR DAM BELOW BUMPER AND JUST INSIDE OF PARKING LIGHTS. INSTALL BOTH PUSHPLATES (2,3) BY SLIDING UPPER HANGERS BEHIND AIR DAM AND UP UNTIL HOLE IN HANGERS ALIGN WITH HOLES FROM WHICH THE BOLTS WERE JUST REMOVED. REINSTALL VEHICLE BOLTS BUT DO NOT TIGHTEN. (DO NOT TIGHTEN ANY FASTENERS UNTIL ALL ATTACHMENT COMPONENTS HAVE BEEN INSTALLED). INSTALL (2) M12 X 1.5 X 35 GR 10.9 CAPSCREWS (8) WITH LOCKWASHERS (9) UP THROUGH PLATE PADS OF BOTH PUSHPLATES INTO TIE DOWN BOLT HOLES IN BOTTOM OF FRAME.
3. INSTALL CONNECTING PIN ASSEMBLIES TO PUSHBEAM (1). FIRST INSERT SPRINGS (19) BETWEEN THE TWO INNER EARS ON EACH END OF THE PUSH BEAM. INSERT CONNECTING PINS (18) THROUGH ALL THREE EARS WITH HANDLES TOWARDS CENTER OF BEAM. LEAVING THE HOLE IN THE PINS BETWEEN THE TWO INNER EARS, PULL BACK ON SPRINGS AND INSTALL COTTER PIN (20).
4. LIFT PUSHBEAM UP INTO POSITION BETWEEN PUSHPLATES WITH EARS OF PUSHBEAM FACING FORWARD. SECURE BY PLACING (IN EACH END OF PUSHBEAM) ONE 1/2 X 1-1/2 (NC) GR.5 CAPSCREW (11) OUT THROUGH FACE OF PUSHBEAM AND ONE 1/2 X 1-1/2 (NC) GR.5 CAPSCREW (11) DOWN THROUGH BOTTOM SIDE OF PUSHBEAM. FASTEN THE UPPER CAPSCREWS WITH LOCKWASHERS (12) AND NUTS (13). DO NOT INSTALL LOCKWASHERS AND NUTS ON BOTTOM CAPSCREWS AT THIS TIME.
5. REMOVE FOUR BOLTS FROM FACE OF CROSSMEMBER BELOW ENGINE. SAVE LOCKWASHERS AND NUTS. WITH THE PROTRUDING LEG OF THE ANGLE DOWN, ALIGN HOLES IN ANGLE BRACKETS (5) WITH HOLES IN CROSSMEMBER. FASTEN ANGLE BRACKETS TO CROSSMEMBER WITH (4) M12 X 1.5 X 100 GR.10.9 CAPSCREWS (7) AND THE ORIGINAL LOCKWASHERS AND NUTS. INSTALL STRAPS (6) BETWEEN THE ANGLE BRACKETS AND PUSHBEAM. THE FORWARD END OF THE STRAP IS PLACED ONTO THE PUSHBEAM CAPSCREW AND IS FASTENED WITH A 1/2" LOCKWASHER (12) AND NUT (13). THE AFT END RESTS ON THE TOP SIDE OF THE ANGLE BRACKET AND IS FASTENED WITH A 1/2 X 1-1/4 (NC) GR.5 CAPSCREW (10), LOCKWASHER (12) AND NUT (13).
6. INSTALL HEADGEAR (FROM COMMON ATTACHING BOX) ONTO PUSHPLATE TABS AND SECURE WITH TWO 1/2 X 1-1/4 (NC) GR.5 CAPSCREWS (10) DOWN THROUGH HOLES. FASTEN WITH LOCKWASHERS (12) AND NUTS (13).
7. INSTALL HEADGEAR BRACES (4) BETWEEN HEADGEAR AND FORWARD FACE OF TAB ON PUSHPLATE. (BENT END OF BRACE CONNECTS TO HEADGEAR). FASTEN WITH (4) 1/2 X 1-1/4 (NC) GR.5 CAPSCREWS (10), LOCKWASHERS (12) AND NUTS (13).
8. TIGHTEN ALL FASTENERS BEGINNING WITH THE BEAM AND FINISHING WITH HEADGEAR. REINSTALL REAR SPLASH PAN.

NOTE: AN EXTRA LENGTH OF LIFT CHAIN (21) AND A CONNECTING LINK (22) ARE SUPPLIED WITH THIS KIT TO BE USED IF NECESSARY TO PROVIDE FOR SUFFICIENT BLADE TRAVEL WHEN ELECTRIC HYDRAULIC PAK KITS ARE USED.