

SERIES
HS

DODGE D-50
MIGHTY MAX

1982-19
1987-19

AM253
REV D

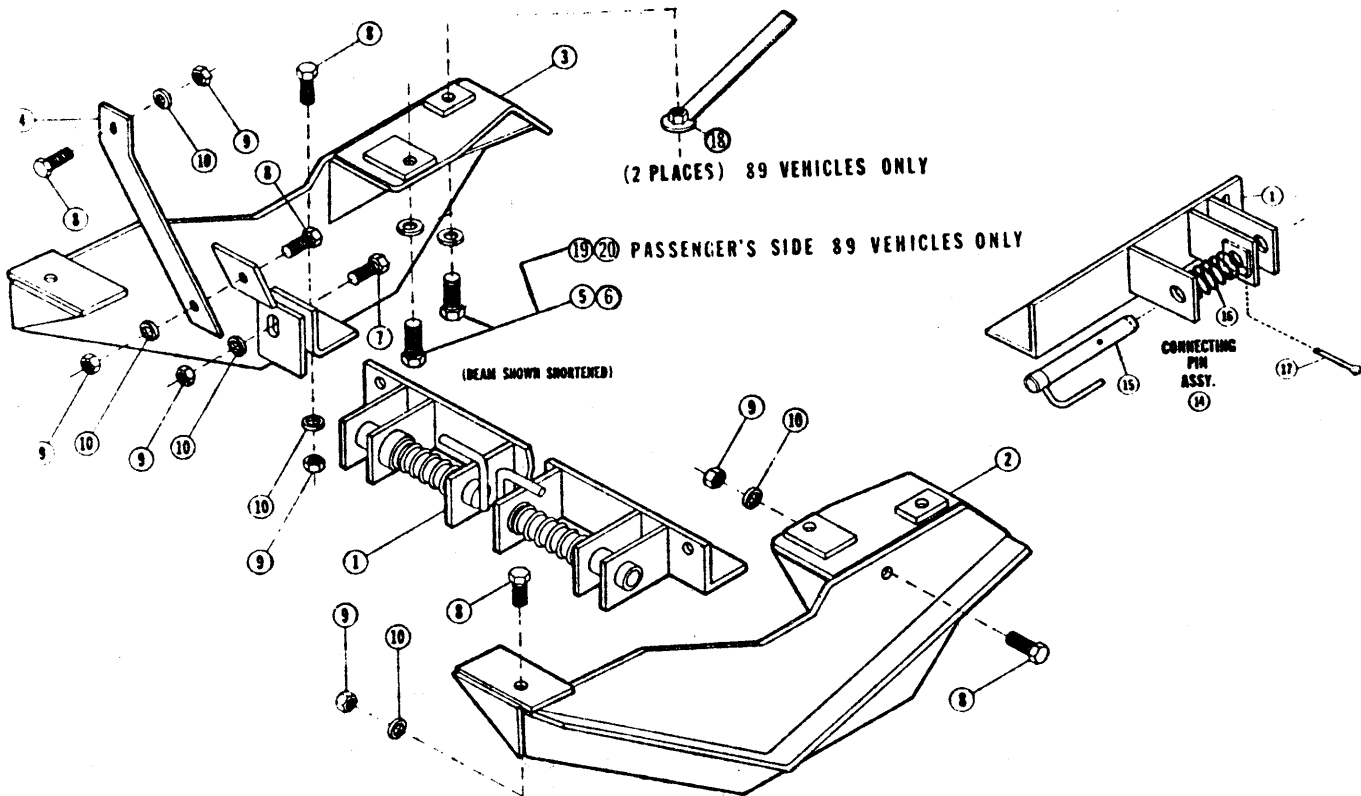

6255

REF#	PART#	QTY	DESCRIPTION	* PART OF 6785 BOLT BAG
1	A5417	1	PUSHBEAM (29-5/8 OAL)	
2	5512	1	PUSHPLATE, DRIVER'S SIDE	
3	5513	1	PUSHPLATE, PASSENGER SIDE	
4	5128	2	HEADGEAR BRACE	
5	90590	4	* M10 X 1.25 X 40 GR. 8.8 CAPSCREW	
6	90429	4	* M10 LOCKWASHER	
7	90210	2	* 1/2 X 1-1/2 (NC) GR.5 CAPSCREW	
8	90575	10	* 1/2 X 1-1/4 (NC) GR.5 CAPSCREW	
9	90337	12	* 1/2 (NC) NUT	
10	90364	12	* 1/2 LOCKWASHER	
11	4289	2	* 3/4 X 1-7/8 MACHINE PIN	
12	90658	2	* 5/32 X 1-1/4 COTTER PIN	
13	3	1	CONNECTING PIN RELEASE	
14	6920	2	CONNECTING PIN ASSEMBLY	
15	6815	2	CONNECTING PIN W/HANDLE	
16	821	2	* SPRING	
17	90601	2	* 1/4 X 1-1/2 COTTER PIN	
18	6966	2	* 3/8 NUT W/HANDLE	
19	90111	2	* 3/8 X 1-1/2 (NC) GR.5 CAPSCREW	
20	90361	2	* 3/8 LOCKWASHER	
	A6050	1	DASH BRACKET BAG	

DIAMETER- THREADS PER INCH	FASTENER TORQUE (FT-LB)		
	GRADE DESIGNATION		
	GRADE 2	GRADE 5	GRADE 8
1/4 - 20	6	9	13
5/16 - 18	11	18	28
3/8 - 16	19	31	46
7/16 - 14	30	50	75
1/2 - 13	45	75	115
9/16 - 12	66	110	165
5/8 - 11	93	150	225
3/4 - 10	150	250	370
7/8 - 9	150	378	591
1 - 8	220	583	893

1. **FOR 1982-1988 VEHICLES:** REMOVE FORWARD SPLASH PAN AND TOW HOOK FROM UNDER FRONT OF VEHICLE. PLACE PASSENGER SIDE PUSHPLATE (3) INSIDE OF VEHICLE SHIPPING BRACKET WITH PUSHPLATE MOUNTING PAD UP AND BACK AGAINST VEHICLE FRAME. INSTALL TWO M10 X 1.25 X 40 CAPSCREWS (5) WITH M10 LOCKWASHERS (6) UP THROUGH PUSHPLATE MOUNTING PADS INTO TAPPED HOLES IN VEHICLE FRAME. LEAVE CAPSCREWS LOOSE. REPEAT ABOVE PROCEDURE FOR DRIVER'S SIDE PUSHPLATE (2).

FOR 1989 VEHICLES: REMOVE FORWARD SPLASH PAN AND TOW HOOK FROM UNDER FRONT OF VEHICLE. PLACE PASSENGER SIDE PUSHPLATE (3) INSIDE OF VEHICLE SHIPPING BRACKET WITH PUSHPLATE MOUNTING PAD UP AND BACK AGAINST VEHICLE FRAME. PLACE TWO 3/8 X 1-1/2 (NC) GR.5 CAPSCREWS (19) WITH 3/8 LOCKWASHERS (20) UP THROUGH PUSHPLATE MOUNTING PADS & FASTEN TO TWO 3/8 NUTS W/HANDLES (18) INSTALLED IN SLOTS IN VEHICLE FRAME.

NOTE: BEND HANDLES ON NUTS IF NECESSARY. CUT EXCESS HANDLE FROM REARMOST NUT TO INSURE TIRE CLEARANCE IN TIGHT LEFT HAND TURNS. ATTACH DRIVER'S SIDE PUSHPLATE (2) WITH EXISTING FRAME NUTS AND TWO M10 X 1.25 X 40 CAPSCREWS (5) AND TWO M10 LOCKWASHERS (6). LEAVE CAPSCREWS LOOSE.

2. ASSEMBLE CONNECTING PINS (14) TO PUSHBEAM (1). FIRST INSERT SPRINGS (16) BETWEEN TWO INNER EARS ON EACH SIDE OF PUSHBEAM. THEN INSERT CONNECTING PIN (15) THROUGH ALL THREE EARS WITH HANDLE OF PIN TOWARDS THE CENTER OF THE BEAM. LEAVING THE HOLE IN THE PIN BETWEEN THE INNER TWO EARS, PULL BACK ON SPRINGS AND INSTALL COTTER PIN (17).
3. LIFT PUSHBEAM (1) UP INTO POSITION BETWEEN PUSHPLATE TABS WITH EARS OF PUSHBEAM FACING FORWARD. SECURE BY PLACING (IN EACH END OF PUSHBEAM) ONE 1/2 X 1-1/2 CAPSCREW (7) OUT THROUGH FACE OF PUSHBEAM AND ONE 1/2 X 1-1/4 CAPSCREW (8) DOWN THROUGH BOTTOM SIDE OF PUSHBEAM. SECURE THESE BOLTS WITH 1/2" LOCK-WASHERS (10) AND NUTS (9). LEAVE LOOSE.
4. INSTALL HEADGEAR (FROM COMMON ATTACHING BOX) ONTO PUSHPLATE TABS AND SECURE USING TWO 1/2 X 1-1/4 BOLTS (8), LOCKWASHERS (10) AND NUTS (9). BOLTS SHOULD BE INSTALLED UP THROUGH HOLES.
5. INSTALL HEADGEAR BRACES (4) (WITH BENT END ON TOP) TO FRONT OF TAB ON PUSHPLATES AND TO LOWEST POSITION ON HEADGEAR POSTS. SECURE ENDS OF EACH BRACE WITH ONE 1/2 X 1-1/4 CAPSCREW(8), LOCKWASHER(10) & NUT(9).
6. TIGHTEN ALL NUTS AND BOLTS GRADUALLY AND EVENLY. USING THE HOLE IN THE DRIVERS AND PASSENGERS SIDE PUSHPLATE AS A GUIDE, REAM THE VEHICLE SHIPPING BRACKET HOLES TO MATCH. INSTALL ONE 1/2 X 1-1/4 CAPSCREW (8) OUT THROUGH EACH PUSHPLATE AND SECURE WITH ONE LOCKWASHER (10) AND NUT (9). RECHECK ALL BOLTS FOR TIGHTNESS WHEN FINISHED.
7. CUT FORWARD SPLASH PAN AS SHOWN BELOW AND REINSTALL USING THE CAPSCREWS, NUTS AND WASHERS ORIGINALLY REMOVED (TWO CAPSCREWS, NUTS AND WASHERS WILL BE LEFT OVER).
8. IF IT IS DESIRABLE TO REINSTALL TOW HOOK DO SO ON THE OUTSIDE OF THE PASSENGER SIDE PUSHPLATE (3). LOCATE TOW HOOK BELOW AND FORWARD OF COMBINATION SHIPPING PAD LUG AND ABOVE THE PUSHPLATE STIFFENER. DRILL TWO 15/32" HOLES USING TOW HOOK AS A PATTERN. ATTACH TOW HOOK USING THE TWO CAPSCREWS, NUTS AND WASHERS LEFT OVER FROM THE SPLASH PAN.

