

SERIES DODGE W100, 150
 L RAM CHARGER, PLY TRAIL DUSTER
 DODGE W150

1972-1988
 1972-19__
 1992-19__

7116
 REV B

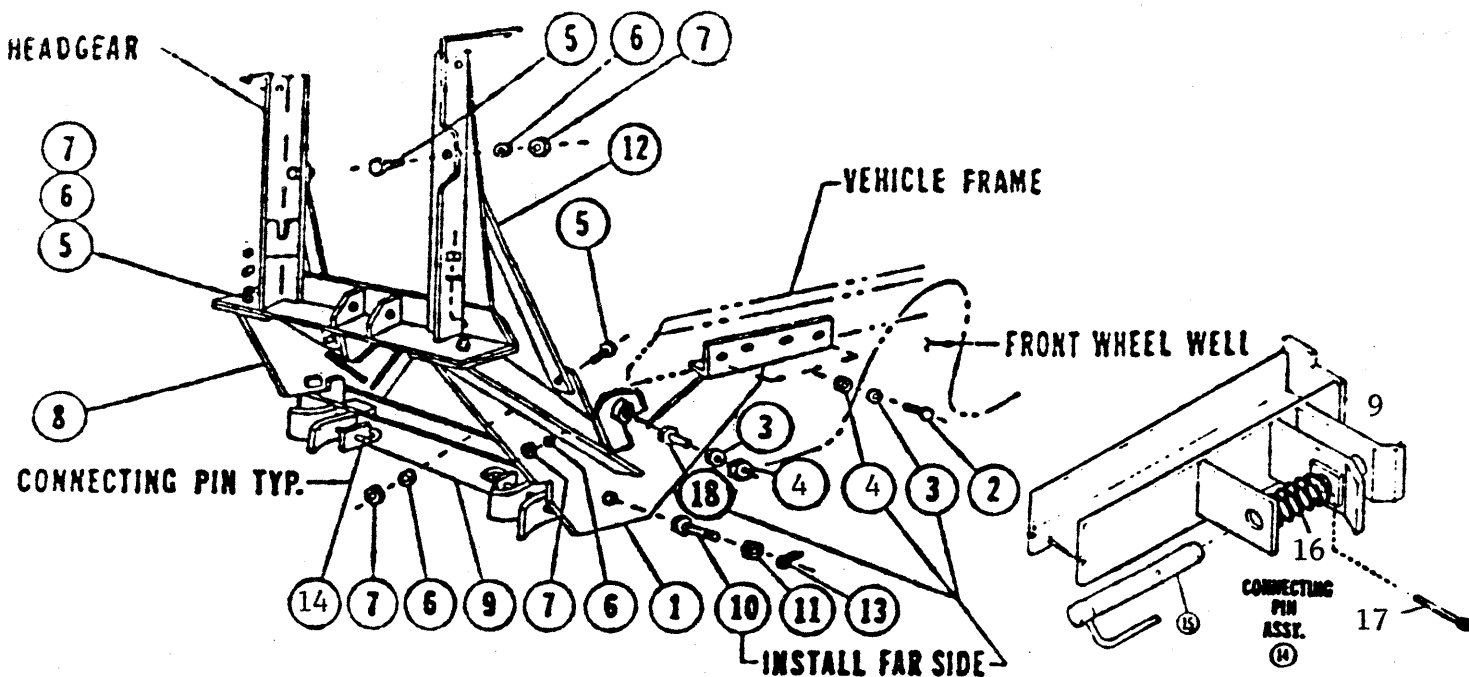

6390

REF# PART# QTY DESCRIPTION * PART OF 6743 BOLT BAG

REF#	PART#	QTY	DESCRIPTION	* PART OF 6743 BOLT BAG
1	8021	1	DRIVER SIDE PUSHPLATE	
2	90244	4	* 5/8-11 X 1-1/2 (NC) GR.5 CAPSCREW	
3	90366	6	* 5/8 LOCKWASHER	
4	90343	6	* 5/8-11 (NC) NUT	
5	90210	6	* 1/2-13 X 1-1/2 GR.5 (NC) CAPSCREW	
6	90364	8	* 1/2 LOCKWASHER	
7	90337	8	* 1/2-13 (NC) NUT	
8	7696	1	PASSENGER SIDE PUSHPLATE	
9	1510	1	PUSHBEAM (26-7/8" OVERALL LENGTH)	
10	5005	2	* 5/8-11 X 1-1/2 (NC) DRILLED CAPSCREW	
11	90446	2	* 5/8-11 (NC) SLOTTED NUT	
12	5020	2	HEADGEAR BRACE	
13	90012	2	* 3/16 X 1-3/4 COTTER PIN	
14	6920	2	CONNECTING PIN ASSEMBLY	
15	6815	2	CONNECTING PIN W/HANDLE	
16	821	2	* SPRING	
17	90601	2	* 1/4 X 1-1/2 COTTER PIN	
	4289	2	* 3/4 X 1-7/8 MACHINE PIN	
	90658	2	* 5/32 X 1-1/4 COTTER PIN	
	3	1	CONNECTING PIN RELEASE	
18	90249	2	* 5/8-11 X 2-1/2 (NC) GR.5 CAPSCREW	
19	5528	1	CYLINDER PROTECTOR (NOT SHOWN)	
20	90575	2	* 1/2 - 13 X 1-1/4 (NC) GR.5 CAPSCREW	
	A5867	1	DASH BRACKET BAG	

FASTENER TORQUE (FT-LB)			
DIAMETER- THREADS PER INCH	GRADE		
	62	65	68
1/4 - 20	6	9	13
5/16 - 18	11	18	28
3/8 - 16	19	31	46
7/16 - 14	30	50	75
1/2 - 13	45	75	115
9/16 - 12	66	110	165
5/8 - 11	93	150	225
9/16 - 12	150	250	370
7/8 - 9	150	378	591
1 - 8	220	583	893

NOTE: DO NOT TIGHTEN FASTENERS UNTIL ALL PARTS HAVE BEEN ASSEMBLED.

- A.** LIFT VEHICLE, USING FLOOR JACK UNDER TRANSMISSION CROSSMEMBER.
- B.** REMOVE 7/16 BOLTS FROM FRONT BUMPER BRACKETS (THE LOWER ONE OF THREE). REAM HOLES TO 5/8" BOTH SIDES.
- C.** INSERT TWO 1/2 X 1-1/2 GR. 5 CAPSCREWS OUT THROUGH THE HEADGEAR BRACE TAB ON BOTH PUSHPLATES (2) AND (3). INSTALL DRIVER SIDE PUSHPLATE (1) OVER SWAY BAR (IF SO EQUIPPED), UNDER AND OUTSIDE OF VEHICLE FRAME AND INSIDE OF SPRING, WITH FRONT TAB OVER 5/8" REAMED HOLE OF FRAME. INSTALL ONE 5/8 X 2-1/2 CAPSCREW (18) OUT THROUGH FRAME AND FRONT TAB. FASTEN WITH A LOCKWASHER (3) AND NUT (4). ROTATE REAR OF PUSHPLATE UP AGAINST FRAME AND INSTALL ONE 5/8 X 1-1/2 CAPSCREW (2) IN FORWARD HOLE OF REAR PUSHPLATE ANGLE SECTION AND FASTEN WITH A LOCKWASHER (3) AND NUT(4).
NOTE: ON PASSENGER SIDE, IF HOLE ON PUSHPLATE ANGLE DOES NOT LINE UP WITH FRAME HOLE, CLAMP PUSHPLATE UP AGAINST FRAME AND REAM HOLE WITH 5/8 DRILL.
- D.** INSTALL PASSENGER SIDE PUSHPLATE (8) IN SAME MANNER AS DRIVERS SIDE PUSHPLATE (STEP C ABOVE).
- E.** ASSEMBLE CONNECTING PINS (14) TO PUSHBEAM (9). FIRST INSERT SPRING (16) BETWEEN TWO INNER EARS ON EACH SIDE OF PUSHBEAM. THEN, INSERT CONNECTING PIN (15) THROUGH ALL THREE EARS WITH HANDLE OF PIN TOWARDS THE CENTER OF THE BEAM. LEAVING THE HOLE IN THE PIN BETWEEN THE INNER TWO EARS, PULL BACK ON SPRING AND INSTALL COTTER PIN (17).
- F.** INSTALL PUSHBEAM (9) BETWEEN INSTALLED PUSHPLATES USING TWO DRILLED 5/8 X 1-1/2 CAPSCREWS (10), INSERTED FROM INSIDE AND SLOTTED NUTS (11).
- G. NOTE: HEADGEAR IS PACKED IN COMMON ATTACHING BOX.** INSTALL HEADGEAR ON FRONT PUSHPLATE TABS USING ONE 1/2X1-1/2 GR.5 BOLT(5) UP THROUGH PUSHPLATE TAB AND HEADGEAR WITH LOCKWASHER (6) AND NUT (7) ON TOP.
- H.** INSTALL CYLINDER PROTECTOR (19) ONTO BOTTOM OF HEADGEAR WITH FLANGE REARWARD AND POINTING DOWN USING TWO 1/2 X 1-1/4 (NC) CAPSCREWS (20), LOCKWASHERS (6), AND NUTS (7).
- I.** INSTALL HEADGEAR BRACES(12) TO HEADGEAR USING 1/2X1-1/2 GR.5 BOLT(5) LOCKWASHERS(6) AND NUTS(7). ATTACH OTHER END OF BRACES TO FRONT PUSH-PLATE TAB USING PREVIOUSLY INSTALLED BOLTS, LOCKWASHERS(6) AND NUTS(7).
- J.** TIGHTEN PUSHBEAM BOLTS AND NUTS AND SECURE WITH 3/16 X 1-3/4 COTTER PINS (13). TIGHTEN ALL OTHER BOLTS AND NUTS INSTALLED.
- K.** USING REAR HOLE OF EACH PUSHPLATE ANGLE SECTION AS A GUIDE, AND ENSURING THAT FRAME WEB IS CLEAR OF ALL LINES AND WIRES (IF PRESENT, MOVE AWAY FROM WHERE DRILL WILL PASS THROUGH FRAME), DRILL ONE 11/16 HOLE IN EACH SIDE OF VEHICLE FRAME. INSTALL ONE 5/8 X 1-1/2 BOLT (2) THROUGH EACH PUSHPLATE AND DRILLED FRAME HOLE AND FASTEN WITH TWO LOCKWASHERS (3) AND TWO NUTS (4).
- L.** AFTER TIGHTENING, ENSURE THAT ALL LINES AND WIRES ARE WELL AWAY FROM ANY SHARP EDGES OR ATTACHMENTS, ETC.