

International 4600
International 4700
w-w/o Tilt Hood

1989-1994
1989-19__

7140

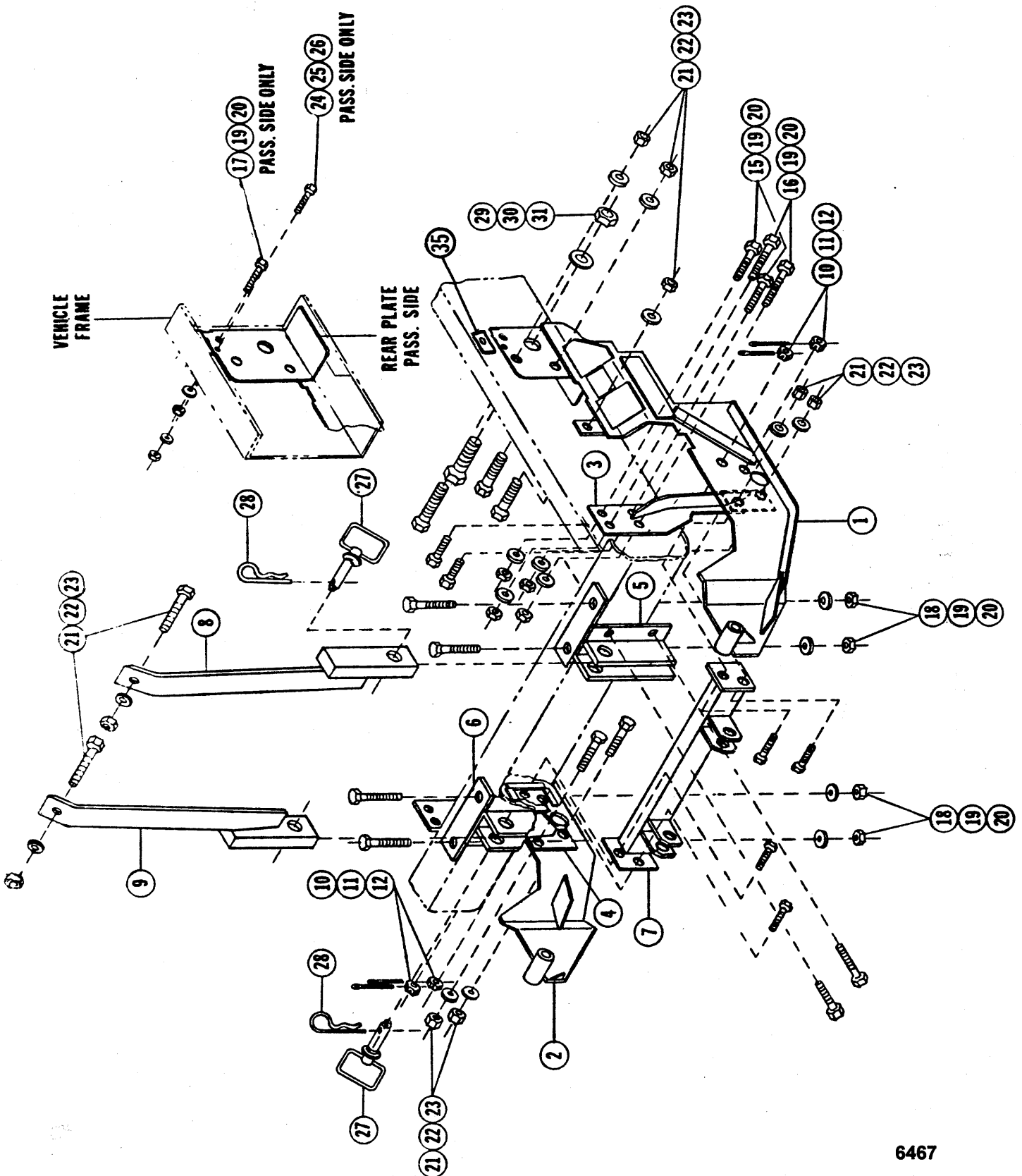

6467

Parts List



Ref #	Part #	Qty	Description	Ref #	Part #	Qty	Description
1	8904	1	Pushplate Driver's Side	20	*90337	14	1/2 Nut ZP
2	8905	1	Pushplate Passenger's Side	21	*90244	12	5/8 x 1-1/2 Cap Screw (NC) Gr 5 ZP
3	7365	1	Hanger Driver's Side	22	*90366	12	5/8 Lock Washer ZP
4	7366	1	Hanger Passenger's side	23	*90343	12	5/8 Nut (NC) ZP
5	7367	1	Bumper Bracket Driver's Side	24	*90054	2	5/16 x 1-1/2 Cap Screw (NC) G5 ZP
6	7368	1	Bumper Bracket Passenger's Side	25	*90360	2	5/16 Lock Washer ZP
7	9014	1	Pushbeam (41 1/4")	26	*90332	2	5/16 Nut (NC) ZP
8	7369	1	Headgear Brace Driver's Side	27	*7317	2	Clevis Pin
9	7370	1	Headgear Brace Passenger's Side	28	*7319	2	Hairpin Cotter 3/4"
10	*5005	4	5/8 x 1-1/2 Drilled Cap Screw	29	*90640	2	1" - 8 x 2" (NC) Cap Screw Gr 5 ZP
11	*90446	4	5/8 UNC Slotted Nut	30	*90641	2	1" Lock Washer
12	*90012	4	Cotter Pin	31	*90642	2	1" Nut (NC)
13	*4289	2	3/4 x 1-7/8 Machine Pin		*5194	2	1/4 x 5 Hairpin Cotter
14	*90658	2	5/32 x 1-1/4 Cotter Pin		*5458	2	Connecting Pin - Commercial
15	*90218	4	1/2 x 2 Cap Screw (NC) Gr 8 ZP		7371	1	Dash Bracket Bag
16	*90223	4	1/2 x 2-1/2 Cap Screw (NC) Gr 5 ZP	35	*8671	1	Spacer
17	*90210	2	1/2 x 1-1/2 Cap Screw (NC) Gr 5 ZP				
18	*90575	4	1/2 x 1-1/4 Cap Screw (NC) Gr 5 ZP				
19	*90364	14	1/2 Lock Washer ZP				

Installation Instructions

RESTRICTION: 10,000 Pound Maximum Front GAWR (Gross Axle Weight Rating).

- A. Turn front wheels for left hand turn as far as possible. Remove and save two nuts and bracket holding brake lines on driver's side. Remove heater hose brace from passenger's side of frame.
- B. On drivers' side, remove the four fasteners and tow hook behind bumper and discard. Install hanger (3) with two 1/2 x 2 (NC) Gr. 8 ZP cap screws (15) on two rear holes and two 1/2 x 2-1/2 (NC) Gr. 5 ZP cap screws in forward holes. Fasten with 1/2" lock washers (19) and nuts (20). **Do not tighten at this time.** Repeat the same on passenger's side. Remove shocks on both sides.
- C. Install driver's side pushplate (1) on outside of leaf spring and frame. Hold pushplate up to frame and hanger. Fasten to hanger with two 5/8 x 1-1/2 cap screws (21) lock washers (22) and nuts (23). Hold rear of pushplate up to bottom of frame. Reinstall brake line bracket and add spacer (35) to top bracket bolt on driver's side. On rear angle, install one 5/8 x 1-1/2 cap screw (21), lock washer (22) and nut (23), and one 1" x 2" cap screw (29) lock washer (30) and nut (31). Repeat the same on passenger's side pushplate and add one 1/2 x 1-1/2 cap screw (17) lock washer (19) and nut (20). Reinstall heater hose brace using two 5/16 x 1-1/2 cap screws (24), lock washers (25) and nuts (26). Reinstall shocks.
- D. Remove both cap screws on driver's side of front bumper and install headgear brace bracket (5) (6) reusing cap screws.
- E. Install beam assembly (7) and fasten with four 5/8 x 1-1/2 drilled cap screws (10) and slotted nuts (11).
- F. Install headgear as per common attachments instructions.

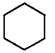
- G. Install headgear braces (8,9) with two 5/8 x 1-1/2 cap screws (21), lock washers (22) and nuts (23) on headgear. Install lower end of braces to bumper bracket with two clevis pins (27) and 3/4" hair pin cotter (28).
- H. Tighten pushbeam bolts/nuts and install cotter pins (12).
- I. Tighten all hanger and pushplate fasteners.
- J. Drill four holes in bumper top flange, using hanger holes as guides. Fasten with four 1/2 x 1-1/4 cap screws (18) lock washers (19), nuts (20) and tighten.
- K. Drill one 11/16" hole on each center tab and rear plate of each pushplates (Total of four holes). **Check inside of frame to make sure everything is clear before drilling.** Install four 5/8 x 1-1/2 cap screws (21) lock washers (22), nuts (23) and tighten.
- L. Tighten 5/8 cap screws on headgear braces.

FASTENER TORQUE (FT-LB)			
DIAMETER- THREADS PER INCH	GRADE		
			
	G2	G5	G8
1/4 - 20	6	9	13
5/16 - 18	11	18	28
3/8 - 16	19	31	46
7/16 - 14	30	50	75
1/2 - 13	45	75	115
9/16 - 12	66	110	165
5/8 - 11	93	150	225
9/16 - 12	150	250	370
7/8 - 9	150	378	591
1 - 8	220	583	893