

# Throttle Control Motor Kit

## Honda Engines

### Hopper Spreaders

#### INSTALLATION INSTRUCTIONS

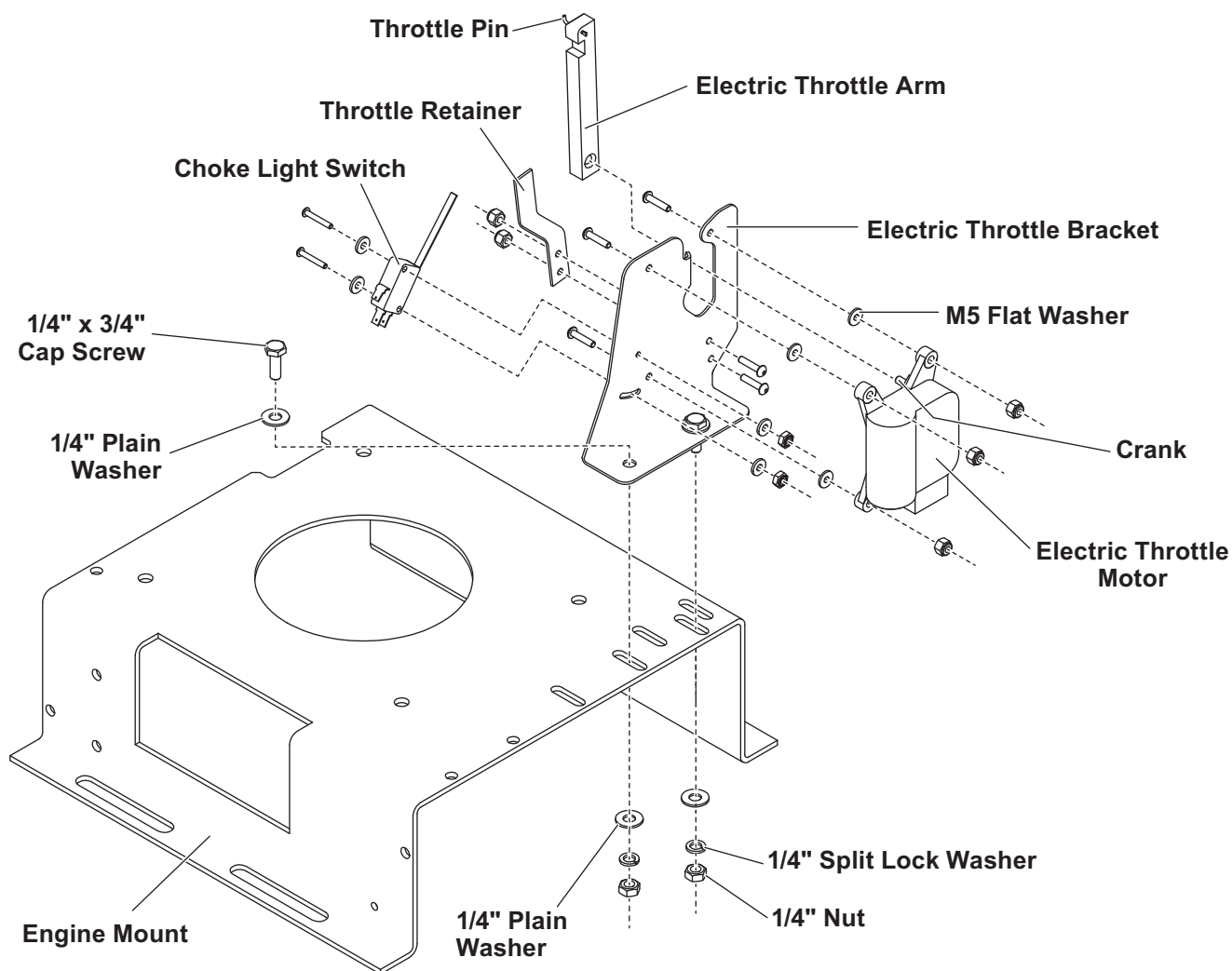

#### ⚠ CAUTION

Use standard methods and practices when attaching spreader and installing accessories, including proper personal protective safety equipment.

## Removal Instructions

### **⚠ CAUTION**

**Improper installation can result in damage to the engine choke/throttle linkage.**

1. Disconnect the battery cables.
2. Disconnect the brown and red spreader harness wires from the electric throttle motor leads.
3. Remove the 1/4" fasteners that hold the electric throttle bracket to the engine mount.
4. Remove the electric throttle control assembly, including the throttle arm that is connected to the engine's throttle/choke linkage.

4. Connect the throttle arm pin into the top hole of the engine's throttle/choke linkage, as shown below. (The fuel tank may be removed to make this easier.)

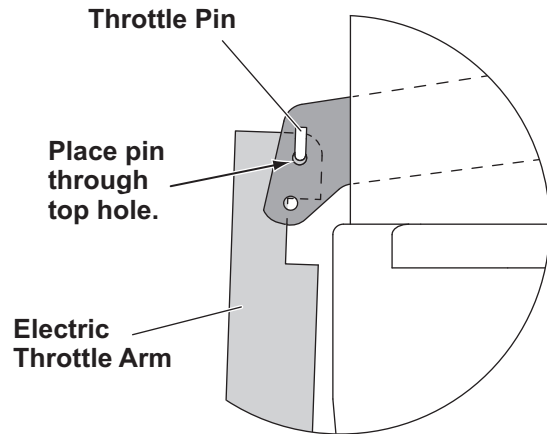

## Installation Instructions

1. Connect the red wire from the spreader harness to the red motor wire, and the brown wire from the spreader harness to the brown motor wire.
2. Using the electric throttle control, run the new motor until the crank reaches the 10 o'clock position, viewed from the switch side of the bracket. (A 9-volt battery can be used as a substitute for the control.)
3. Connect the two green wires to the normally open (NO) and common (COMM) terminals on the choke light switch.
5. Place the electric throttle control motor assembly onto the engine mount as shown in the illustration on Page 1. Loosely fasten it to the engine mount with the existing hardware (1/4" fasteners).
6. Position the electric throttle control assembly so that the throttle arm can operate the linkage without contacting any engine parts. Tighten the 1/4" fasteners to 6 ft-lb.
7. Reconnect the battery cables.
8. Verify that the crank is stopped in both directions by the bracket and the retainer, not the carburetor linkage.

The company reserves the right under its product improvement policy to change construction or design details and furnish equipment when so altered without reference to illustrations or specifications used. This equipment manufacturer or the vehicle manufacturer may require or recommend optional equipment for spreaders. Do not exceed vehicle ratings with a spreader. The company offers a limited warranty for all spreaders and accessories. See separately printed page for this important information.

Printed in U.S.A.