

Throttle Control Motor Kit

Briggs & Stratton Engines

Hopper Spreaders

INSTALLATION INSTRUCTIONS

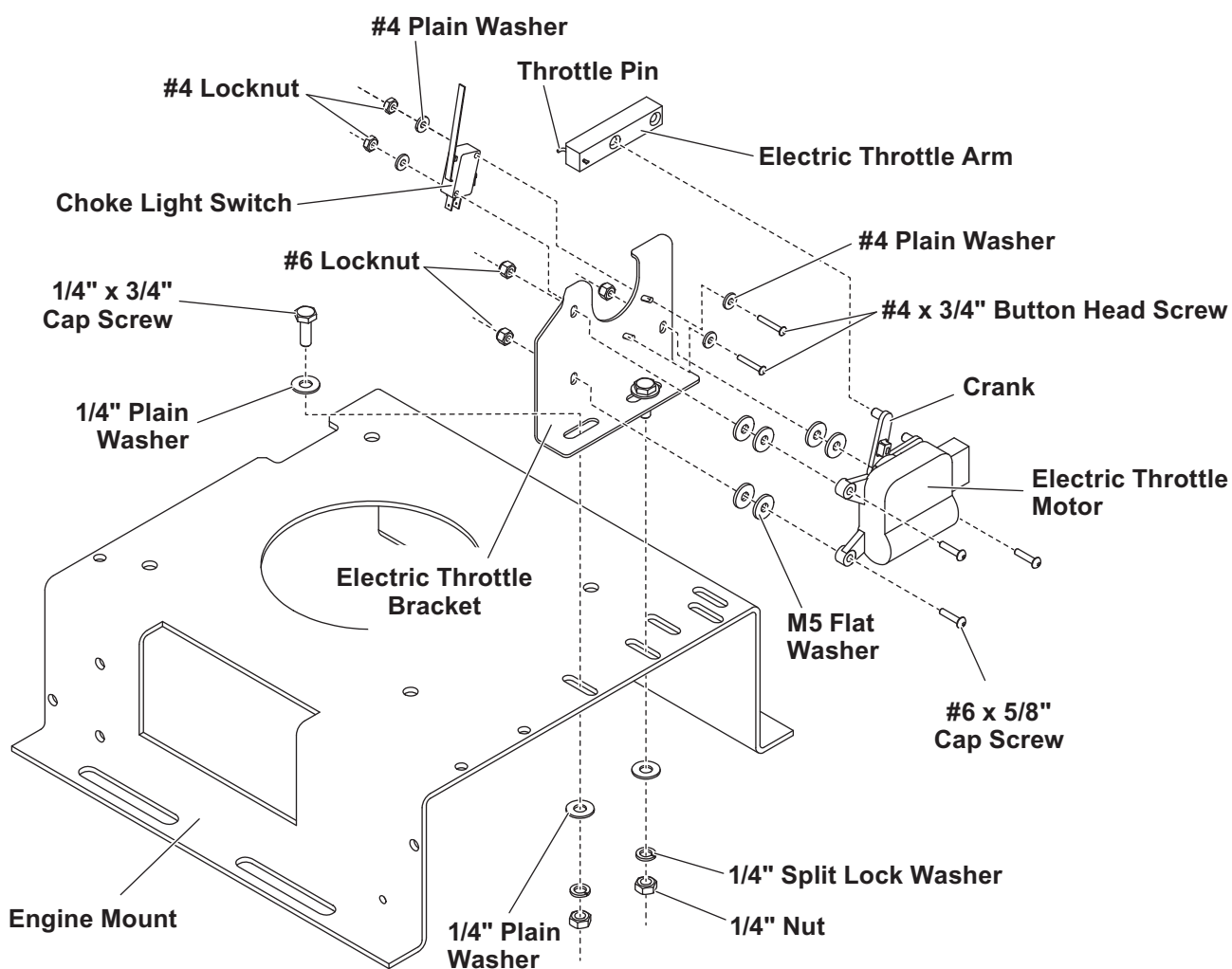

⚠ CAUTION

Use standard methods and practices when attaching spreader and installing accessories, including proper personal protective safety equipment.

Removal Instructions

CAUTION

Improper installation can result in damage to the engine choke/throttle linkage.

1. Disconnect the battery cables.
2. Carefully observe the existing installation. Mark the electric throttle position on the engine mount.
3. Disconnect the brown and red spreader harness wires from the electric throttle motor leads.
4. Remove the 1/4" fasteners that hold the electric throttle bracket to the engine mount.
5. Remove the #6 fasteners holding the electric throttle motor to the bracket and retain for reinstallation. Remove and retain the electric throttle motor and choke light switch.
4. Fasten the electric throttle motor to the bracket using the existing hardware (#6 fasteners).
5. Place two flat washers (M5 Regular) over the screws to space the motor off of the bracket.
6. Using the electric throttle control, run the new electric throttle motor until the crank is against the bracket tab closest to the choke light switch. Adjust the switch so the choke light will come ON.
7. Place the electric throttle arm (with hole in center of arm) on the crank as shown in the illustration on Page 1.
8. Place the electric throttle assembly onto the engine mount, inserting the throttle pin into the engine choke/throttle linkage plastic slider (not shown).
9. Loosely fasten the electric throttle assembly bracket to the engine mount with the existing hardware (1/4" fasteners).

Installation Instructions

1. Connect the red wire from the spreader harness to the red motor wire, and the brown wire from the spreader harness to the brown motor wire.
2. Using the electric throttle control, run the new motor until the crank reaches the 1 o'clock position. (A 9-volt battery can be used as a substitute for the control.)
3. Connect the two green wires to the normally open (NO) and common (COMM) terminals on the choke light switch. Attach the choke light switch to the bracket using the existing hardware.
10. Keeping the electric throttle arm parallel to and against the carburetor control bracket, move the electric throttle bracket forward, putting the engine throttle into the full-choke position.
11. Tighten the electric throttle bracket fasteners to 6 ft-lb.
12. Reconnect the battery cables.
13. Verify that the crank is stopped in both directions by the bracket, not the carburetor linkage.

The company reserves the right under its product improvement policy to change construction or design details and furnish equipment when so altered without reference to illustrations or specifications used. This equipment manufacturer or the vehicle manufacturer may require or recommend optional equipment for spreaders. Do not exceed vehicle ratings with a spreader. The company offers a limited warranty for all spreaders and accessories. See separately printed page for this important information.

Printed in U.S.A.