

Throttle Control Motor Kit

Tecumseh Engines

Hopper Spreaders

INSTALLATION INSTRUCTIONS

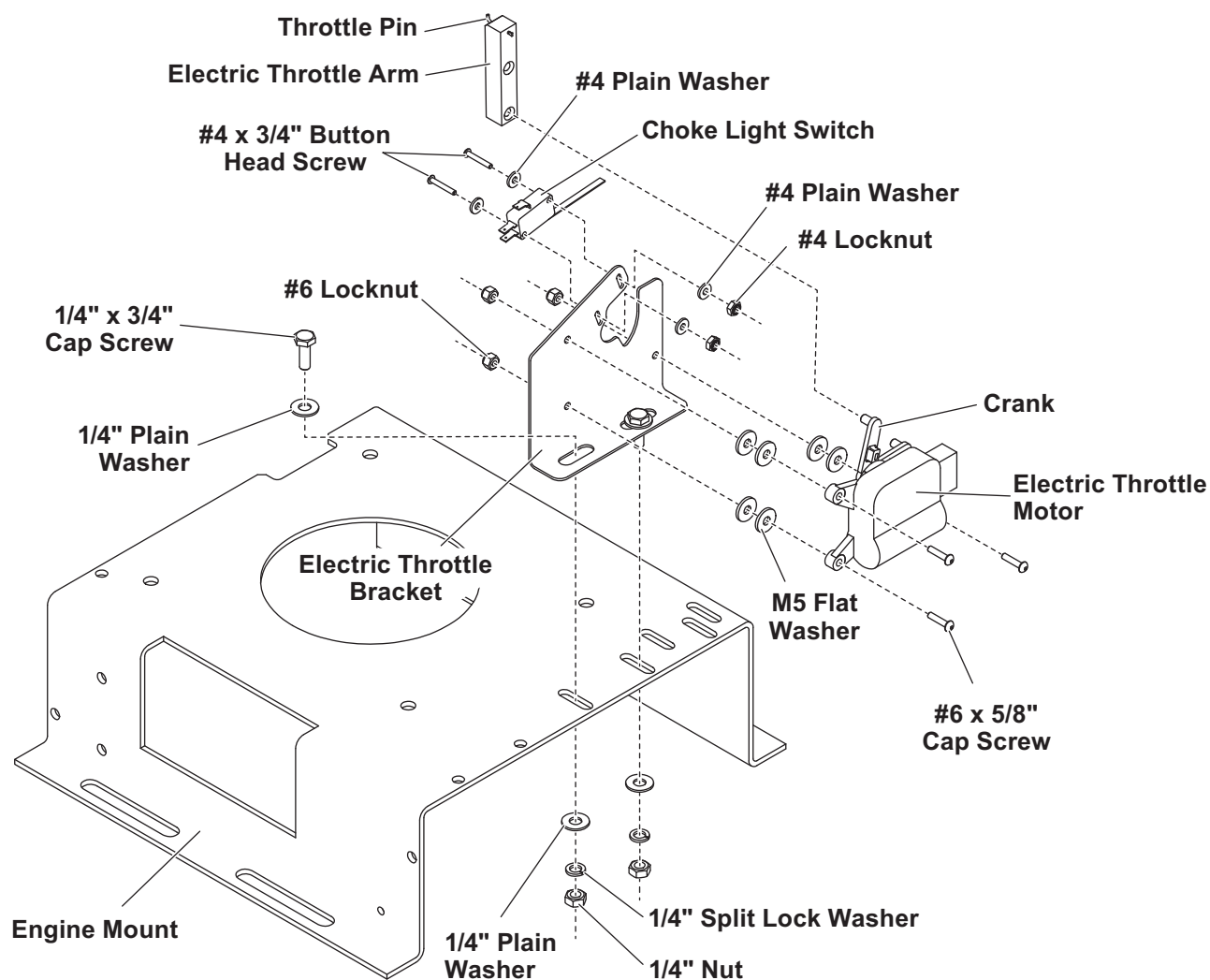

⚠ CAUTION

Use standard methods and practices when attaching spreader and installing accessories, including proper personal protective safety equipment.

Removal Instructions

CAUTION

Improper installation can result in damage to the engine choke/throttle linkage.

1. Disconnect the battery cables.
2. Carefully observe the existing installation. Mark the electric throttle position on the engine mount.
3. Disconnect the brown and red spreader harness wires from the electric throttle motor leads.
4. Remove the 1/4" fasteners that hold the electric throttle bracket to the engine mount.
5. Remove the #6 fasteners holding the electric throttle motor to the bracket and retain for reinstallation. Remove and retain the electric throttle motor and choke light switch.
3. Connect the two green wires to the normally open (NO) and common (COMM) terminals on the choke light switch. Attach the choke light switch to the bracket using the existing hardware.
4. Fasten the electric throttle motor to the bracket using the existing hardware (#6 fasteners), adding 2 of the supplied M5 flat washers between motor and bracket at each mounting location.
5. Place the electric throttle arm (with hole at end of arm) on the crank as shown in the page 1 illustration.
6. Place the electric throttle assembly onto the engine mount, inserting the throttle pin into the engine choke/throttle linkage.
7. Loosely fasten the electric throttle assembly to the engine mount with the existing hardware (1/4" fasteners).
8. Slide the bracket to the rear so it causes no interference with the hopper feed gate.

Installation Instructions

1. Connect the brown and red spreader harness wires (not shown) to the corresponding colored electric throttle motor leads.
2. Using the electric throttle control, run the new motor until the crank reaches the 3 o'clock position. (A 9-volt battery can be used as a substitute for the control.)
9. Tighten the bracket fasteners to 6 ft-lb.
10. Reconnect the battery cables.
11. Operate the electric throttle control until the choke is closed. Adjust the choke light switch until the choke light comes on.

The company reserves the right under its product improvement policy to change construction or design details and furnish equipment when so altered without reference to illustrations or specifications used. This equipment manufacturer or the vehicle manufacturer may require or recommend optional equipment for spreaders. Do not exceed vehicle ratings with a spreader. The company offers a limited warranty for all spreaders and accessories. See separately printed page for this important information.

Printed in U.S.A.