

# Primary Work Light Kit

## Stainless Steel Hopper Spreaders

### PARTS LIST

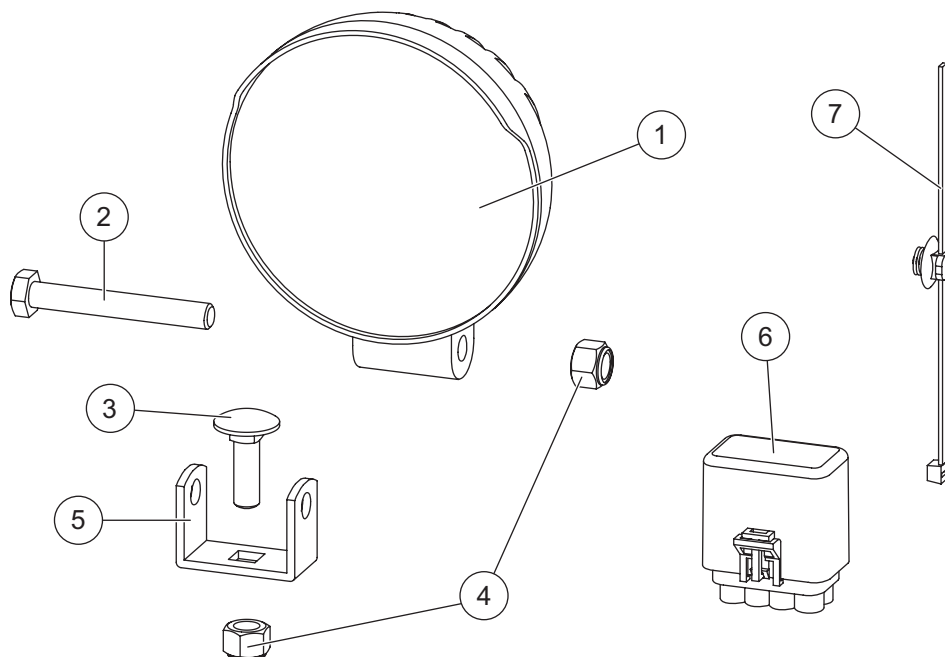

99505 Primary Work Light Kit							
Item	Part	Qty	Description	Item	Part	Qty	Description
1	78377	1	LED Work Light	6	78381	1	Harness & Relay/Fuse Assembly*
2		1	5/16-18 x 2 Hex Cap Screw	ns	78386	1	Harness Assembly – 72"
3		1	5/16-18 x 1.25 Carriage Bolt	7		4	Fir Tree Mount w/Cable Tie
4		2	5/16-18 Locknut	ns		6	Cable Tie – 15"
5		1	Mounting Clip				

ns = not shown

\* Diagram shows Relay/Fuse Assembly only.

#### **⚠ WARNING**

Do not exceed GVWR or GAWR ratings as found on the driver-side vehicle door cornerpost.

#### **⚠ CAUTION**

Use standard methods and practices when attaching spreader and installing accessories, including proper personal protective safety equipment.

#### **⚠ CAUTION**

Read this document before installing the primary work light.

## INSTALLATION INSTRUCTIONS

**Gas Spreader:** The Accessory Bracket and Harness Kit must be installed before the work light can be installed.

**Hydraulic Spreader:** The Accessory Enclosure and Harness Kit must be installed before the work light can be installed.

**Electric Spreader:** The primary work light relay/fuse assembly will be installed to the existing electrical enclosure.

1. Park the vehicle on a smooth, level, hard surface, such as concrete. Turn the vehicle ignition to the "OFF" position and remove the key.
2. The illustration shows the work light being mounted to a previously installed strobe light bracket. The work light can be installed in a different location by drilling a 13/32" hole for installing the work light mounting clip. Install the mounting clip in the desired location using the supplied 5/16" x 1.25" carriage bolt and 5/16" locknut.

3. Install the work light to the mounting clip using the 5/16" x 2" cap screw and 5/16" locknut, but do not yet fully tighten the fasteners.

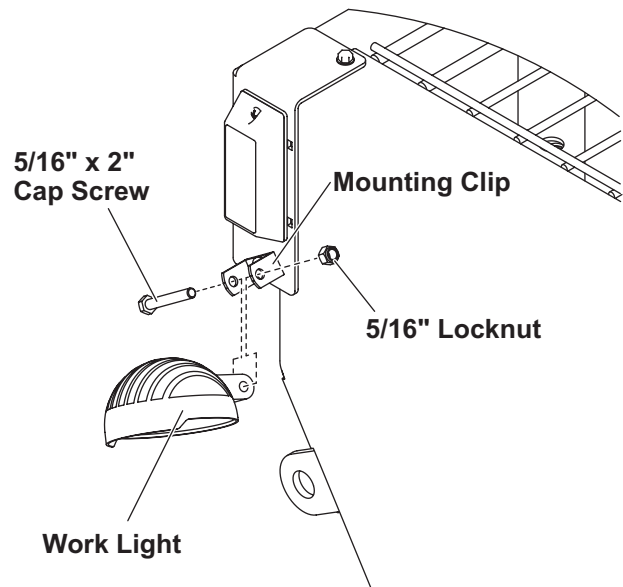

4. Aim the light in the desired direction, then fully tighten the locknut.
5. Plug the work light harness into the matching connector on the work light.
6. **If the work light is being mounted on an existing strobe light bracket,** secure the work light harness to the strobe light harness using supplied cable ties.

**If the work light harness will not be secured to an existing strobe light bracket,** the fir tree mounts will be used to secure the harness between the light and the electrical enclosure. Drill 1/4" holes in the desired locations for attaching the fir tree mounts. Push the fir tree mounts into the holes and secure the work light harness to the hopper with the attached cable ties.

7. **Electric/Hydraulic Spreader:** Cut a hole in one of the break-through plugs and feed the harness into the enclosure. The hole should be sized to form a tight seal around the harness.

**Gas Spreader:** Route the harness into the engine compartment on the right side, just forward of the engine mounting plate, in such a way that the engine hood does not pinch the harness when it is closed.

#### Electric Spreader

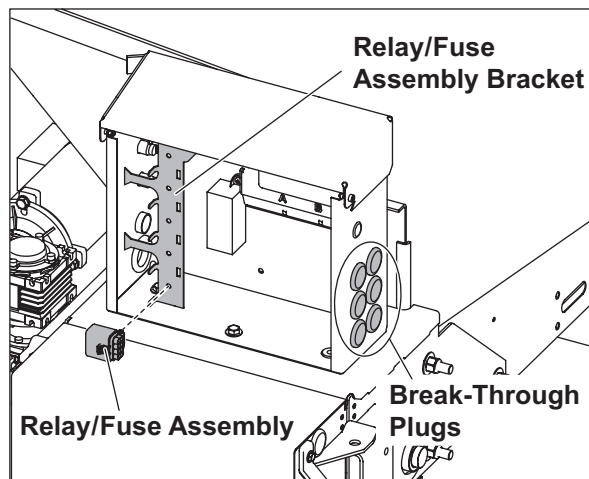

#### Hydraulic Spreader

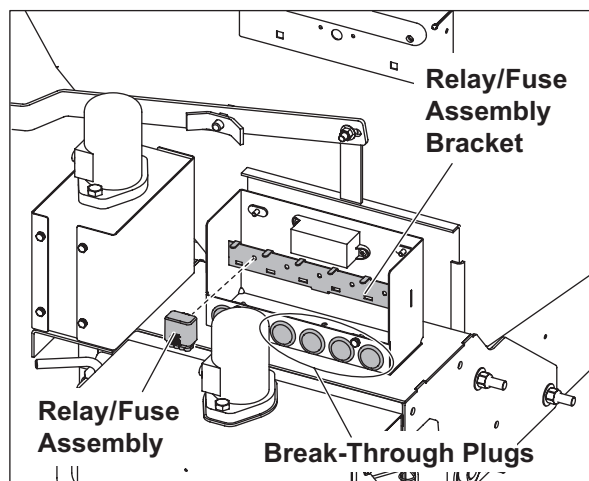

8. Mount the relay/fuse assembly to the relay/fuse assembly bracket by pushing the connector clip on the back of the assembly into one of the holes in the bracket. Secure the assembly to the bracket using one of the supplied cable ties.
9. Plug the 10-pin connector on the relay/fuse harness into the relay/fuse assembly.
10. Plug the work light harness connector into one of the matching connectors on the relay/fuse assembly harness. (The second relay/fuse harness connector is for the optional auxiliary work light.)

#### Gas Spreader

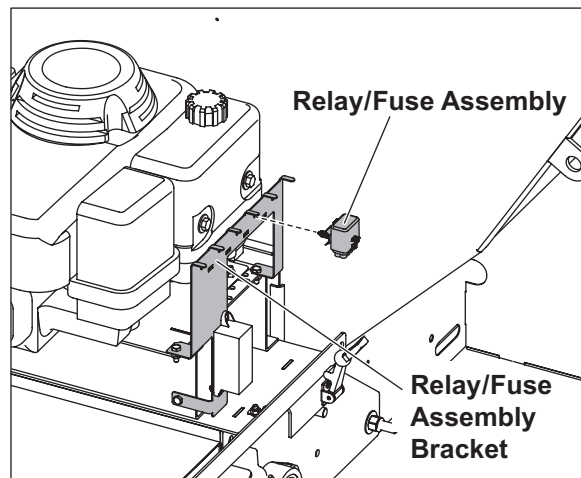

[Electrical enclosure covers not shown.]

11. Remove the cover from the isolated stud block. Connect the red wire from the relay/fuse assembly to the positive terminal and the black wire from the relay/fuse assembly to the negative terminal inside the isolated stud block. Replace the cover, being careful not to pinch any wires.

12. **Electric Spreader:** Connect the single-pin terminal on the relay/fuse assembly harness (yellow wire) to the gray wire coming from port A of the spreader module.

**Gas/Hydraulic Spreader:** Connect the single-pin terminal on the relay/fuse assembly harness (yellow wire) to the gray wire coming from the hopper accessory cable assembly.

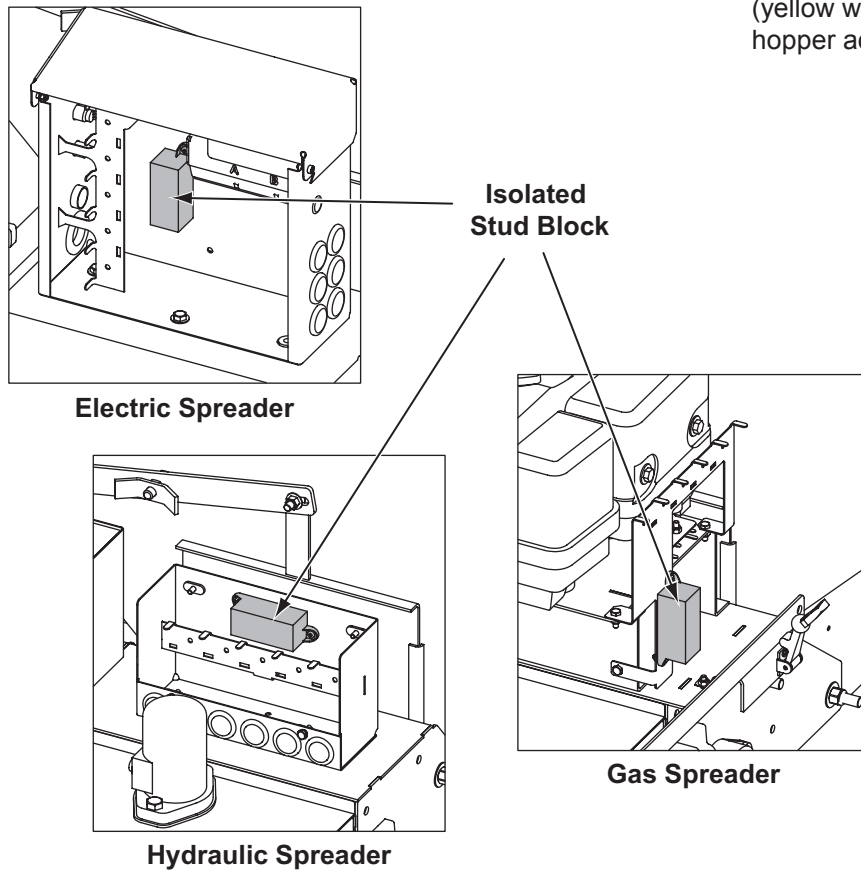

Copyright ©2015 Douglas Dynamics, LLC. All rights reserved. This material may not be reproduced or copied, in whole or in part, in any printed, mechanical, electronic, film or other distribution and storage media, without the written consent of the company. Authorization to photocopy items for internal or personal use by the company's outlets or spreader owner is granted.

The company reserves the right under its product improvement policy to change construction or design details and furnish equipment when so altered without reference to illustrations or specifications used. This equipment manufacturer or the vehicle manufacturer may require or recommend optional equipment for spreaders. Do not exceed vehicle ratings with a spreader. The company offers a limited warranty for all spreaders and accessories. See separately printed page for this important information.

Printed in U.S.A.