

⚠ CAUTION

Read instructions before performing modifications. Use standard methods and practices when working on spreader including wearing proper personal protective safety equipment.

95457 Model 500 Screen Kit

Item	Part	Qty	Description
1	95460	1	Model 500 Screen
ns	95605	1	Parts Bag
95605 Parts Bag			
2	95606	2	Mounting Tab
3	90381	2	1/4-20 x 3/4 Hex Cap Screw
4	91013	2	1/4 Flat Washer
5	67076	2	1/4-20 Hex Locknut
ns = not shown			

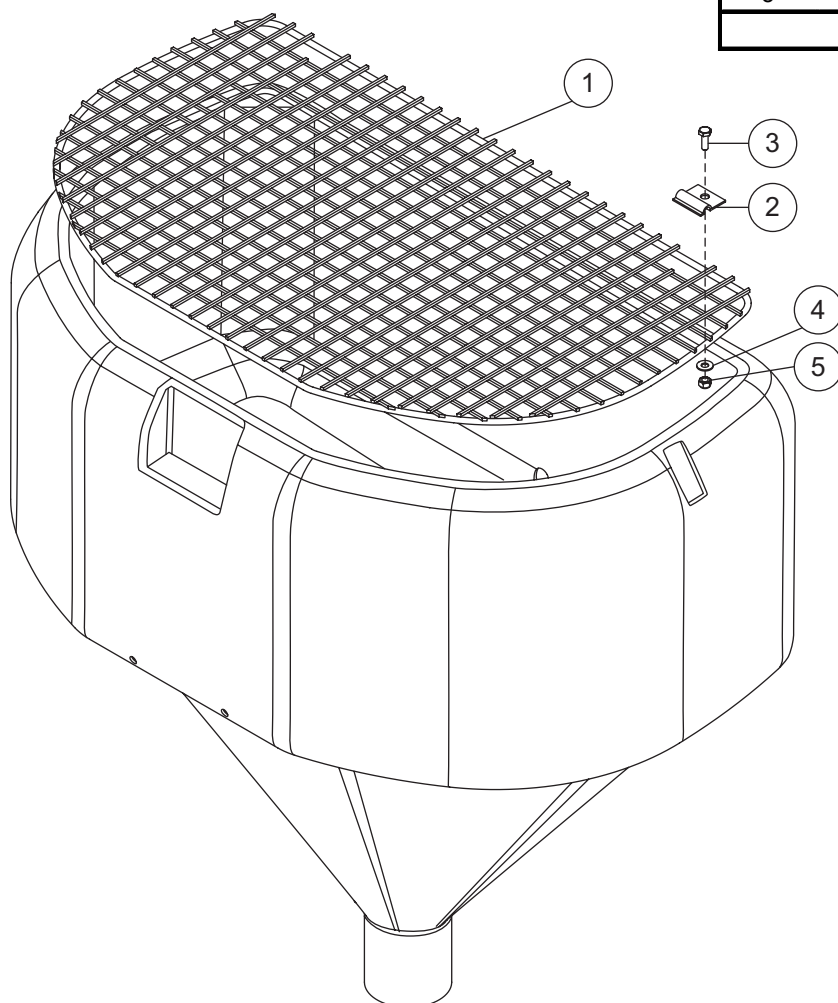

1. Remove the hopper lid. Place the screen on the spreader and make sure that the screen is centered in all directions.
2. Place the mounting tab over the screen frame in the area with no screen.
3. Mark the holes on the tub and remove the screen and mounting tabs.
4. Drill the holes with a 1/4" drill bit.
5. Place the screen and mounting tabs back on the spreader and secure them with the supplied 1/4" hardware, making sure the washer is inside the spreader.

Copyright© 2003 Douglas Dynamics, L.L.C. All rights reserved. This material may not be reproduced or copied, in whole or in part, in any printed, mechanical, electronic, film or other distribution and storage media, without the written consent of the company. Authorization to photocopy items for internal or personal use by the company's outlets or spreader owner is granted.

The company reserves the right under its product improvement policy to change construction or design details and furnish equipment when so altered without reference to illustrations or specifications used. Do not exceed vehicle ratings with a spreader. The company offers a limited warranty for all spreaders and accessories. See separately printed page for this important information.