

PARTS LIST

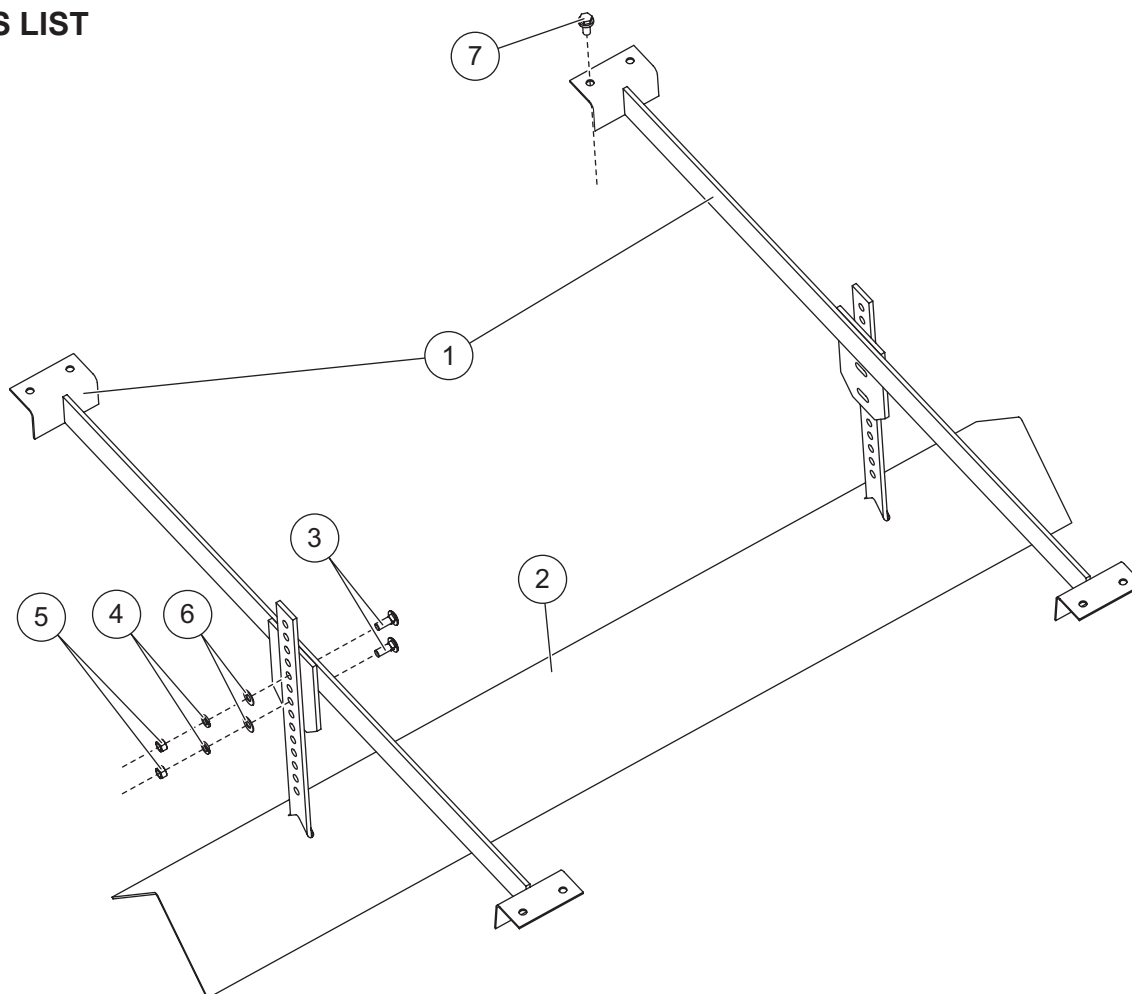

95970 Poly Hopper Inverted Vee Kit							
Item	Part	Qty	Description	Item	Part	Qty	Description
1	95968	2	Hanger	ns	95998	1	Parts Bag
2	95017	1	Inverted Vee				
95998 Parts Bag							
3	90375	4	3/8-16 x 1 Carriage Bolt	6	91123	4	3/8 Flat Washer Wide SS
4	91282	4	3/8 Lock Washer SS	7	96375	8	3/8 x 1 Sheet Metal Screw
5	91431	4	3/8-16 Hex Nut SS				
ns = not shown				SS = Stainless Steel			

⚠ CAUTION

Read this document before installing the inverted vee kit.

⚠ CAUTION

Use standard methods and practices when attaching spreader and installing accessories including proper personal protective safety equipment.

INSTALLATION INSTRUCTIONS

1. Measure 9.5" from the center of the top screen brace fastener to the front (away from the drive) of the hopper. Mark this distance on the hopper shelf.

Measure 21.5" from the center of the top screen brace fastener to the rear (toward the drive) of the hopper. Mark this distance on the hopper shelf.

Repeat on the other side of the hopper.

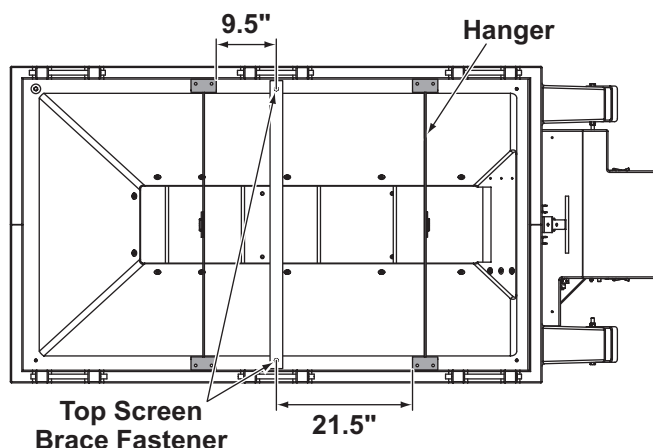

2. Position the hangers on the hopper. Align the inside (nearest the center) edge of each hanger with the mark on the hopper shelf. Using the holes in the hangers as guides, drill a 21/64" hole through the hopper shelf.

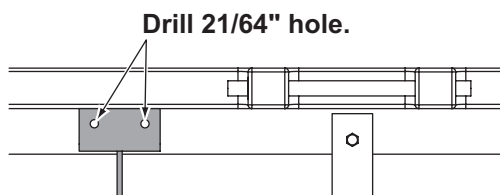

3. Remove the hangers and place the inverted vee in the hopper. Replace the hangers and secure them to the hopper with 3/8" x 1" sheet metal screws. Do not overtighten the screws. Tighten only until the screw head is snug with the hanger bracket.

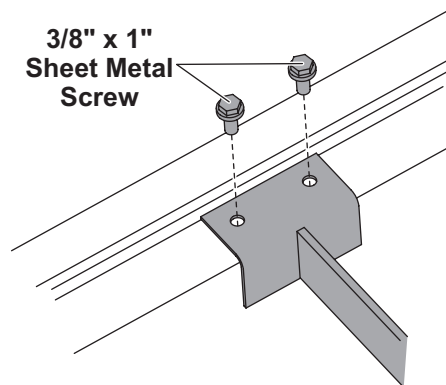

4. Assemble the inverted vee adjustment bars to the hangers as shown below, with the top hanger bolt going through the fifth hole in the adjustment bar. This is an initial inverted vee height adjustment. Final adjustment height will depend on the type of material being spread.

If the inverted vee needs to be adjusted higher than this, the adjustment bars may need to be shortened to avoid interfering with the closed lids. Torque 3/8" carriage bolts to 31 ft-lb.

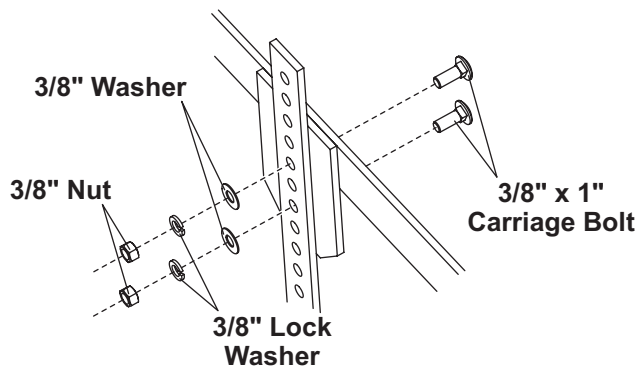

Copyright © 2007 Douglas Dynamics, L.L.C. All rights reserved. This material may not be reproduced or copied, in whole or in part, in any printed, mechanical, electronic, film or other distribution and storage media, without the written consent of the company. Authorization to photocopy items for internal or personal use by the company's outlets or snowplow owner is granted.

The company reserves the right under its product improvement policy to change construction or design details and furnish equipment when so altered without reference to illustrations or specifications used. This equipment manufacturer or the vehicle manufacturer may require or recommend optional equipment for snow removal. Do not exceed vehicle ratings with a snowplow. The company offers a limited warranty for all snowplows and accessories. See separately printed page for this important information.