



Fisher Engineering

P.O. Box 529 Rockland, Maine 04841

A5795

A5929

Single Lever Control Series HS, G, HC

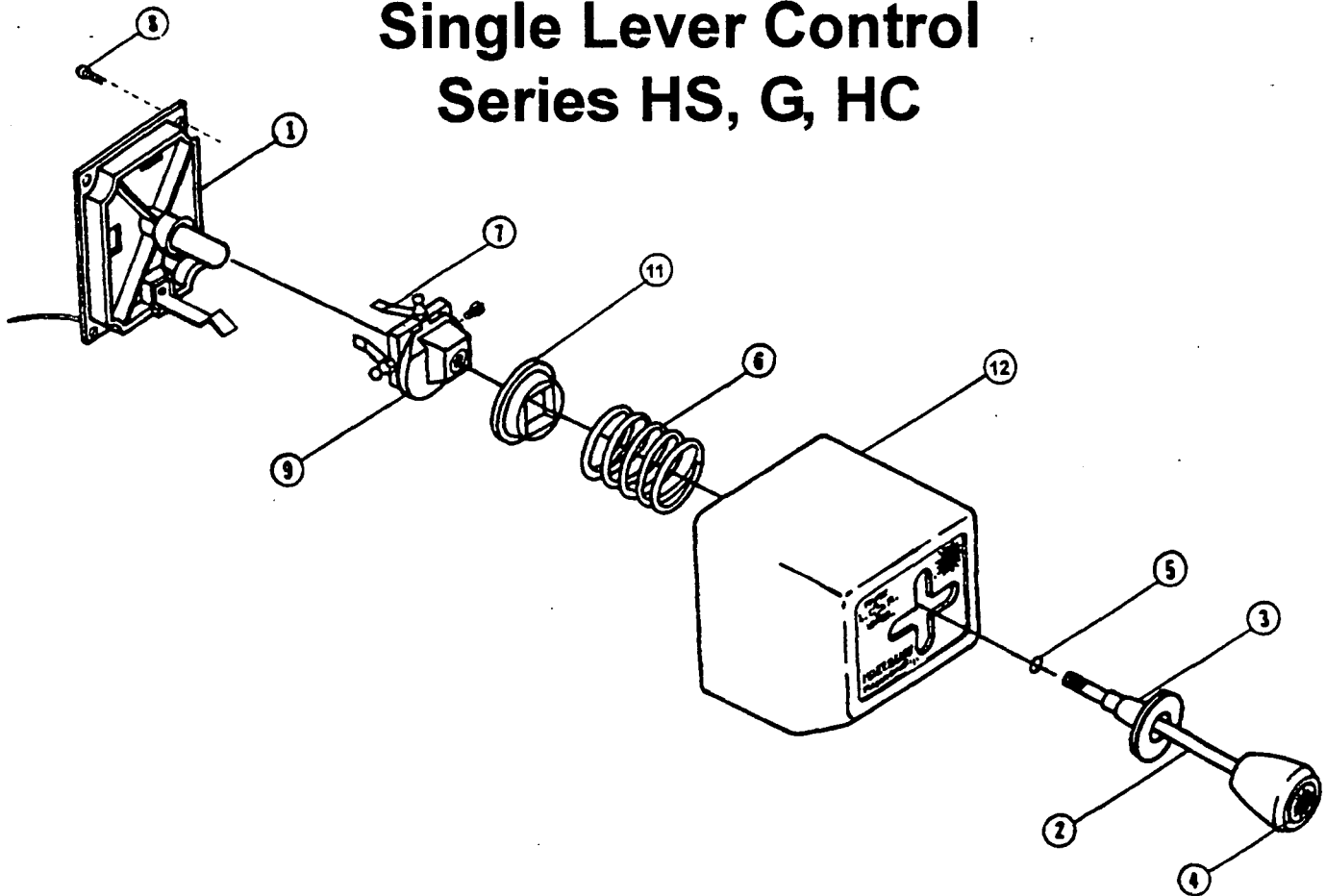

A5795 – Single Lever Control Assembly w/ 108" Cables				A5929 – Single Lever Control Assembly w/ 90" Cables			
Ref #	Part #	Qty	Description	Ref #	Part #	Qty	Description
1	A5841	1	Bottom Cover Assembly	1	A5841	1	Bottom Cover Assembly
2	A5842	1	Knob & Lever Assembly w/ O-ring	2	A5842	1	Knob & Lever Assembly w/ O-ring
3	5857	1	Lock Spool w/ Label	3	5857	1	Lock Spool w/ Label
4	6528	1	Lens Label	4	6528	1	Lens Label
5	5833	1	O-ring – 008	5	5833	1	O-ring – 008
6	6065	1	Centering Spring	6	6065	1	Centering Spring
7	6064	1	Contact Strip	7	6064	1	Contact Strip
8	5800	8	Hex Head Thread-Forming Screw – #8 x 5/8" HI-LO	8	5800	8	Hex Head Thread-Forming Screw – #8 x 5/8" HI-LO
9	6584	1	Platen Assembly	9	6584	1	Platen Assembly
ns	A5843	1	Cable w/ Clip & O-ring (108")	ns	A5931	1	Cable w/ Clip & O-ring (90")
	A5844	1	Cable w/ Clip & O-ring (Adj. 108")		A5930	1	Cable w/ Clip & O-ring (Adj. 90")
ns	7085	1	O-ring – 010	ns	7985	1	O-ring – 010
11	56023	1	Spring Retainer	11	56023	1	Spring Retainer
12	26604	1	Body w/ Label	12	26604	1	Body w/ Label

ns = not shown

A5795

A5929

Copyright © 1999 Douglas Dynamics, L.L.C. All rights reserved. This material may not be reproduced or copied, in whole or in part, in any printed, mechanical, electronic, film or other distribution and storage media, without the written consent of Fisher Engineering. Authorization to photocopy items for internal or personal use by Fisher Engineering outlets is granted.

Fisher Engineering reserves the right under its product improvement policy to change construction or design details and furnish equipment when so altered without reference to illustrations or specifications used herein. Fisher Engineering and the vehicle manufacturer may require and/or recommend optional equipment for snow removal. Fisher Engineering offers a limited warranty for all snowplows and accessories. See separately printed page for this important information. The following are registered (®) trademarks of Douglas Dynamics, L.L.C.: FISHER®

Printed in USA
