



NOTE: Use these instructions for straight-blade and EZ-V® snowplows.

RELIEF VALVE REPAIR KIT – 2 SETS

Installation Instructions

⚠ WARNING

The driver shall keep bystanders clear of the blade when it is being raised, lowered or angled. Do not stand between the vehicle and the blade or within 8 feet of a moving blade. A moving or falling blade could cause personal injury.

INSTALLATION AND ADJUSTMENT

1. Park the vehicle on a smooth, level, hard surface, such as concrete. Lower the blade to the ground, and turn the control to the "OFF" position. Disconnect the snowplow from the vehicle, or turn the vehicle ignition to the "OFF" position and remove the key.
2. If pressure is trapped in the hydraulic system, remove it by disconnecting the brown/red wire from the motor relay and operating the control in all positions with the power ON.
3. Oil O-ring, assemble parts as shown and tighten relief (cushion) valve stems until spring is fully compressed.

Relief Valve Assembly
Order for All Cavities

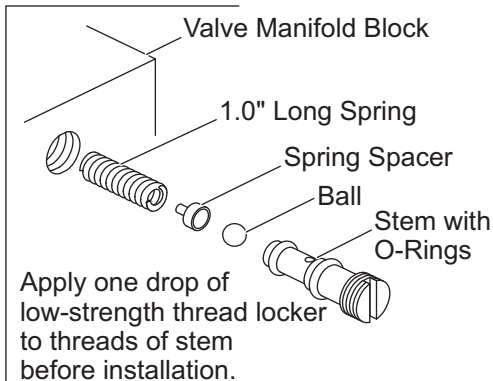

4. Back off valve stem (rotate counterclockwise) the number of turns indicated in the following chart for your particular type of hydraulic unit.

For Straight Blade Insta-Act® Hydraulic Unit:

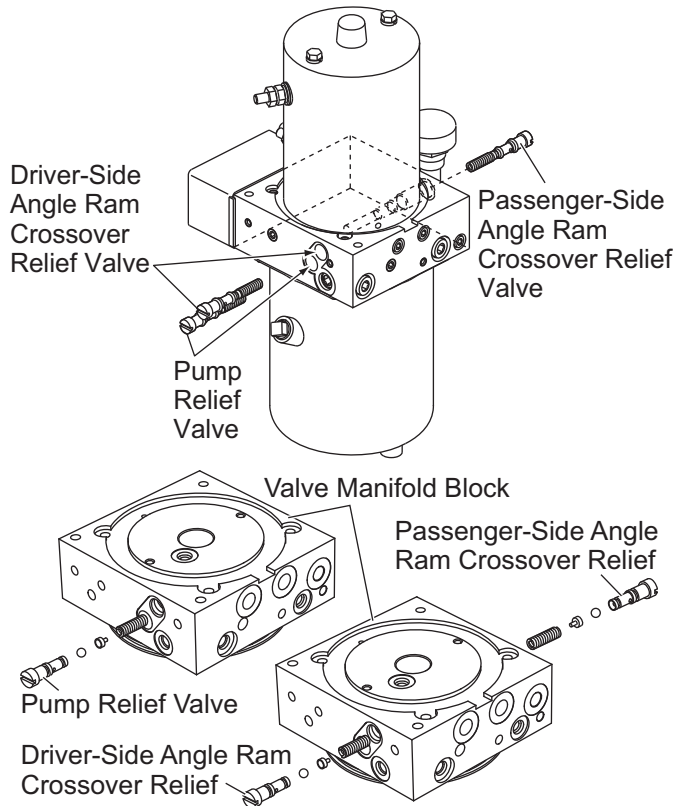

Relief Valve	No. of Turns Off (CCW) from Fully Seated	Approximate Relief Valve Pressure (PSI)
Pump Relief	2-1/2 – 2-3/4	1750*
DS or PS Angle Ram Crossover Relief:		
RD/HD Snowplows	1 – 1-1/4	4000
LD/MC Snowplows	2-1/4 – 2-1/2	2500

* Install a tee in line with the passenger-side hydraulic hose and attach a 3000 psi gauge. Read the pressure at pump relief when holding the angle left function button. Adjust pump relief valve to obtain 1750 ± 50 psi. Relieve pressure before adjusting.

For EZ-V® Insta-Act® Hydraulic Unit:

NOTE: Secondary manifolds with E2 markings must use 66796 Relief Valve Repair Kit in the left and right secondary relief valve cavities.

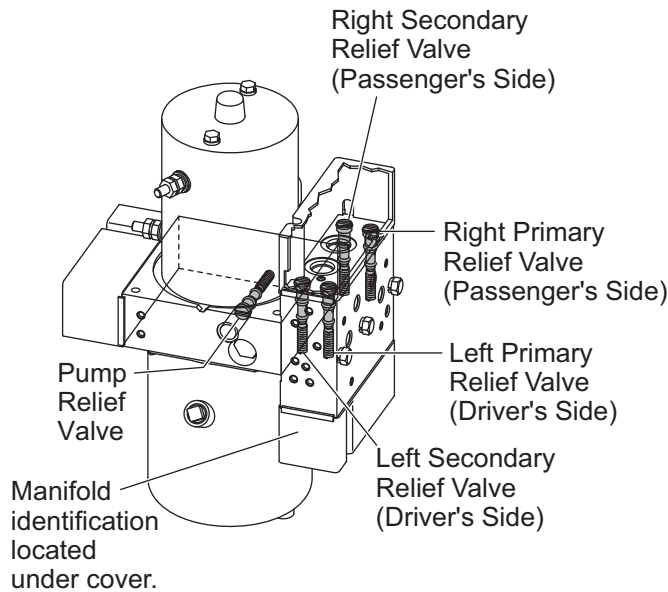

Relief Valve	No. of Turns Off (CCW) from Fully Seated	Approximate Relief Valve Pressure (PSI)
Pump Relief	2-1/2 – 2-3/4	1750*
Right or Left Ram Primary Relief	1-1/4 – 1-1/2**	3500
Right or Left Ram Secondary Relief	1 – 1-1/4**	4000

* Install a tee in line with the passenger-side rod-end hydraulic hose and attach a 3000 psi gauge. Read the pressure at pump relief when holding the right retract function button. Adjust pump relief valve to obtain 1750 ± 50 psi. Relieve pressure before adjusting.

** Be certain the ram primary relief valve stem is backed out 1/4 turn farther than the secondary relief valve stem.

For Solenoid (SEHP) and Cable-Operated (EHP) Electric Hydraulic Units:

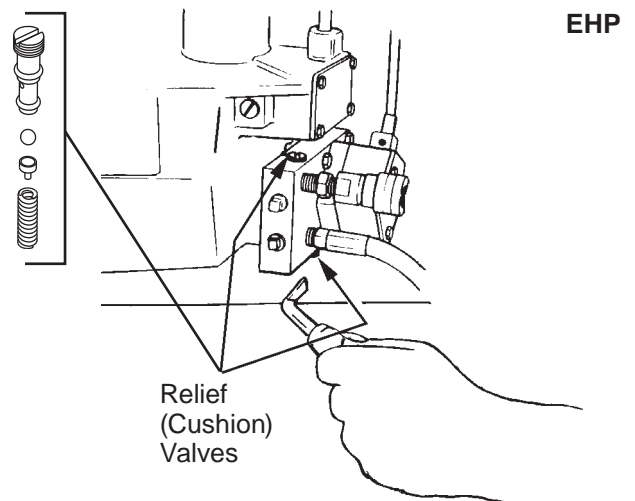
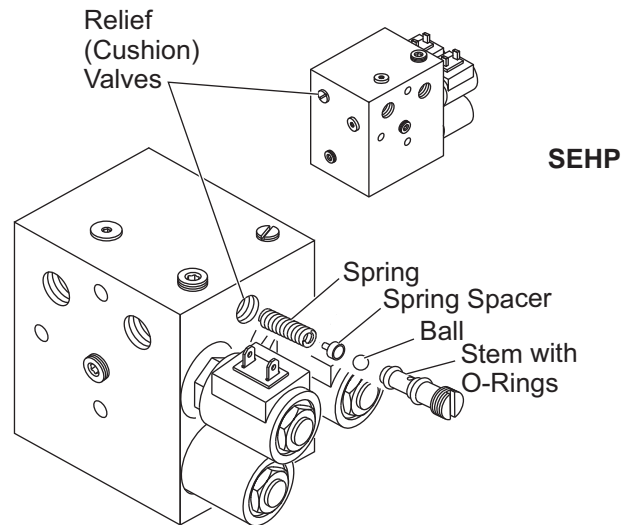

Ram Stroke		No. of Turns Off (CCW) from Fully Seated	Approximate Relief Valve Pressure (psi)
Lift	Angle		
6"	10"	1-3/4	2500
10"	12"	1-1/4	4000
6 or 10"	16"	1-3/4	2500

Fisher Engineering reserves the right under its product improvement policy to change construction or design details and furnish equipment when so altered without reference to illustrations or specifications used. Fisher Engineering or the vehicle manufacturer may require or recommend optional equipment for snow removal. Do not exceed vehicle ratings with a snowplow. Fisher Engineering offers a limited warranty for all snowplows and accessories. See separately printed page for this important information. The following are registered (®) trademarks of Douglas Dynamics, L.L.C.: EZ-V®, FISHER®, Insta-Act®.