



Fisher Engineering

P.O. Box 529, Rockland, ME 04841

21619

September 25, 1997

No. 21894



RUBBER DEFLECTOR INSTALLATION

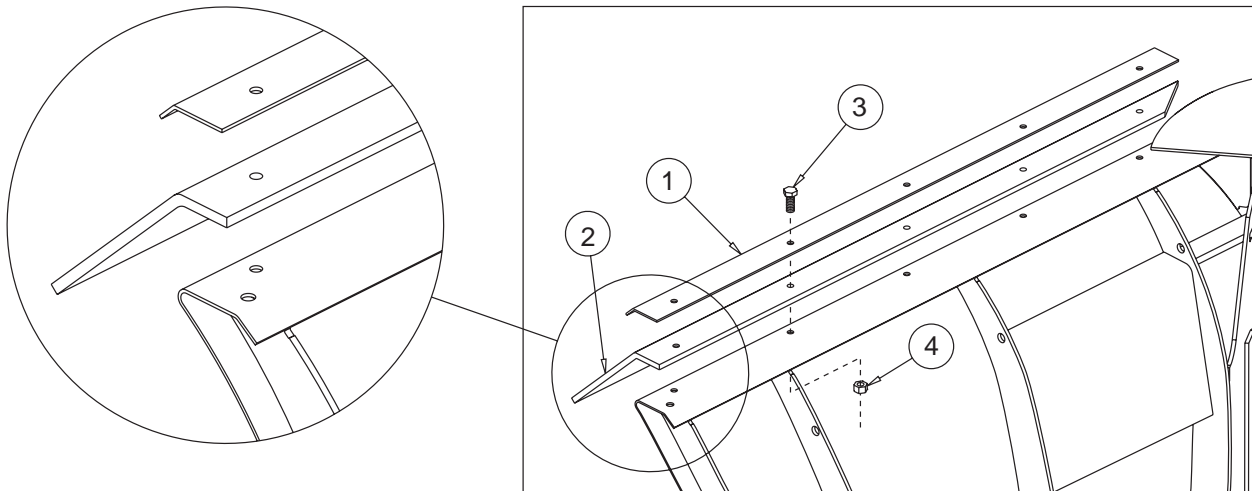

1. Install the blade guides on the plow wings.
2. Place the rubber deflector with the logo on the driver-side plow wing. The deflector should be parallel with the wing with the logo facing up. The cropped portion of the deflector should be toward the middle of the wing.
3. Place the bolting bar on top of the deflector. Align the holes in the deflector with the holes in the bolting bar. Clamp the rubber deflector and bolting bar to the wing.
4. Drill five 13/32" holes through the wing. Use the holes in the bolting bar as a guide.
5. Fasten the rubber deflector and bolting bar to the wing with a 3/8 x 1-1/4" cap screw and 3/8" locknut in each hole.
6. Repeat this for the passenger-side wing.

Parts List			
Ref #	Part #	Qty	Description
1	21618	2	Bolting Bar
2	21769	1	Rubber Deflector w/ Logo—DS
3	90106	10	3/8-16 x 1-1/4" Gr. 5 Cap Screw
4	90352	10	3/8" Locknut
ns	62613	1	Rubber Deflector—PS
ns = not shown			

DIAMETER- THREADS PER INCH	NC FASTENER TORQUE (FT-LB)		
	GRADE		
	⬡ G2	⬢ G5	⬠ G8
1/4 - 20	6	9	13
5/16 - 18	11	18	28
3/8 - 16	19	31	46
7/16 - 14	30	50	75
1/2 - 13	45	75	115
9/16 - 12	66	110	165
5/8 - 11	93	150	225
3/4 - 10	150	250	370
7/8 - 9	150	378	591
1 - 8	220	583	893

Fisher Engineering reserves the right under its product improvement policy to change construction or design details and furnish equipment when so altered without reference to illustrations or specifications used herein. Fisher Engineering and the vehicle manufacturer may require and/or recommend optional equipment for snow removal. Fisher Engineering offers a one-year limited warranty on all snowplows and accessories. See separately printed page for this important information. The following are registered (®) and unregistered (™) trademarks of Douglas Dynamics, L.L.C.: FISHER®, EZ-V™

Printed in USA