



Snowplow Lighting Installation Instructions

Table of Contents

Safety **2**
Installation Instructions **3**
Headlamp Beam Aiming **4**

SAFETY INFORMATION

⚠ WARNING

Indicates a potentially hazardous situation that, if not avoided, could result in death or serious personal injury .

⚠ CAUTION

Indicates a situation that, if not avoided, could result in minor personal injury and/or damage to product or property.

NOTE: Identifies tips, helpful hints and maintenance information the owner/operator should know.

Torque all fasteners according to the torque chart. For proper fit, do not tighten fasteners until instructed to do so.

DIAMETER- THREADS PER INCH	NC FASTENER TORQUE (FT-LB)		
	GRADE		
	G2	G5	G8
1/4 - 20	6	9	13
5/16 - 18	11	18	28
3/8 - 16	19	31	46
7/16 - 14	30	50	75
1/2 - 13	45	75	115
9/16 - 12	66	110	165
5/8 - 11	93	150	225
3/4 - 10	150	250	370
7/8 - 9	150	378	591
1 - 8	220	583	893

INSTALLATION INSTRUCTIONS

⚠ WARNING
Your vehicle must be equipped with snowplow headlights and directional lights.

1. Slide a headlamp swivel onto the stem of the screw on the underside of the driver side headlamp assembly. The park/turn lamp should be to the outside of the headlamp.
2. Fit through the hole nearest the end in the top of the headgear on the driver side. Secure with a locknut and washer.
3. Repeat steps 1 and 2 on the passenger side.
4. Route the snowplow lighting harness down the driver side headgear brace to match the vehicle harness plug.
5. Secure the snowplow lighting harness to the headgear using cable ties as needed.
6. If present, connect Black/Orange ground wire to the negative motor terminal.
7. Read, follow, and remove the headlamp label if one is present.
8. Plug snowplow lighting harness into the snowplow control harness for storage.

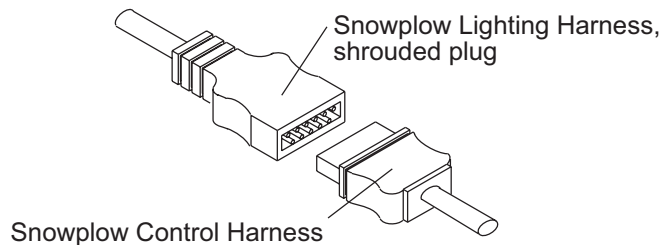
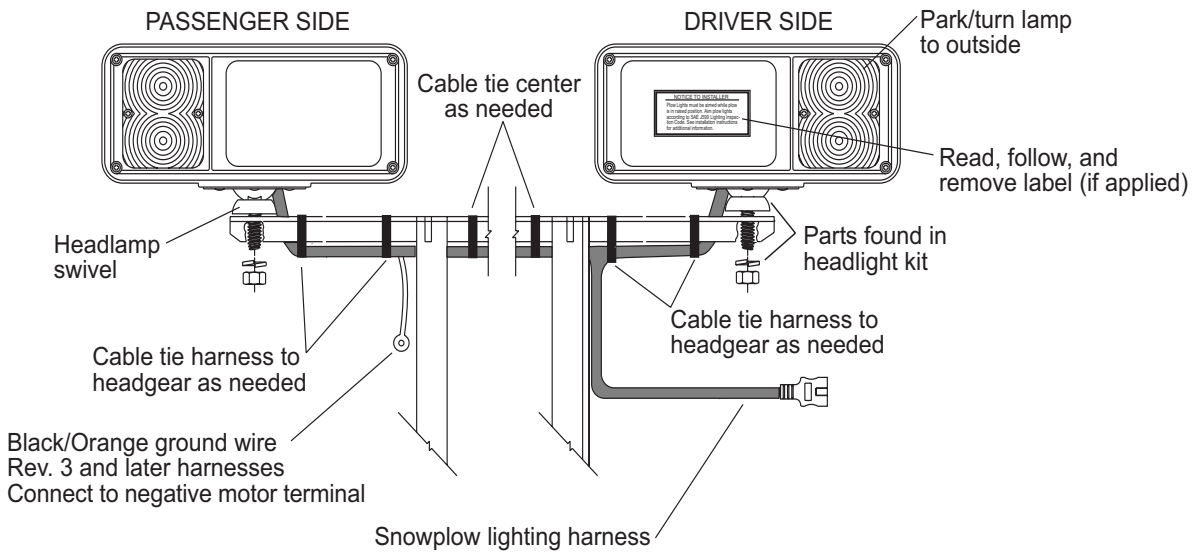

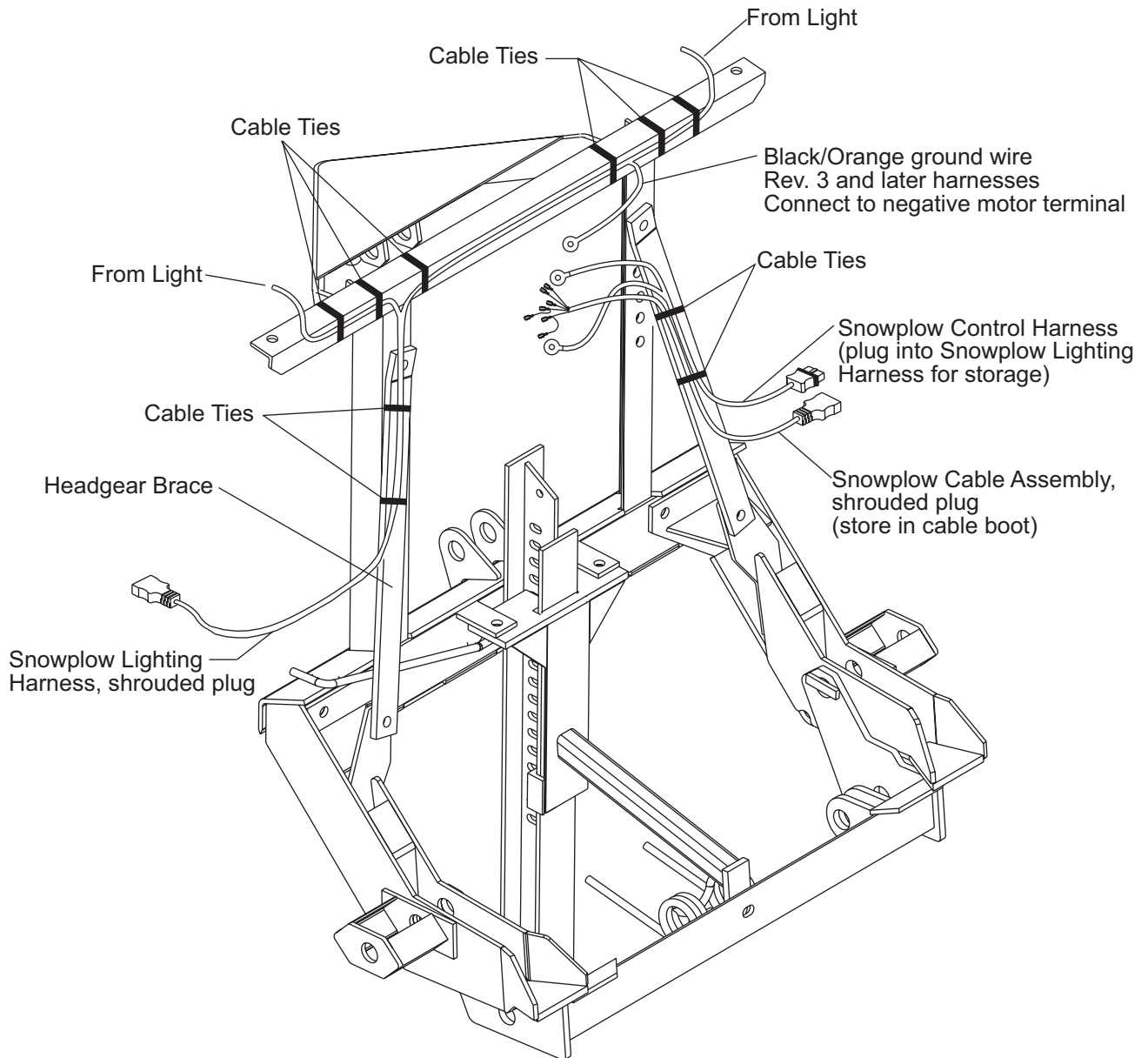

HEADLAMP BEAM AIMING

1. Place vehicle on a level surface 25 feet in front of a matte-white screen, such as a garage door. The screen should be perpendicular both to the ground and to the vehicle center line.
2. The vehicle should be equipped for normal operation, the snowplow blade should be in place and in raised position. Below are steps listed by the Society of Automotive Engineers (SAE) pertinent to headlamp aiming in specification #SAE J599d.
3. Prepare vehicle for headlamp aim or inspection. Before checking beam aim, the inspector will:
 - a. Remove ice or mud from under fenders.
 - b. Set tire inflation pressures to the values specified on vehicle information label.
 - c. Check springs for sag or broken leaves.
 - d. See that there is no load in the vehicle other than the driver and ballast as specified in the *Fisher® Snowplows Kit Selection Guide*.
 - e. Check functioning of any automatic vehicle leveling systems and specific manufacturer's instructions pertaining to vehicle preparation for headlamp aiming.
4. Mark (or tape) the vertical centerline of the headlamps and the vertical centerline of the vehicle on the screen. Mark the horizontal centerline of the headlamps on the screen (distance from ground to headlamp centers).
5. The correct visual aim for type 2 headlamps (snowplow headlamps are type 2; see number on face of sealed beam) is with the top edge of the high intensity zone of the lower beam below the horizontal centerline and the left edge of the high intensity zone on the vertical centerline. (Refer to diagram below.)

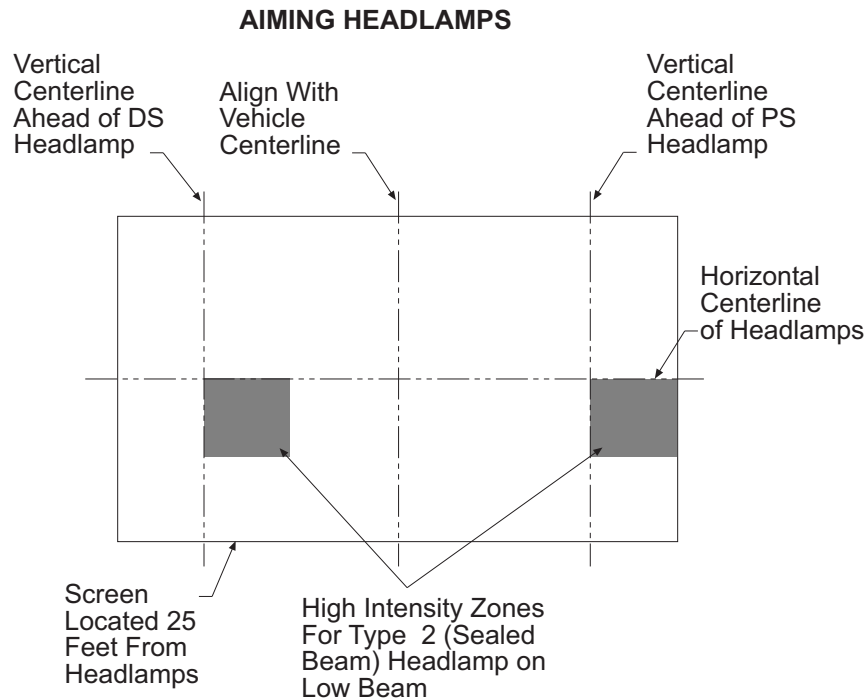

Fisher Engineering reserves the right under its product improvement policy to change construction or design details and furnish equipment when so altered without reference to illustrations or specifications used herein. Fisher Engineering and the vehicle manufacturer may require and/or recommend optional equipment for snow removal. Fisher Engineering offers a limited warranty for all snowplows and accessories. See separately printed page for this important information. The following are registered (®) trademarks of Douglas Dynamics, L.L.C.: FISHER®, Insta-Act®, Minute Mount®

dd A DIVISION OF DOUGLAS DYNAMICS, L.L.C.

Printed in USA