



**Fisher Engineering**

P.O. Box 529 Rockland, Maine 04841

**26634**

**V**

February 21, 2003

Lit. No. 26650



# Blade Stop Kit

## Parts List and Installation Instructions

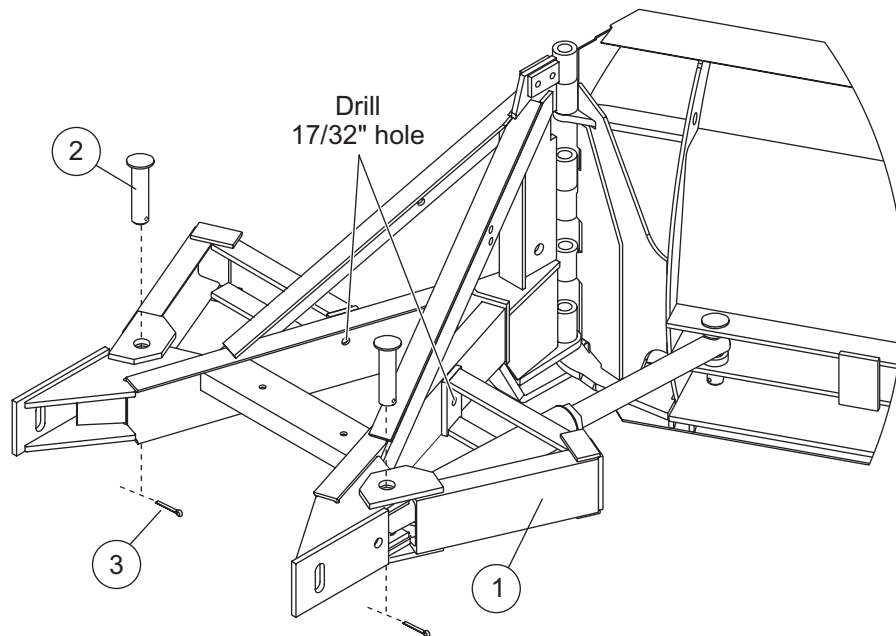



26634 EZ-V® Snowplow Blade Stop Kit							
Item	Part	Qty	Description	Item	Part	Qty	Description
1	26583	2	Blade Stop	ns	26651	1	Bolt Bag
26651 Bolt Bag							
2	6817	2	1 x 6 Pivot Pin	ns	90210	2	1/2-13 x 1-1/2 Hex Cap Screw G5
3	90013	2	1/4 x 2 Cotter Pin	ns	91335	2	1/2-13 Hex Locknut GB
ns = not shown				G = grade			

## TORQUE CHART

### CAUTION

Read instructions before assembling. Fasteners should be finger tight until instructed to tighten according to the torque chart. Use standard methods and practices when attaching snowplow, including wearing proper personal protective safety equipment.

Recommended Fastener Torque Chart (Ft.-Lb.)			
Size	 SAE Grade 2	 SAE Grade 5	 SAE Grade 8
1/4-20	6	9	13
5/16-18	11	18	28
3/8-16	19	31	46
3/8-24	24	46	68
7/16-14	30	50	75
1/2-13	45	75	115
9/16-12	66	110	165
5/8-11	93	150	225
3/4-10	150	250	370
7/8-9	150	378	591
1-8	220	583	893
Metric Grade 8.8 (Ft.-Lb.)			
Size	Torque	Size	Torque
M 6	7	M 12	60
M 8	17	M 14	95
M 10	35	M 16	155
These torque values apply to fasteners except those noted in the instruction.			

## INSTALLATION INSTRUCTIONS

- Temporarily install the blade stops on the A-frame with the 1" x 6" pivot pins included with the kit. Rotate the blade stop up against the A-frame channel iron and mark the location of the mounting hole that corresponds to the blade stop. Refer to illustration on previous page.
- Drill a 17/32" hole in the A-frame channel iron at the location determined in Step 1.
- Repeat the process for the opposite side.
- Position the angle rams, with fittings and hoses installed, in the blade stops as illustrated. The fittings will be toward the A-frame.
- Install the blade stops to the rear angle ram anchor holes with the 1" x 6" pivot pins and 1/4" x 2" cotter pins.
- Bolt the blade stops to the A-frame channel iron with 1/2" x 1-1/2" cap screws and locknuts.
- Torque all fasteners according to the chart above.

Copyright© 2003 Douglas Dynamics, L.L.C. All rights reserved. This material may be not reproduced or copied, in whole or in part, in any printed, mechanical, electronic, file or other distribution and storage media, without the written consent of Fisher Engineering. Authorization to photocopy items for internal or personal use by Fisher Engineering outlets or snowplow owner is granted.

Fisher Engineering reserves the right under its product improvement policy to change construction or design details and furnish equipment when so altered without reference to illustrations or specifications used. Fisher Engineering and the vehicle manufacturer may require and/or recommend optional equipment for snow removal. Do not exceed vehicle ratings with a snowplow. Fisher Engineering offers a limited warranty for all snowplows and accessories. See separately printed page for this important information. The following are registered (®) trademarks of Douglas Dynamics, L.L.C.: EZ-V® and FISHER®.