

Fisher Engineering

P.O. Box 529 Rockland, Maine 04841

September 1, 2005
Lit. No. 27055, Rev. 02



Attachment Kit

INTERNATIONAL

4700, 4800, 4900

1989 - 99

(Kit only fits vehicles equipped with 3 x 50" or 3 x 54" front springs.)

⚠ CAUTION

See your FISHER® outlet for application recommendations. The Kit Selection Guide has specific vehicle and snowplow requirements.

Table of Contents

Attachment Kit Assembly	2
Bolt Bag Parts List	2
Installation Instructions	3

7151-1 KIT PARTS LIST

7151-1 Attachment Kit					
Part #	Qty	Description	Part #	Qty	Description
27029	1	Pushplate – Driver Side	21333	1	Hanger – Passenger Side
21343	1	Pushplate – Passenger Side	21338	1	Commercial Connecting Beam
21332	1	Hanger – Driver Side	21350	1	Bolt Bag – 7151

PARTS LIST AND DIAGRAM

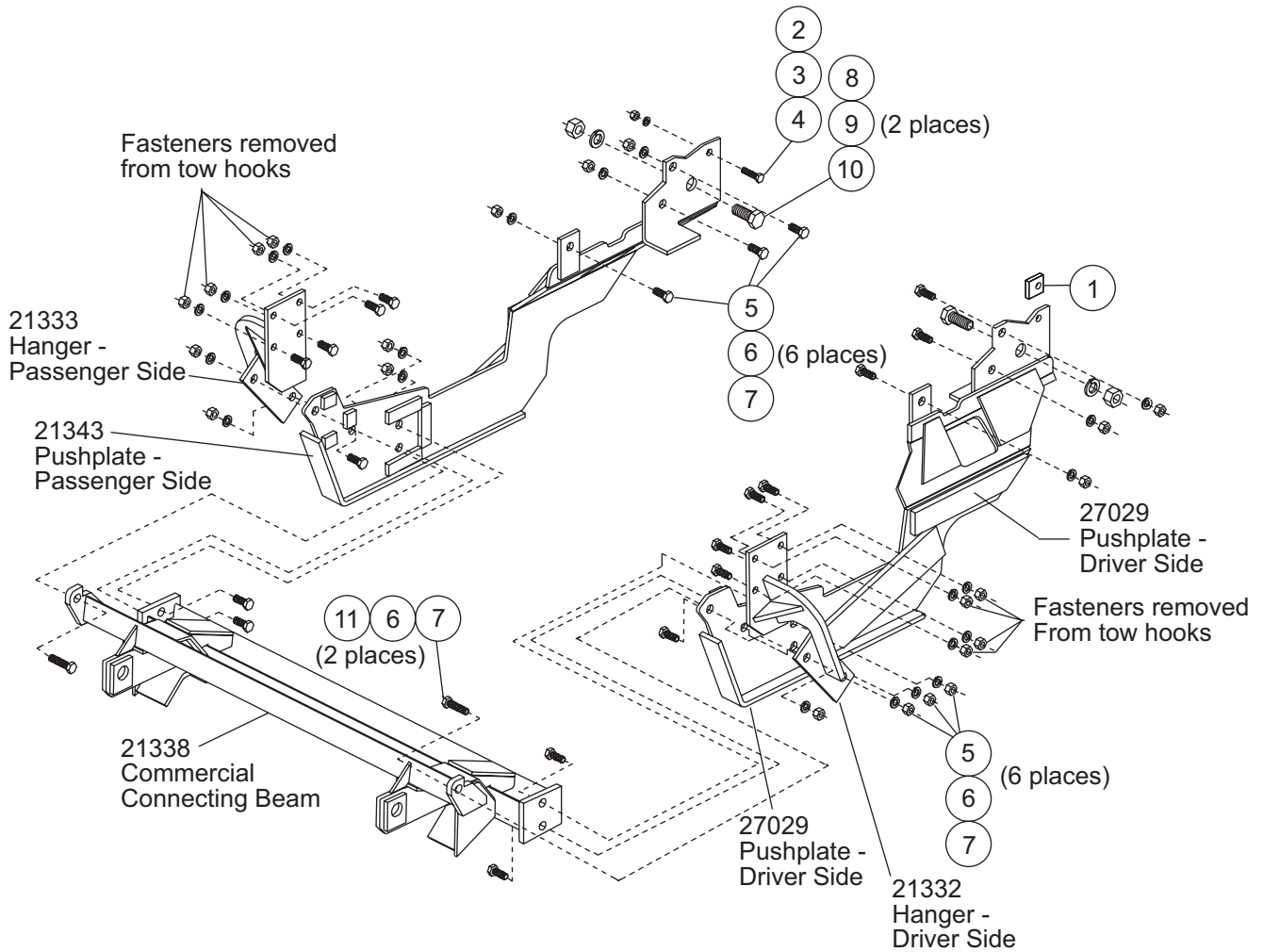

21350 Bolt Bag						
Ref #	Part #	Qty	Description	Ref #	Part #	Qty Description
1	8761	1	Spacer	7	90343	14 5/8-11 Nut
2	90210	1	1/2-13 x 1-1/2" Gr.5 Cap Screw	8	90640	2 1-8 x 2" Gr. 5 NC Cap Screw
3	90364	1	1/2" Lock Washer	9	90641	2 1" Lock Washer
4	90337	1	1/2-13 Nut	10	90642	2 1" NC Nut
5	90244	12	5/8-11 x 1-1/2" Gr. 5 Cap Screw	11	90247	2 5/8-11 x 2" Gr. 5 Cap Screw
6	90366	14	5/8" Lock Washer			

SAFETY INFORMATION

WARNING



Indicates a potentially hazardous situation that, if not avoided, could result in death or serious personal injury.

CAUTION

Indicates a situation that, if not avoided, could result in minor personal injury and/or damage to product or property.

NOTE: Identifies tips, helpful hints and maintenance information the owner/operator should know.

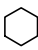
Torque all fasteners according to the torque chart. For proper fit, do not tighten fasteners until instructed to do so.

NC FASTENER TORQUE (FT-LB)			
DIAMETER- THREADS PER INCH	GRADE		
			
	G2	G5	G8
1/4 - 20	6	9	13
5/16 - 18	11	18	28
3/8 - 16	19	31	46
7/16 - 14	30	50	75
1/2 - 13	45	75	115
9/16 - 12	66	110	165
5/8 - 11	93	150	225
3/4 - 10	150	250	370
7/8 - 9	150	378	591
1 - 8	220	583	893

INSTALLATION INSTRUCTIONS

- Turn front wheels all the way to the left. Remove and save the two nuts from the driver-side brake line bracket.
- Relocate the ABS brake wire if present to prevent cutting or chafing the wire.
- Install the driver-side pushplate on the outer side of the leaf spring and on the inner side of the steering arm. Hold the rear of the pushplate under the frame. Reinstall the brake line bracket and spacer to the top brake line bracket bolt. Attach nuts to bracket, but do not tighten any fasteners at this time. Install one 5/8" x 1-1/2" cap screw, 5/8" lock washer and 5/8" nut on rear angle. Install one 1" x 2" cap screw, lock washer and nut on rear angle.
- Repeat on passenger-side pushplate and add a 1/2" x 1-1/2" cap screw, 1/2" lock washer and 1/2" nut in the rear angle where the brake line bracket is on the driver side.
- Remove the bumper and both tow hooks. Install the driver-side and passenger-side hanger with fasteners removed from tow hooks. Install a 5/8" x 1-1/2" cap screw, 5/8" lock washer and 5/8" nut in the lower hanger on both sides.
- Place the commercial connecting beam between the pushplates. Install one 5/8" x 2" cap screw to the upper, front plate and hanger. Install two 5/8" x 1-1/2" cap screws through the lower rear plate on both sides.
- Secure with 5/8" lock washers and 5/8" nuts. Tighten all fasteners.
- Drill two 5/8" holes on each side of the frame. Use the holes on the pushplate rear angle and the tab forward of the rear angle as guides. Check in back of the frame for any wires and lines. Install four 5/8" x 1-1/2" cap screws, 5/8" lock washers and 5/8" nuts. Tighten fasteners.
- Reinstall the bumper.

Copyright © 2001 Douglas Dynamics, L.L.C. All rights reserved. This material may not be reproduced or copied, in whole or in part, in any printed, mechanical, electronic, film or other distribution and storage media, without the written consent of Fisher Engineering. Authorization to photocopy items for internal or personal use by Fisher Engineering outlets is granted.

Fisher Engineering reserves the right under its product improvement policy to change construction or design details and furnish equipment when so altered without reference to illustrations or specifications used herein. Fisher Engineering and the vehicle manufacturer may require and/or recommend optional equipment for snow removal. Fisher Engineering offers a limited warranty for all snowplows and accessories. See separately printed page for this important information. The following are registered (®) trademarks of Douglas Dynamics, L.L.C.: FISHER®, Minute Mount®

Printed in USA