



FISHER ENGINEERING

P.O. Box 529 Rockland, Maine 04841

27670

June 20, 2002

Lit. No 27680

RD/HD Blade Hydraulic Kit Parts List and Installation Instructions

Table of Contents

Safety Information	2
RD/HD Blade Hydraulic Kit Parts List	3
Attaching Hydraulic Fittings to Cylinders	4
Attaching Cylinders to A-Frame and Blade	4

⚠ CAUTION

**Read this document before installing the
snowplow.**

SAFETY DEFINITIONS

Read these instructions and labels on the snowplow before beginning installation.

WARNING

Indicates a potentially hazardous situation, that if not avoided, could result in death or serious personal injury.

CAUTION

Indicates a situation that, if not avoided could result in damage to product or property.

NOTE: Identifies tips, helpful hints, and maintenance information the owner/operator should know.

SAFETY PRECAUTIONS

Improper installation and operation could cause personal injury, and/or equipment and property damage. Read and understand labels and the *Owner's Manual* before installing, operating or making adjustments.

WARNING

Lower blade when vehicle is parked. Temperature changes could change hydraulic pressure, causing the blade to drop unexpectedly or damaging hydraulic components. Failure to do this could result in serious personal injury.

WARNING

Remove blade assembly before placing vehicle on hoist.

WARNING

The driver shall keep bystanders clear of the blade when it is being raised, lowered or angled. Do not stand between the vehicle and the blade or within 8 feet of a moving blade. A moving or falling blade could cause personal injury.

WARNING

Keep hands and feet clear of the blade and A-frame when mounting or removing the snowplow. Moving or falling assemblies could cause personal injury.

WARNING

Do not exceed GVWR or GAWR including the blade and ballast. The rating label is found on the driver-side vehicle door cornerpost.

CAUTION

Refer to the Kit Selection Guide for minimum vehicle recommendations and ballast requirements.

CAUTION

To prevent accidental movement of the blade, always turn the ON/OFF switch to OFF whenever the snowplow is not in use. The control indicator light will turn off.

PERSONAL SAFETY

- Wear only snug-fitting clothing while working on your vehicle or snowplow.
- Do not wear jewelry or a necktie, and secure long hair.
- Wear safety goggles to protect your eyes from battery acid, gasoline, dirt and dust.
- Avoid touching hot surfaces such as the engine, radiator, hoses and exhaust pipes.
- Always have a fire extinguisher rated BC handy, for flammable liquids and electrical fires.

FIRE AND EXPLOSION**⚠ WARNING**

Gasoline is highly flammable and gasoline vapor is explosive. Never smoke while working on vehicle. Keep all open flames away from gasoline tank and lines. Wipe up any spilled gasoline immediately.

Be careful when using gasoline. Do not use gasoline to clean parts. Store only in approved containers away from sources of heat or flame.

VENTILATION**⚠ WARNING**

Vehicle exhaust contains deadly carbon monoxide (CO) gas. Breathing this gas, even in low concentrations, could cause death. Never operate a vehicle in an enclosed area without venting exhaust to the outside.

HYDRAULIC SAFETY**⚠ WARNING**

Hydraulic oil under pressure can cause skin injection injury. If you are injured by hydraulic oil, get medical attention immediately.

- Always inspect hydraulic components and hoses before using. Replace any damaged or worn parts immediately.
- If you suspect a hose leak, DO NOT use your hand to locate it. Use a piece of cardboard or wood.

RD/HD BLADE HYDRAULIC KIT PARTS LIST

27670 RD/HD Blade Low-Friction Hydraulic Kit		
Part	Qty	Description
56603K	2	1-1/2 x 12 Ram Assembly
56591	1	1/4 x 42 Hose w/JIC Ends
56599	1	1/4 x 36 Hose w/JIC Ends
27669	1	Parts Bag for 27670
27669 Parts Bag for 27670		
6816	2	1 x 4 Anchor Pin
22260	2	1 x 4-3/4 Clevis Pin
56725	2	JIC x O-Ring 90-Degree Elbow
56684	2	-6M Flare x 1/4M NPTF Union
90601	4	1/4 x 1-1/2 Cotter Pin ZP
ZP = zinc plate		

ATTACHING HYDRAULIC FITTINGS TO CYLINDERS

1. Turn the jam nut on the fitting as far back as possible.
2. Lubricate the O-ring with clean hydraulic oil. Remove the plug from the cylinder port.

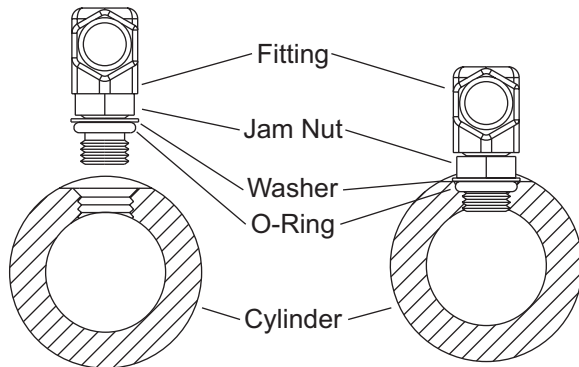

3. Screw the fitting into the port by hand as far as it will go. The washer should contact the port face and the shoulder of the jam nut threads.
4. Unscrew the fitting to proper position, no more than one full turn.
5. Use one wrench to hold the fitting body in position, and tighten the jam nut with another wrench until the washer again contacts the port face. Tighten 1/8 to 1/4 turn to lock fitting in place.
6. Attach the 36" hose to the passenger-side cylinder. Attach the 42" hose to the driver-side cylinder.
7. Tighten the hose onto the fitting until finger tight.

CAUTION

Overtightening the swivel nut will damage the hydraulic hose.

8. Hold the hose to keep it from turning, and tighten the hose swivel nut 1/4 turn.

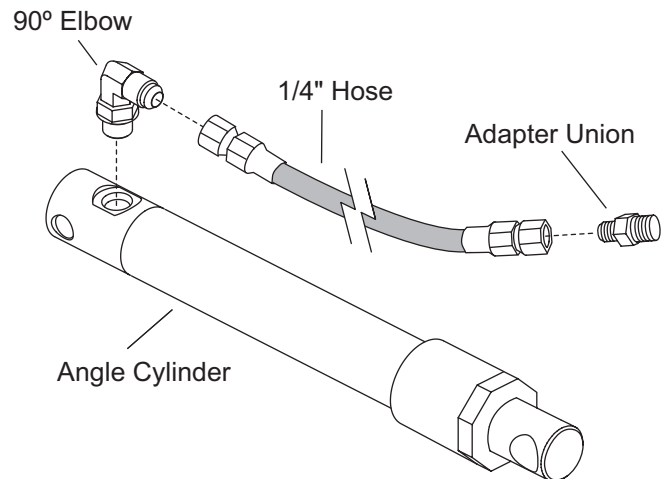

9. For both cylinders, attach the tapered end of an adapter union to the opposite end of the hose, then install the hydraulic coupler.

ATTACHING CYLINDERS TO A-FRAME AND BLADE

1. Attach each cylinder to the A-frame with an 4" anchor pin and cotter pin. Attach the blade to each cylinder using a 4-3/4" clevis pin and cotter pin.

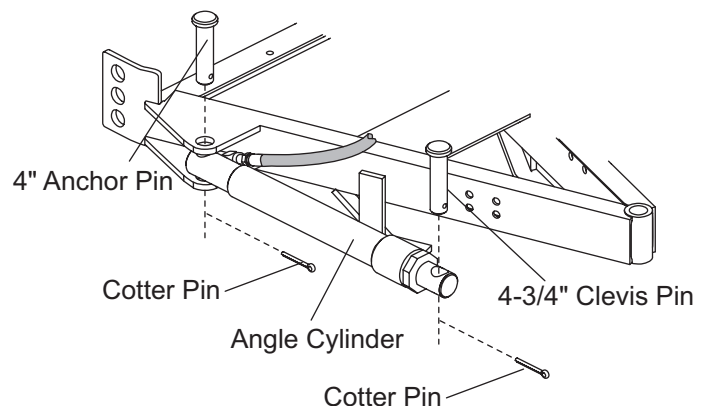

Copyright © 2002 Douglas Dynamics, L.L.C. All rights reserved. This material may not be reproduced or copied, in whole or in part, in any printed, mechanical, electronic, film or other distribution and storage media, without the written consent of Fisher Engineering. Authorization to photocopy items for internal or personal use by Fisher Engineering outlets is granted.

Fisher Engineering reserves the right under its product improvement policy to change construction or design details and furnish equipment when so altered without reference to illustrations or specifications used herein. Fisher Engineering and the vehicle manufacturer may require and/or recommend optional equipment for snow removal. Fisher Engineering offers a limited warranty for all snowplows and accessories. See separately printed page for this important information. The following are registered (®) trademarks of Douglas Dynamics, L.L.C.: FISHER®.