



Headlamp Extension Bracket Kit

CAUTION

Read this document before installing the Headlamp Extension Bracket Kit.

PARTS LIST AND DIAGRAM

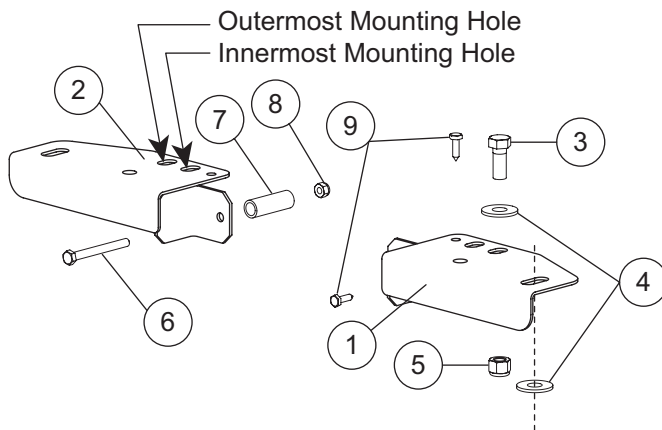

28330 Headlamp Extension Bracket Kit		
Item	Qty	Description
1	1	Headlamp Extension Bracket - DS
2	1	Headlamp Extension Bracket - PS
3	2	1/2-13 x 1-1/4 Hex Cap Screw G5
4	4	1/2 Flat Washer
5	2	1/2-13 Hex Locknut GB
6	2	5/16-18 x 3 Hex Cap Screw SS
7	2	Spacer
8	2	5/16 -18 Hex Locknut GB
9	4	1/4 x 3/4 Self-Tapping Screw
G = Grade SS = Stainless Steel		

INSTALLATION INSTRUCTIONS

Locate the section for the mounting system used on the snowplow. Installation will vary depending on the headgear system on the snowplow as well as the configuration of the headgear.

For Minute-Mount® 2 Headgear:

- Using the outermost mounting hole on the extension bracket, mount the brackets to the existing headlamp mounting holes in the arms with the 1/2"x1-1/4" hex cap screw, 1/2" flat washer and 1/2" hex locknut as shown.

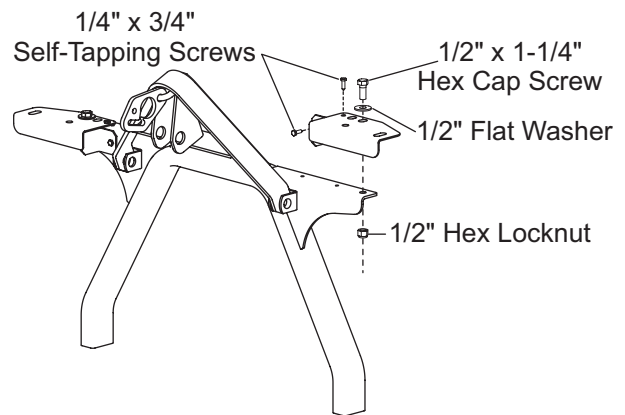

- Verify that there will be adequate clearance between the headlamp and the lift arm as described in the Headlamp/Lift Arm Interference Check section of these instructions.
- Using the extension bracket as a guide, locate and drill four 5/32" pilot holes and insert a 1/4"x3/4" self-tapping screw in each hole. Tighten all fasteners and mount the headlamps as described in the Mount Headlamps to Brackets section of these instructions.

For Original MinuteMount® Headgear:

There are two versions of the headlamp mounting angles. Step 3 will vary depending on whether the top leg of the angle faces to the rear or front of the headgear. See diagrams opposite.

1. Using the outermost mounting hole on the extension bracket, mount the brackets to the existing headlamp mounting holes in the arms with the 1/2"x1-1/4" hex cap screw, 1/2" flat washer and 1/2" hex locknut as shown.
2. Verify that there will be adequate clearance between the headlamp and the lift arm as described in the Headlamp/Lift Arm Interference Check section of these instructions.
3. *For headgear with the top leg of the angle facing to the rear of the headgear:*

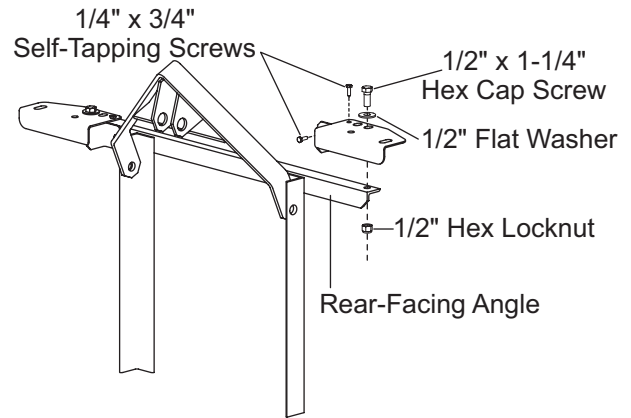

Using the extension bracket as a guide, locate and drill four 5/32" pilot holes and insert a 1/4"x3/4" self-tapping screw in each hole.

For headgear with the top leg of the angle facing to the front of the headgear:

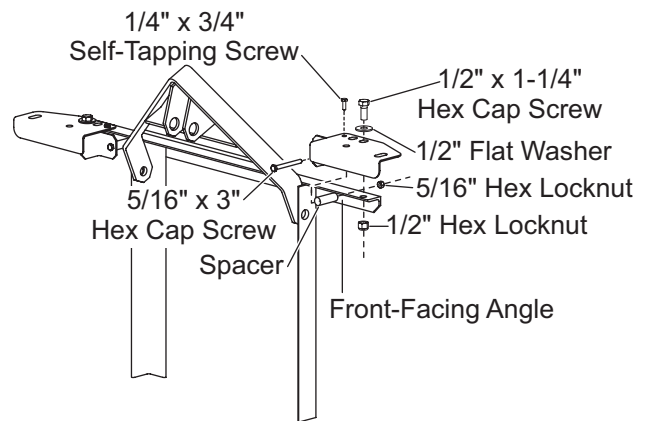

Using the extension brackets and tube spacers as guides, locate and drill two 11/32" holes into the rear leg of the angle and insert the 5/16"x3" hex cap screw into each bracket and secure with the 5/16" hex locknut. Using the extension bracket as a guide, locate and drill two 5/32" pilot holes into the top leg of the angle and insert a 1/4"x3/4" self-tapping screw in each hole.

4. Tighten all fasteners and mount the headlamps as described in the Mount Headlamps to Brackets section of these instructions.

For Conventional Headgear:

There are two versions of the headlamp mounting arms. Measure the length of the arms as shown. Step 1 will vary depending on the length of the arm.

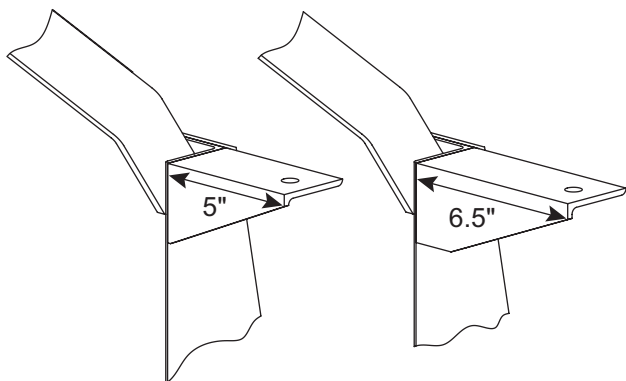

1. *For headgear with 5" measurement of the mounting arm:*

Using the innermost mounting hole on the extension bracket, mount the brackets to the existing headlamp mounting holes in the arms with the 1/2"x1-1/4" hex cap screw, 1/2" flat washer and 1/2" hex locknut as shown.

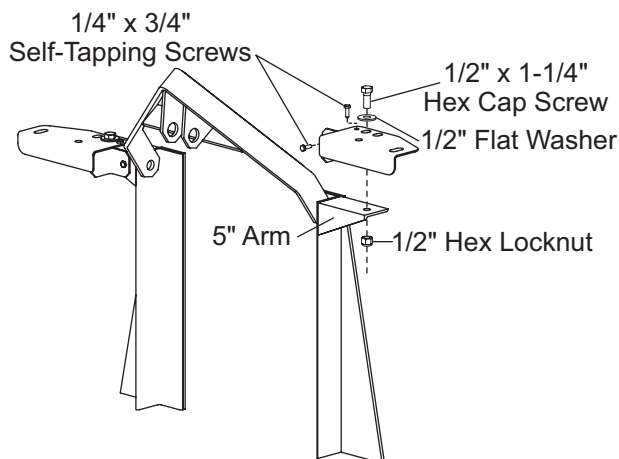

For headgear with 6.5" measurement of the mounting arm:

Using the outermost mounting hole on the extension bracket, mount the brackets to the existing headlamp mounting holes in the arms with the 1/2"x1-1/4" hex cap screw, 1/2" flat washer and 1/2" hex locknut as shown.

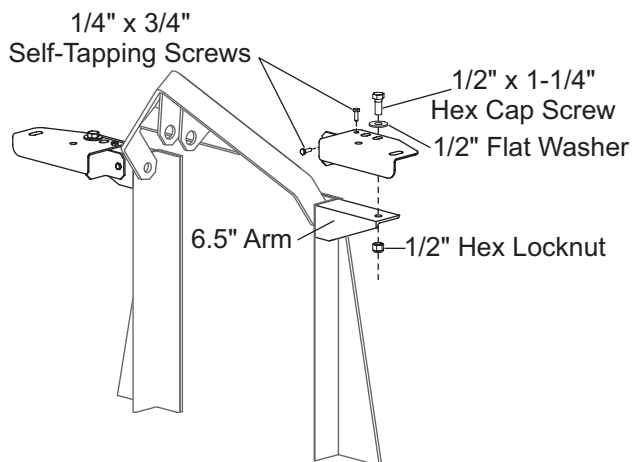

2. Verify that there will be adequate clearance between the headlamp and the lift arm as described in the Headlamp/Lift Arm Interference Check section of these instructions.
3. Using the extension bracket as a guide, locate and drill four 5/32" pilot holes and insert a 1/4"x3/4" self-tapping screw in each hole. Tighten all fasteners and mount the headlamps as described in the Mount Headlamps to Brackets section of these instructions.

Headlamp/Lift Arm Interference Check

Before drilling any holes check that the lift arm does not interfere with the headlamps when the plow is lifted. This can be done by removing the upper lift cylinder pin, slackening the lift chain and manually raising the lift arm to the position shown below. While holding a headlamp in the mounted position, push the lift arm up against the side toward the headlamp. If an interference exists between the headlamp and the lift arm, use the innermost hole on the extension bracket to move the headlamps further out. If no interference exists, proceed with drilling and mounting the extension brackets. If interference is still present, relocate the inner hole to provide clearance.

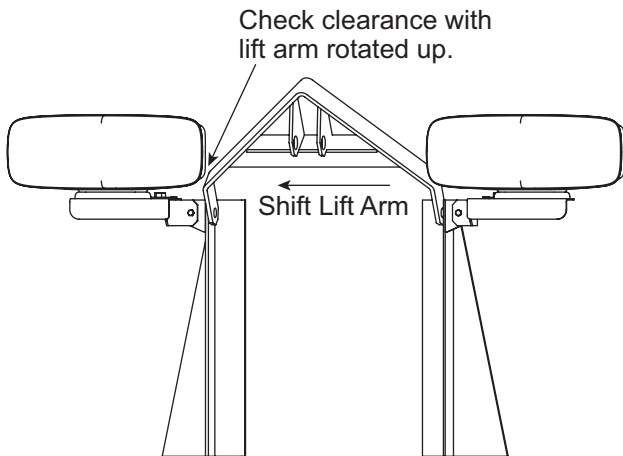

Mounting Headlamps to Extension Brackets

Place the headlamp swivel plate onto the headlamp mounting studs and place the lamp onto the extension bracket. Mount using a 1/2" lock washer and 1/2-13 hex nut on the inside hole of the extension bracket, and a 1/2" flat washer, 1/2" lock washer and 1/2-13 hex nut on the outside slotted hole of the extension bracket as shown below. Shaded items are included in the headlamp kit.

Headlamps are to be aimed as instructed in the Owner's Manual for the snowplow or in the Headlamp Aiming Instructions found in the headlamp kit.

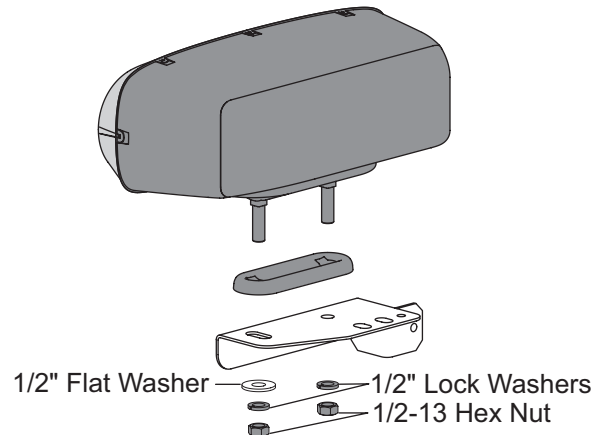

Copyright © 2006 Douglas Dynamics, L.L.C. All rights reserved. This material may not be reproduced or copied, in whole or in part, in any printed, mechanical, electronic, film or other distribution and storage media, without the written consent of Fisher Engineering. Authorization to photocopy items for internal or personal use by Fisher Engineering outlets or snowplow owner is granted.

Fisher Engineering reserves the right under its product improvement policy to change construction or design details and furnish equipment when so altered without reference to illustrations or specifications used. Fisher Engineering and the vehicle manufacturer may require and/or recommend optional equipment for snow removal. Do not exceed vehicle ratings with a snowplow. Fisher Engineering offers a limited warranty for all snowplows and accessories. See separately printed page for this important information. The following are registered (®) trademarks of Douglas Dynamics, L.L.C.: FISHER®, Minute Mount®, Minute Mount® 2.