



Fisher Engineering

50 Gordon Drive, Rockland, Maine 04841-2139 • www.fisherplows.com

52118, 52119, 52120

April 1, 2015

Lit. No. 41761, Rev. 00

1" Rubber Cutting Edge Kit

HD2™ and HDX™ Snowplows

PARTS LIST

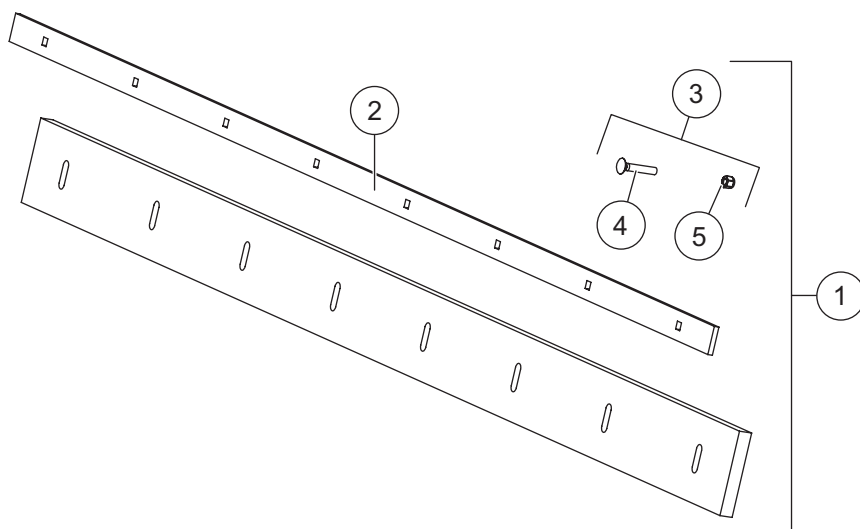

1" Rubber Cutting Edge Kit – HD2 and HDX					
Item	Description	Part Number			
		7-1/2' Blade	8' Blade	8-1/2' Blade	9' Blade
1	1" Rubber Cutting Edge Kit	52118		52119	52120
2	Bolting Bar	51847		52158	51849
3	Bolt Bag – Rubber Cutting Edge	52137			52138

52137 Bolt Bag – 7-1/2', 8', 8-1/2' Blades					
Item	Qty	Description	Item	Qty	Description
4	8	1/2-13 x 3 Carriage Bolt G8	5	8	1/2-13 Hex Locknut GB
52138 Bolt Bag – 9' Blade					
4	11	5/8-11 x 3 Carriage Bolt G5	5	11	5/8-11 Hex Locknut GB
G = Grade					

INSTALLATION INSTRUCTIONS

⚠ WARNING

Do not exceed GVWR or GAWR, including blade and ballast. The rating label is found on the driver-side vehicle door cornerpost.

⚠ WARNING

Blade can drop unexpectedly. Place A-frame on jack stands. Failure to do so could result in serious personal injury.

⚠ CAUTION

Read this document before installing the rubber cutting edge.

⚠ CAUTION

Use standard methods and practices when attaching snowplow and installing accessories, including proper personal protective safety equipment.

⚠ CAUTION

See your FISHER® outlet/Web site for specific vehicle application recommendations before installation. Rubber cutting edge weight information may be found in the eMatch selection system.

1. Park the vehicle on a smooth, level, hard surface, such as concrete. Raise the blade, then turn the control OFF. From the side of the blade assembly, place jack stands under the A-frame.
2. Turn the control ON and lower the blade so the A-frame rests securely on the jack stands. Turn the control OFF. Turn the vehicle ignition to the "OFF" position and remove the key.
3. Remove the existing cutting edge and fasteners from the blade.
4. If the rubber cutting edge will be installed on a 7-1/2" blade, remove 3" from each end of the cutting edge and bolting bar as shown.

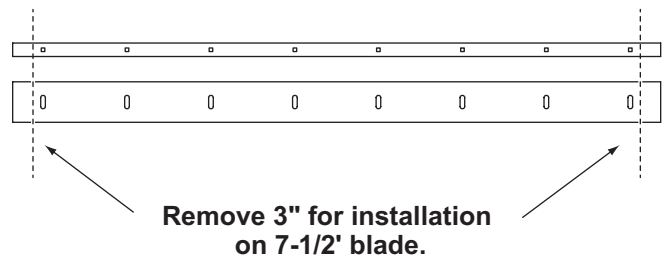

5. Align the retaining bar on the outside face of the rubber cutting edge. Insert the supplied carriage bolts through the bolting bar, rubber cutting edge and base angle. Attach a locknut to each carriage bolt and hand-tighten.

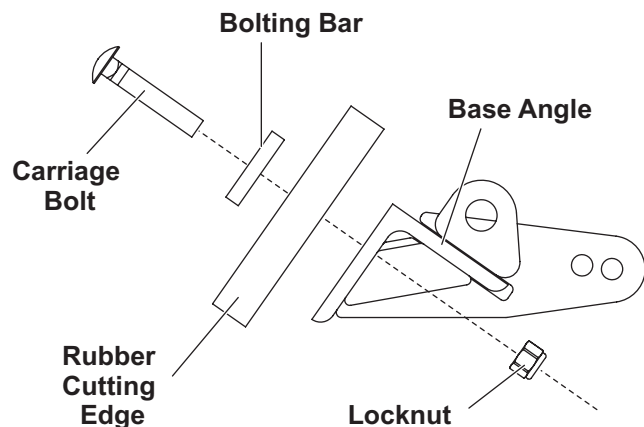

6. Adjust the position of the rubber cutting edge so that it extends approximately 1" beyond the bottom of the blade base angle as shown. Tighten all the carriage bolts until the rubber starts to bulge.

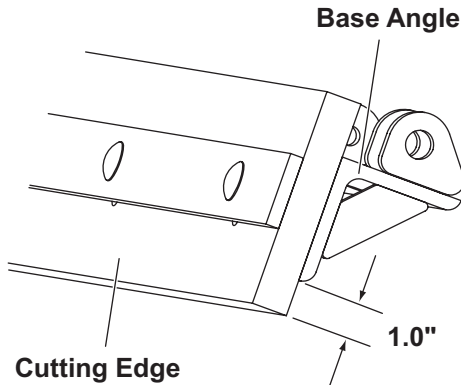

CUTTING EDGE WEAR ADJUSTMENT

As the rubber cutting edge wears, loosen the bolts and slide the cutting edge down so that approximately 1" is again exposed below the base angle. Retighten the bolts until the rubber starts to bulge.

When it cannot be adjusted downward any further, reverse the cutting edge and reinstall it with the unworn edge extending approximately 1" beyond the blade base angle.

7. Turn the vehicle ignition and snowplow control ON. Raise the blade slightly. Turn the control OFF and remove the jack stands.
8. Stand 8 feet clear of the blade, and lower the blade to the ground.
9. Level the A-frame according to the snowplow Installation Instructions or Owner's Manual.

Copyright © 2015 Douglas Dynamics, LLC. All rights reserved. This material may not be reproduced or copied, in whole or in part, in any printed, mechanical, electronic, film or other distribution and storage media, without the written consent of Fisher Engineering. Authorization to photocopy items for internal or personal use by Fisher Engineering outlets or snowplow owner is granted.

Fisher Engineering reserves the right under its product improvement policy to change construction or design details and furnish equipment when so altered without reference to illustrations or specifications used. Fisher Engineering or the vehicle manufacturer may require or recommend optional equipment for snow removal. Do not exceed vehicle ratings with a snowplow. Fisher Engineering offers a limited warranty for all snowplows and accessories. See separately printed page for this important information. The following are registered (®) or unregistered (™) trademarks of Douglas Dynamics, LLC: FISHER®, HD2™, HDX™.

Printed in U.S.A.
