



Fisher Engineering

52147, 52148, 52149, 52150

50 Gordon Drive, Rockland, Maine 04841-2139 • www.fisherplows.com

April 1, 2015

Lit. No. 41762, Rev. 00

3-Piece Carbide Insert Cutting Edge Kit

HD2™ and HDX™ Snowplows

PARTS LIST

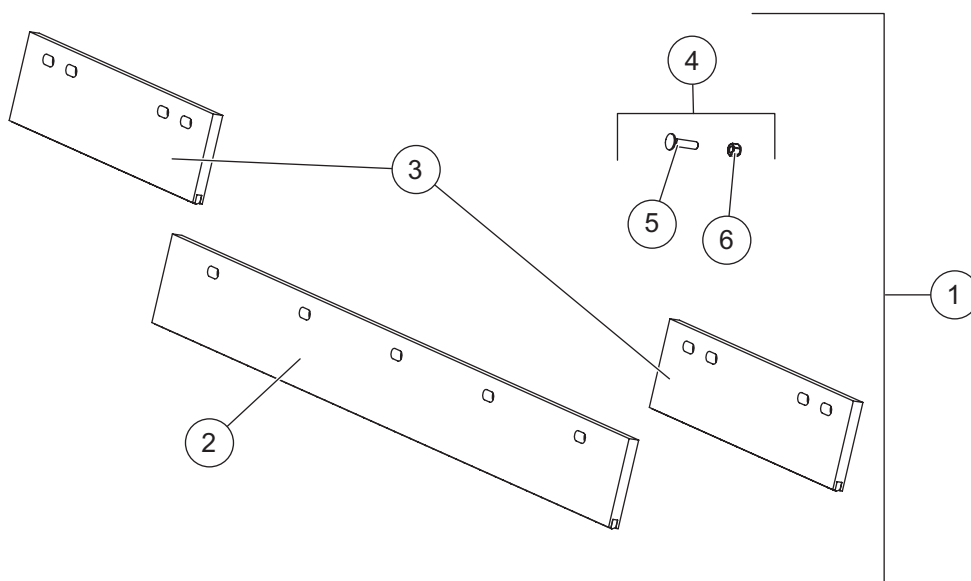

3-Piece Carbide Insert Cutting Edge Kit – HD2 and HDX					
Item	Description	Part Number			
		7-1/2' Blade	8' Blade	8-1/2' Blade	9' Blade
1	3-Piece Carbide Insert Cutting Edge Kit	52147	52148	52149	52150
2	Carbide Insert Cutting Edge – Center	51948		51944	51817
3	Carbide Insert Cutting Edge – Outer (single)	51960	51949	51945	51819
4	Bolt Bag – Carbide Insert Cutting Edge	52209			52208

52209 Bolt Bag – 7-1/2', 8', 8-1/2' Blades					
Item	Qty	Description	Item	Qty	Description
5	8	1/2-13 x 2-1/2 Carriage Bolt G5	6	8	1/2-13 Hex Locknut GB
52208 Bolt Bag – 9' Blade					
5	11	5/8-11 x 2-1/2 Carriage Bolt G5	6	11	5/8-11 Hex Locknut GB
G = Grade					

INSTALLATION INSTRUCTIONS

⚠ WARNING

Do not exceed GVWR or GAWR, including blade and ballast. The rating label is found on the driver-side vehicle door cornerpost.

⚠ WARNING

Blade can drop unexpectedly. Place A-frame on jack stands. Failure to do so could result in serious personal injury.

⚠ CAUTION

Read this document before installing the carbide insert cutting edge.

⚠ CAUTION

Use standard methods and practices when attaching snowplow and installing accessories, including proper personal protective safety equipment.

⚠ CAUTION

See your FISHER® outlet/Web site for specific vehicle application recommendations before installation. Cutting edge weight information may be found in the eMatch selection system.

1. Park the vehicle on a smooth, level, hard surface, such as concrete. Raise the blade, then turn the control OFF. From the side of the blade assembly, place jack stands under the A-frame.
2. Turn the control ON and lower the blade so the A-frame rests securely on the jack stands or blocking. Turn the control OFF. Turn the vehicle ignition to the "OFF" position and remove the key.
3. Remove the existing cutting edge and fasteners from the blade.
4. Align the longest of the three cutting edges with the center of the blade so that there is an equal number of cutting edge holes on either side. Ensure that the carbide insert is oriented in the forward direction.

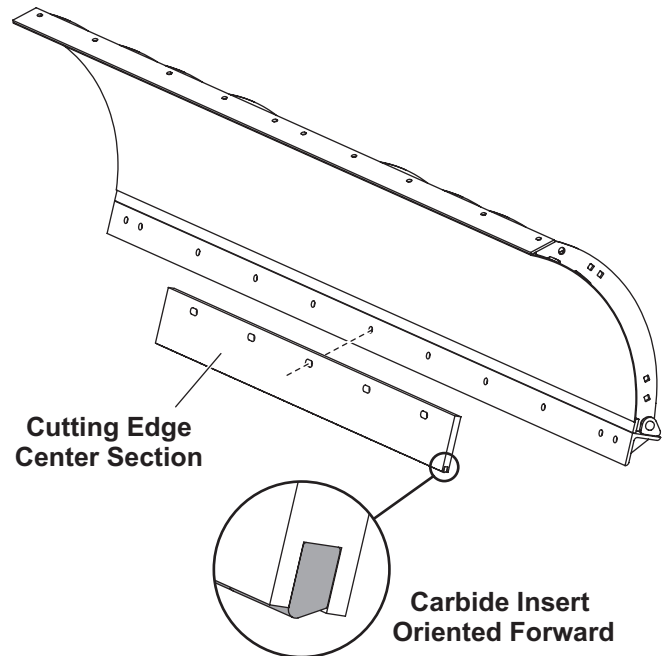

5. Insert the supplied carriage bolts through the cutting edge slots and through the base angle. Attach a locknut to each bolt and hand tighten.

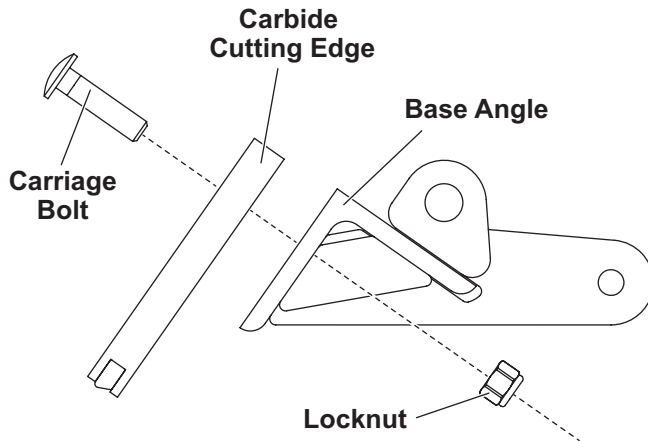

6. Align the two remaining cutting edges with the corresponding holes on the outer ends of the blade. Ensure that the carbide insert in each cutting edge is oriented in the "forward" direction.
7. Insert the supplied carriage bolts through the remaining cutting edge slots and through the base angle. Attach a locknut to each of the carriage bolts and hand tighten.
8. Slide the outside cutting edges toward the center to minimize the gaps between the edges. Center the cutting edges, making sure that both of the outer cutting edges are flush with the ends of the blade.
9. Fully tighten the locknuts.
- 7.5', 8' or 8.5' blade: 75 ft-lb
 - 9' blade: 150 ft-lb
10. Turn the vehicle ignition and snowplow control ON. Raise the blade slightly. Turn the control OFF and remove the jack stands.
11. Stand 8 feet clear of the blade and lower the blade to the ground.
12. Level the A-frame according to the snowplow Installation Instructions or Owner's Manual.

Copyright © 2015 Douglas Dynamics, LLC. All rights reserved. This material may not be reproduced or copied, in whole or in part, in any printed, mechanical, electronic, film or other distribution and storage media, without the written consent of Fisher Engineering. Authorization to photocopy items for internal or personal use by Fisher Engineering outlets or snowplow owner is granted.

Fisher Engineering reserves the right under its product improvement policy to change construction or design details and furnish equipment when so altered without reference to illustrations or specifications used. Fisher Engineering or the vehicle manufacturer may require or recommend optional equipment for snow removal. Do not exceed vehicle ratings with a snowplow. Fisher Engineering offers a limited warranty for all snowplows and accessories. See separately printed page for this important information. The following are registered (®) or unregistered (™) trademarks of Douglas Dynamics, LLC: FISHER®, HD2™, HDX™.

Printed in U.S.A.