

Fisher Engineering

P.O. Box 529 Rockland, Maine 04841

April 30, 1999

No. 6476

Minute Mount[®]

SYSTEM

Attachment Kit

Ford
F150 & Bronco
1987-91

⚠ CAUTION

See your FISHER[®] outlet for application recommendations. The Kit Selection Guide has specific vehicle and snowplow requirements.

Table Of Contents

Attachment Kit Assembly	2
Bolt Bag Parts List	2
Safety Information	3
Installation Instructions	3

7131 KIT PARTS LIST

7131 Attachment Kit					
Part #	Qty Req	Description	Part #	Qty Req	Description
9035	1	Pushplate-Driver Side	6070	2	Hanger
9036	1	Pushplate-Passenger Side	5317	1	Angle Brace
6071	1	Pushrail-Driver Side	8661	1	Angle Brace
6072	1	Pushrail-Passenger Side	9042	1	Bolt Bag-7131

PARTS LIST AND DIAGRAM

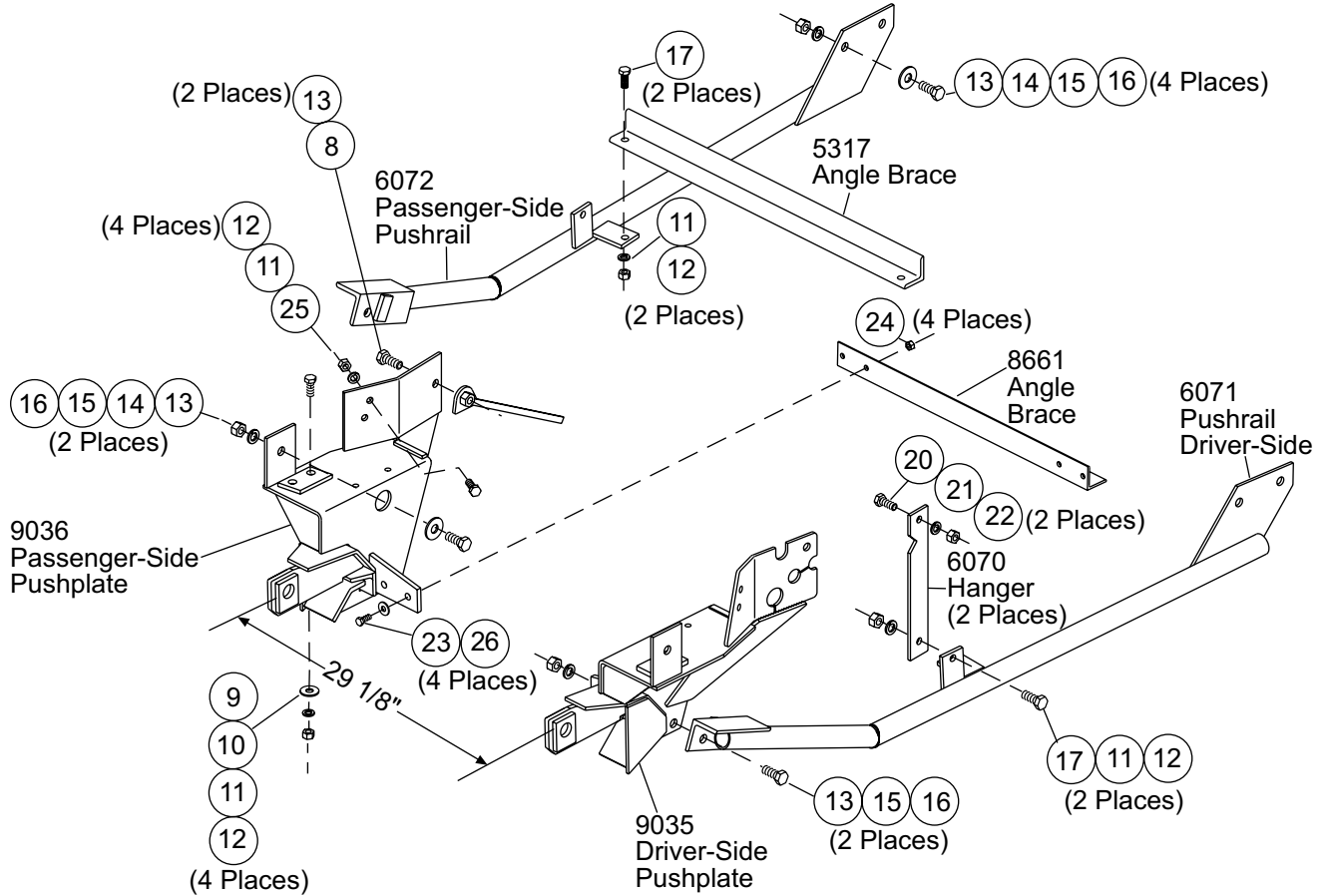

9042 Bolt Bag							
Ref #	Part #	Qty	Description	Ref #	Part #	Qty	Description
8	6037	2	5/8"- 11 Nut with Handle	17	90210	4	1/2"-13 x 1-1/2" Gr. 5 Cap Screw
9	90217	4	1/2"-13 x 2" Gr. 5 Cap Screw	20	90172	2	7/16"-14 x 1" Gr. 5 Cap Screw
10	90319	4	1/2" Flat Washer	21	90362	2	7/16" Lock Washer
11	90364	12	1/2" Lock Washer	22	90335	2	7/16"-14 Nut
12	90337	10	1/2"-13 Nut	23	90103	4	3/8"-16 x 1" Gr. 5 Cap Screw
13	90244	10	5/8"-11 x 1-1/2" Gr. 5 Cap Screw	24	90352	4	3/8"-16 x 1-1/4" Locknut
14	90323	4	5/8" Flat Washer	25	90575	4	1/2"-13 x 1-1/4" Gr. 5 Cap Screw
15	90366	8	5/8" Lock Washer	26	90315	4	3/8" Flat Washer
16	90434	8	5/8"-11 Nut				

SAFETY INFORMATION

WARNING



Indicates a potentially hazardous situation that, if not avoided, could result in death or serious personal injury.

CAUTION

Indicates a situation that, if not avoided, could result in minor personal injury and/or damage to product or property.

NOTE: Identifies tips, helpful hints and maintenance information the owner/operator should know.

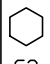
Torque all fasteners according to the torque chart. For proper fit, do not tighten fasteners until instructed to do so.

NC FASTENER TORQUE (FT-LB)			
DIAMETER- THREADS PER INCH	GRADE		
			
	G2	G5	G8
1/4 - 20	6	9	13
5/16 - 18	11	18	28
3/8 - 16	19	31	46
7/16 - 14	30	50	75
1/2 - 13	45	75	115
9/16 - 12	66	110	165
5/8 - 11	93	150	225
3/4 - 10	150	250	370
7/8 - 9	150	378	591
1 - 8	220	583	893

IMPORTANT NOTICES

1. Fisher Engineering makes the following restrictions for this kit in accordance with Ford Motor Company's minimum recommended vehicle equipment for a snowplow installation. Peculiar attachment kit 7131 is designed only for use on the following vehicles:

A. **F150 pickups with heavy duty front suspension - 3800 lb. front GAWR.**

B. **Broncos with heavy duty front suspension - 3800 lb. front GAWR.**

2. **Vehicle loading requirements:**

A. The total vehicle curb weight must not exceed the gross vehicle weight (GVW) or cause either the front or rear gross axle weight rating (GAWR) to be exceeded. The GVW and GAWR are specified on the safety compliance certification label affixed to the vehicle. The vehicle curb weight includes all after market accessories, the snowplow system including the blade, the vehicle occupants and the cargo.

B. No more than 63% of the total vehicle curb weight should be supported by the front axle. If necessary, weight should be securely attached toward the rear of the vehicle to obtain this balance for purposes of complying with Federal Motor Vehicle Hydraulic Braking Standards.

INSTALLATION INSTRUCTIONS

1. Remove and discard air dam.

2. If vehicle is so equipped, remove sway bar, sway bar bracket, rubber bushing and u-shaped hangers from vehicle frame. Discard the brackets but save all other components and connectors for later use.

3. Remove clips holding ground straps on each side of frame and relocate.

NOTE: During the following steps, leave fasteners finger tight until all components are installed and then tighten as directed.

4. **If your vehicle has a sway bar**, you must lace it through the pushplates (one side at a time) as they are being installed in the following steps.

Place the passenger-side pushplate up against vehicle frame with rear plate against the outside face of frame. Install two 1/2" x 2" cap screws down through the frame and pushplate. Secure with two 1/2" flat washers, lock washers, and nuts. Install one 5/8" x 1-1/2" cap screw and flat washer out through the frame and hole in forward tab of pushplate. Secure with a 5/8" lock washer and nut.

5. Repeat step 3 to install the driver-side pushplate. **If you are working with a sway bar**, reinstall the mounting hardware at this time. The bushings mount directly to the pushplate.
6. Place angle brace on the rear of the pushplate tabs with heel down facing to rear of vehicle. Fasten with four 3/8" x 1" cap screws, 3/8" flat washers and locknuts.
7. **On 1991 models** on inside of driver-side frame just forward of transmission cross member, remove bracket holding fuel lines and reposition bracket by relocating rear hole of bracket to front hole of frame.

Drill a 9/32" hole in frame to attach fuel line bracket to frame using the remaining hole in bracket as a guide.

Locate slotted hole in frame even with transmission cross member. Align rear hole in driver-side pushrail with slot. Insert a 5/8" x 1-1/2" Gr. 5 cap screw with flat washer out through frame and pushrail. Fasten with a 5/8" lock washer and nut. Align hole in angle on other end of pushrail with rear hole in pushplate. Fasten with a 5/8" x 1-1/2" Gr. 5 cap screw, lock washer and nut.

Align hole in hanger with hole in tab on pushrail. Insert a 1/2" x 1-1/2" Gr. 5 cap screw in through hanger and tab. Fasten with a 1/2" lock washer and nut. Align remaining hole in hanger with hole in frame just before shock mount. Ream the frame to 15/32" using these holes as guides. Place a 7/16" x 1" Gr. 5 cap screw out through frame and hanger. Fasten with a 7/16" lock washer and nut.

8. Repeat step 7 for passenger-side pushrail.
9. Install angle brace on top of tabs on pushrails. Align holes and fasten with two 1/2 x 1-1/2" Gr. 5 cap screws, lock washers, and nuts.
10. Check the center to center dimension between the connecting pin arms. The measurement should be 29-1/8". Adjust to get this measurement and then tighten the four cap screws on forward cross bar. Then tighten the two forward 1/2" fasteners on front of pushplate. Now tighten remaining fasteners front to back.
11. Using forward hole of rear plate on each pushrail as a guide, drill or ream to 5/8". Install a 5/8 x 1-1/2" Gr. 5 cap screw out through frame and plate. Fasten with a 5/8" lock washer and nut on each pushrail.
12. Locate the three remaining holes in each of the rear plates on the pushplates. Using these holes as guides, drill or ream the forward frame holes to 1/2" and the back hole 5/8". Install two 1/2 x 1-1/4" cap screws out through frame and two forward holes in rear plate. Fasten with two 1/2" lock washers and nuts. Slide 5/8" nut with handle inside the frame and align with rear most hole. Fasten with a 5/8" x 1-1/2" cap screw. Repeat for other side.

Copyright © 1999 Douglas Dynamics, L.L.C. All rights reserved. This material may not be reproduced or copied, in whole or in part, in any printed, mechanical, electronic, film or other distribution and storage media, without the written consent of Fisher Engineering. Authorization to photocopy items for internal or personal use by Fisher Engineering outlets is granted.

Fisher Engineering reserves the right under its product improvement policy to change construction or design details and furnish equipment when so altered without reference to illustrations or specifications used herein. Fisher Engineering and the vehicle manufacturer may require and/or recommend optional equipment for snow removal. Fisher Engineering offers a limited warranty for all snowplows and accessories. See separately printed page for this important information. The following are registered (®) and unregistered (™) trademarks of Douglas Dynamics, L.L.C.: FISHER®, Minute Mount®

Printed in USA