

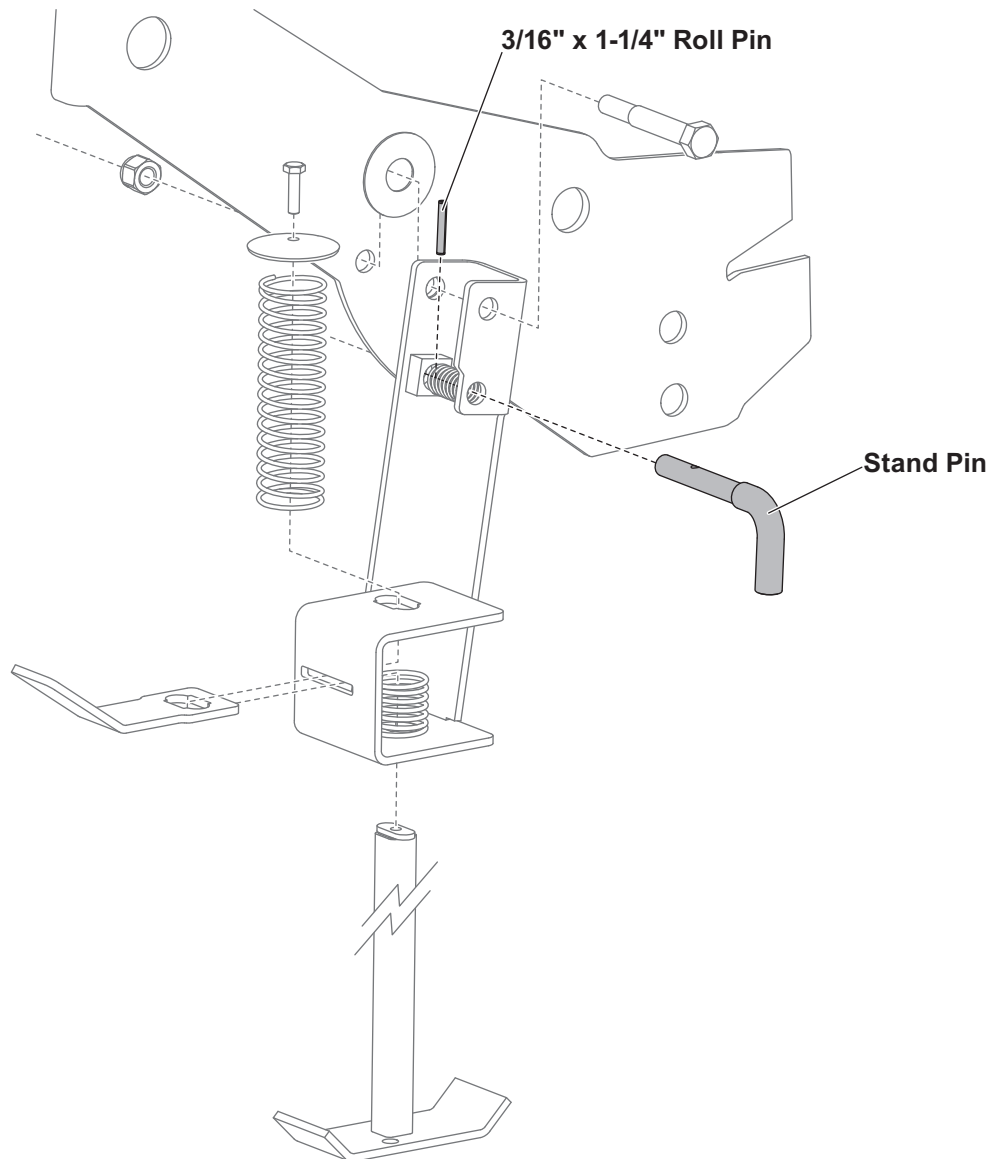

STAND PIN KIT

HT Series™ Snowplows

INSTALLATION INSTRUCTIONS



⚠ CAUTION

Read this document before installing the Stand Pin Kit.

⚠ CAUTION

Use standard methods and practices when attaching snowplow and installing accessories including proper personal protective safety equipment.

INSTALLATION INSTRUCTIONS

On Vehicle – Snowplow Attached

1. Park the vehicle on a smooth, level, hard surface, such as concrete. Lower the blade to the ground, and turn the control OFF. Leave the snowplow attached to the vehicle. Turn the vehicle ignition to the "OFF" position and remove the key.
2. Disconnect the snowplow battery cable.
3. Rotate the jack to the "DOWN" position.
4. Using a 3/16" pin punch, drive the roll pin out of the stand pin.

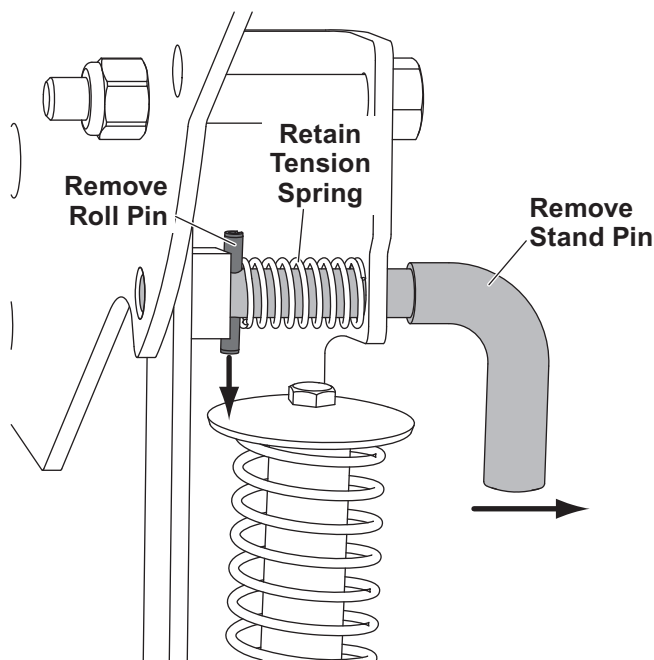

5. Remove the old stand pin by pulling it towards you. Discard the old stand pin.
6. Retain the stand pin tension spring for reassembly.
7. Install the new stand pin by sliding it into the headgear, through the tension spring and into the opposite hole.
8. Install the new 3/16" roll pin in the new stand pin with a 3/16" pin punch.

9. Test the jack stand by rotating it to the "UP" and "DOWN" positions, as shown on the Attach/Detach label on the back of the blade. Verify that the stand pin extends at least 1/4" from the side of the headgear when the jack lock is engaged.

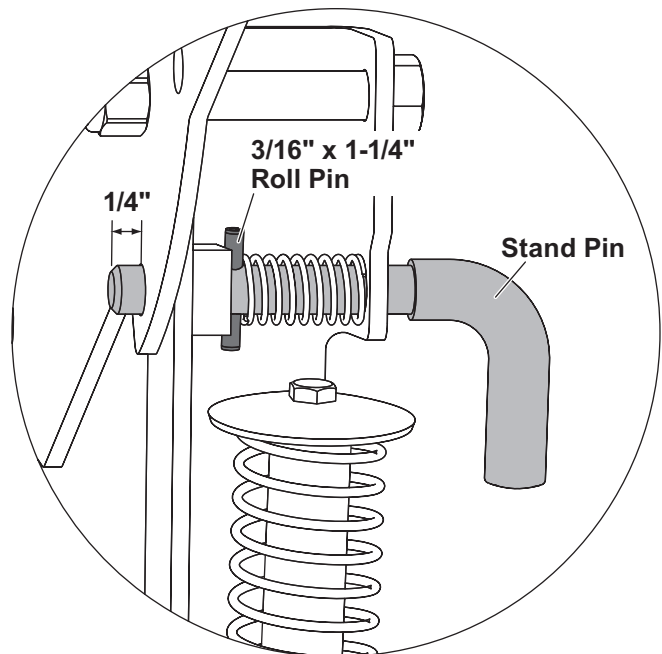

10. Rotate the jack to the "UP" position and lock as shown on the Attach/Detach label on the back of the blade.
11. Reconnect the snowplow battery cable.

Off Vehicle – Snowplow Not Attached

1. Place the snowplow on a smooth, level, hard surface, such as concrete. Raise the back end of the headgear assembly with a floor jack or overhead crane and support in a level position using a block under the main A-frame tubes.

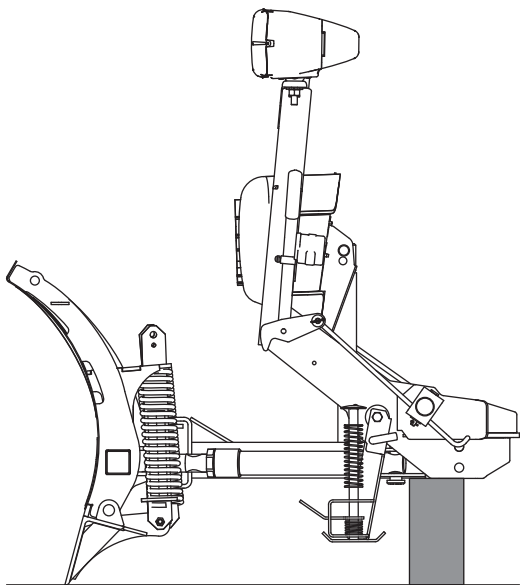

2. Rotate the jack to the "DOWN" position.
3. Using a 3/16" pin punch, drive the roll pin out of the stand pin. Discard the old roll pin.

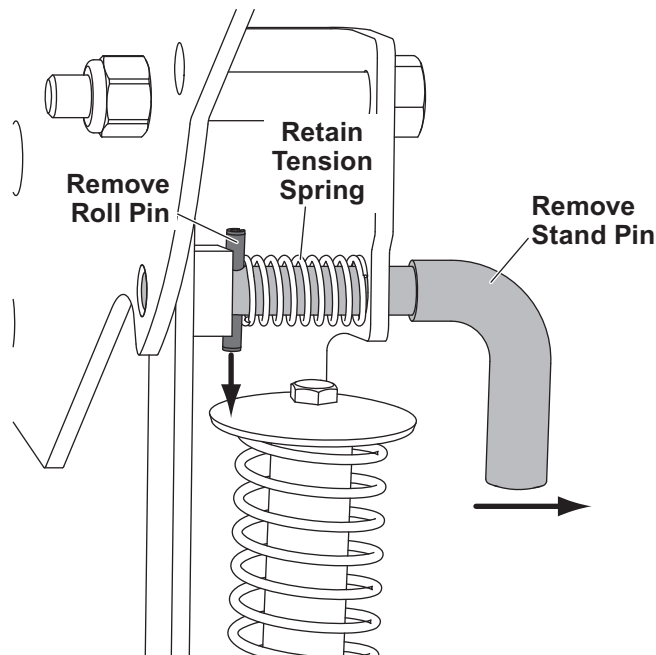

4. Remove the old stand pin by pulling it towards you. Discard the old stand pin.
5. Retain the stand pin tension spring for reassembly.
6. Install the new stand pin by sliding it into the headgear, through the tension spring and into the opposite hole.
7. Install the new 3/16" roll pin in the new stand pin with a 3/16" pin punch.
8. Test the jack stand by rotating it to the "UP" and "DOWN" positions, as shown on the Attach/Detach label on the back of the blade. Verify that the stand pin extends at least 1/4" from the side of the headgear when the jack lock is engaged.

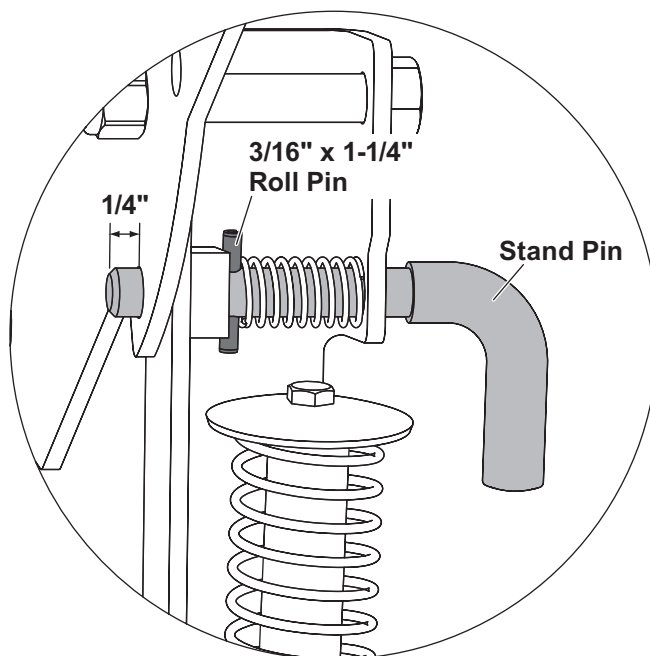

9. Rotate the jack to the "DOWN" position and lock as shown on the Attach/Detach label on the back of the blade.
10. Lift the headgear slightly with a floor jack or overhead crane.
11. Remove the block supporting the headgear.
12. Carefully lower the headgear to the surface allowing the jack stand to support the snowplow.

Fisher Engineering reserves the right under its product improvement policy to change construction or design details and furnish equipment when so altered without reference to illustrations or specifications used. Fisher Engineering or the vehicle manufacturer may require or recommend optional equipment for snow removal. Do not exceed vehicle ratings with a snowplow. Fisher Engineering offers a limited warranty for all snowplows and accessories. See separately printed page for this important information. The following are registered (®) or unregistered (™) trademarks of Douglas Dynamics, L.L.C.: FISHER®, HT Series™.

Printed in U.S.A.
