

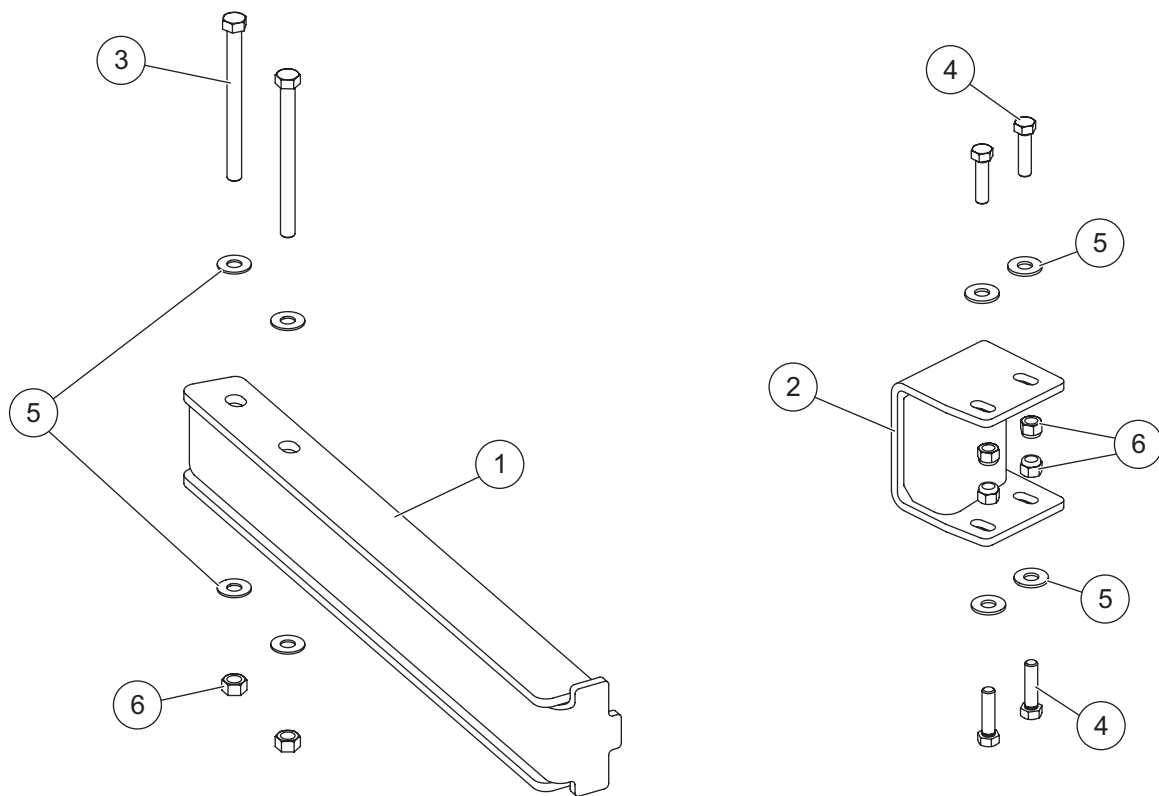

Blade Stop Kit

HC Snowplow

PARTS LIST



76497 Blade Stop Kit							
Item	Part	Qty	Description	Item	Part	Qty Description	
1	57442	2	Outrigger	ns	76792	1 Bolt Bag	
2	57443	2	On-Blade Bracket				
76792 Bolt Bag							
3		4	3/8-16 x 4-1/2 Hex Cap Screw G5	5		16 3/8 Flat Washer	
4		8	3/8-16 x 1-1/2 Hex Cap Screw G5	6		12 3/8-16 Hex Locknut GB	
			ns = not shown				G = Grade

INSTALLATION INSTRUCTIONS

⚠ WARNING

Do not exceed GVWR or GAWR, including blade and ballast. The rating label is found on the driver-side vehicle door cornerpost.

⚠ WARNING

Blade can drop unexpectedly. Place blade on jack stands. Failure to do so could result in serious personal injury.

⚠ CAUTION

Read this document before installing the blade stop kit.

⚠ CAUTION

Use standard methods and practices when attaching snowplow and installing accessories, including proper personal protective safety equipment.

⚠ CAUTION

See your FISHER® outlet/website for specific vehicle application recommendations before installation. Blade stop kit weight information may be found in the eMatch tool.

Park the vehicle on a smooth, level, hard surface, such as concrete. Lower the blade to the ground, and turn the control OFF. Disconnect the snowplow from the vehicle, or turn the vehicle ignition to the "OFF" position and remove the key.

Outrigger to T-Frame

1. Slide an outrigger into one opening or slot of the T-frame.
2. Insert two 3/8" x 4-1/2" cap screws with 3/8" washers through the holes in the outrigger and T-frame.

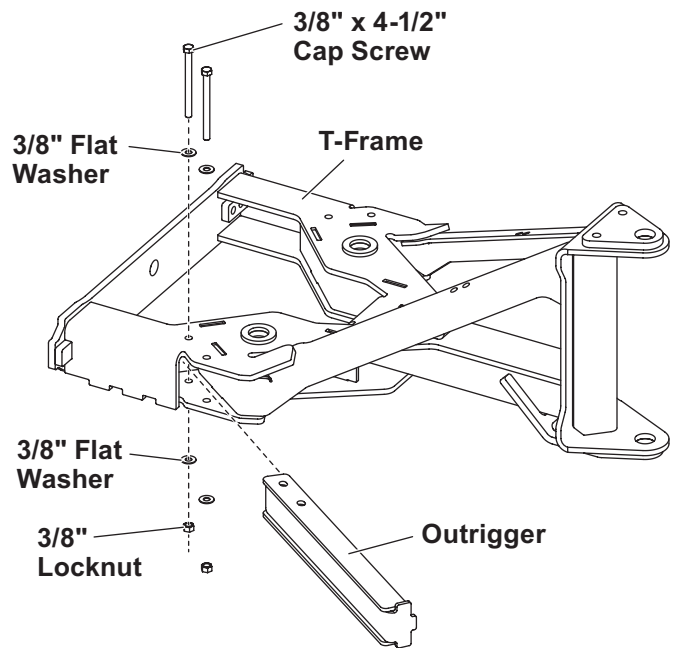

3. Add a second 3/8" washer and a 3/8" locknut on each cap screw.
4. Tighten the fasteners to 31 ft-lb.
5. Repeat on the other side.

On-Blade Bracket to Blade

1. Align one of the on-blade brackets with the holes in two bottom pivot plates as shown.

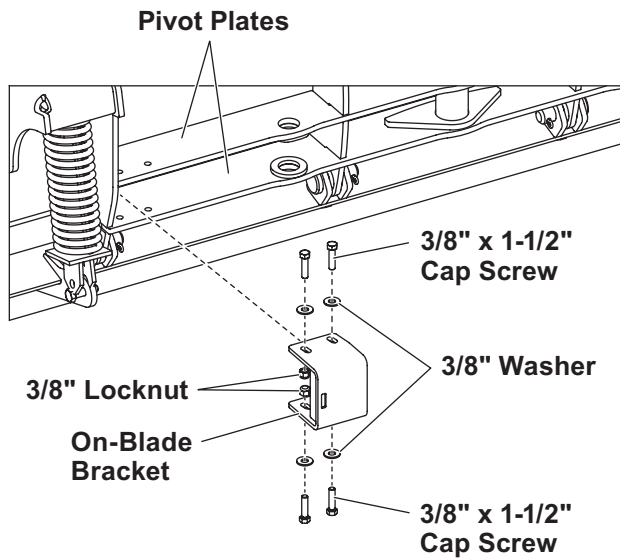

2. Insert four 3/8" x 1-1/2" cap screws with 3/8" washers through the top and bottom slots in the on-blade bracket and the holes in the pivot plates.
3. Add a 3/8" locknut on each fastener to secure the bracket in place.
4. Tighten the fasteners to 31 ft-lb.
5. Repeat on the other side.

Copyright © 2018 Douglas Dynamics, LLC. All rights reserved. This material may not be reproduced or copied, in whole or in part, in any printed, mechanical, electronic, film, or other distribution and storage media, without the written consent of Fisher Engineering. Authorization to photocopy items for internal or personal use by Fisher Engineering outlets or snowplow owner is granted.

Fisher Engineering reserves the right under its product improvement policy to change construction or design details and furnish equipment when so altered without reference to illustrations or specifications used. Fisher Engineering or the vehicle manufacturer may require or recommend optional equipment for snow removal. Do not exceed vehicle ratings with a snowplow. Fisher Engineering offers a limited warranty for all snowplows and accessories. See separately printed page for this important information. The following are registered (®) or unregistered (™) trademarks of Douglas Dynamics, LLC: FISHER®.

Printed in U.S.A.
