



# Wear Strip Kit

## XLS™ 810 & 8611 Snowplows

### INSTALLATION INSTRUCTIONS

#### ⚠ WARNING

Do not exceed GVWR or GAWR, including blade and ballast. The rating label is found on the driver-side vehicle door cornerpost.

#### ⚠ WARNING

Blade can drop unexpectedly. Place blade on jack stands. Failure to do so could result in serious personal injury.

#### ⚠ CAUTION

Read this document before installing the wear strip kit.

#### ⚠ CAUTION

Use standard methods and practices when attaching snowplow and installing accessories, including proper personal protective safety equipment.

#### ⚠ CAUTION

See your FISHER® outlet/website for specific vehicle application recommendations before installation. The eMatch selection system has specific vehicle and snowplow requirements.

1. Park the vehicle on a smooth, level, hard surface, such as concrete. Raise the blade, then turn the control OFF. From the side of the blade assembly, place jack stands under the quadrant.
2. Turn the control ON and lower the blade so that the blade rests securely on the jack stands. Fully extend the blade wings to the straight position.
3. Turn the control OFF. Turn the vehicle ignition to the "OFF" position and remove the key.
4. Determine whether the blade has three pre-drilled holes along the top edge for installing the wear strips. *If the blade does not have all three required holes, continue with Step 5. If it already has all three required holes, go to Step 6.*
5. **Blades without all three required holes:**
  - a. Remove and discard the two bolts on each end of the blade (four bolts total) that attach the top of the moldboard to the blade frame.
  - b. Cut out the templates on page 3 of these instructions.
  - c. Align the *driver-side* template against the moldboard edges as shown.
  - d. Center punch the additional hole location indicated on the template. Remove the template and drill a 7/16" hole at the marked point.
  - e. Repeat Steps 5a–5d on the opposite end of the blade, using the *passenger-side* template to mark for the drill hole.
  - f. Proceed to Step 7.

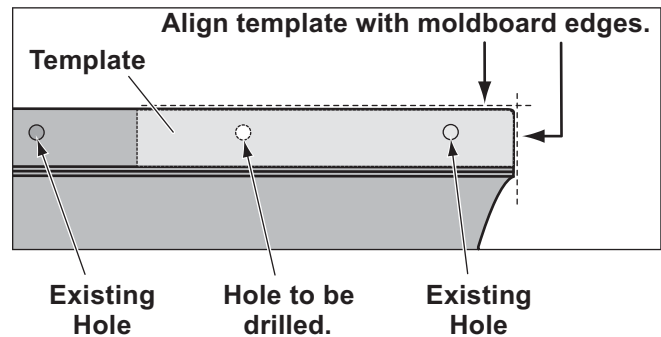

6. **Blades with three existing holes:** Remove and discard the three bolts on each end of the blade (six bolts total) that attach the top of the moldboard to the blade frame.
7. Install a wear strip at each end of the blade using a 3/8" x 1" hex socket head screw, 3/8" flat washer, and 3/8" brass locknut in each hole. The wear strips should slightly overhang the moldboard, as shown.

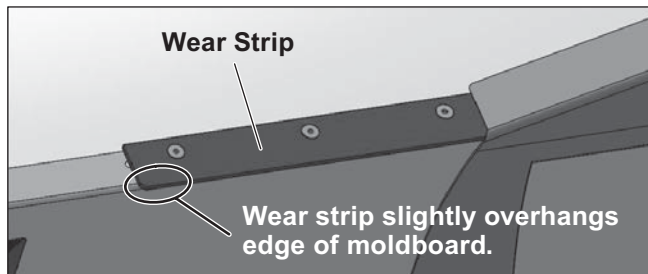
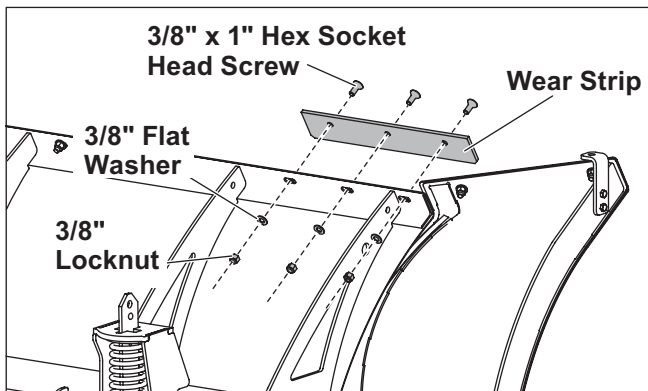

8. Fully tighten the wear strip fasteners to 31 ft-lb.

# XLS™ 810 and 8611 Passenger-Side Wear Strip Template

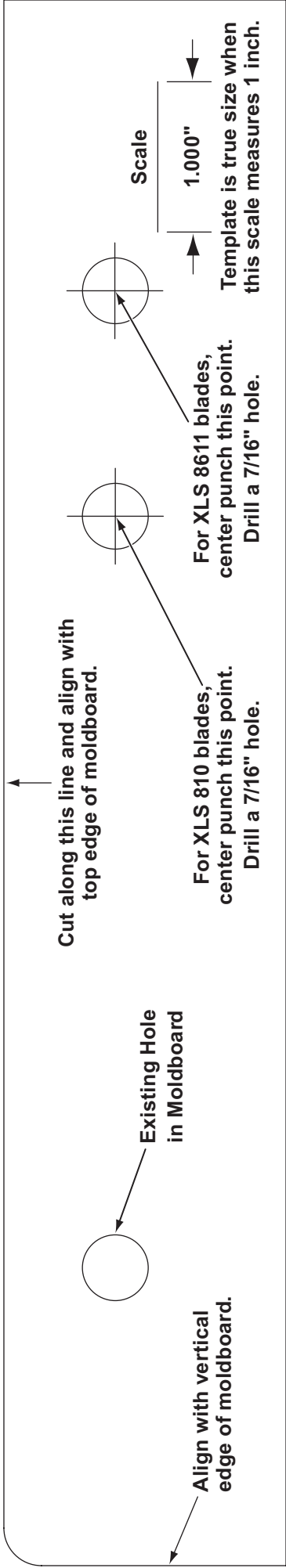

# XLS 810 and 8611 Driver-Side Wear Strip Template

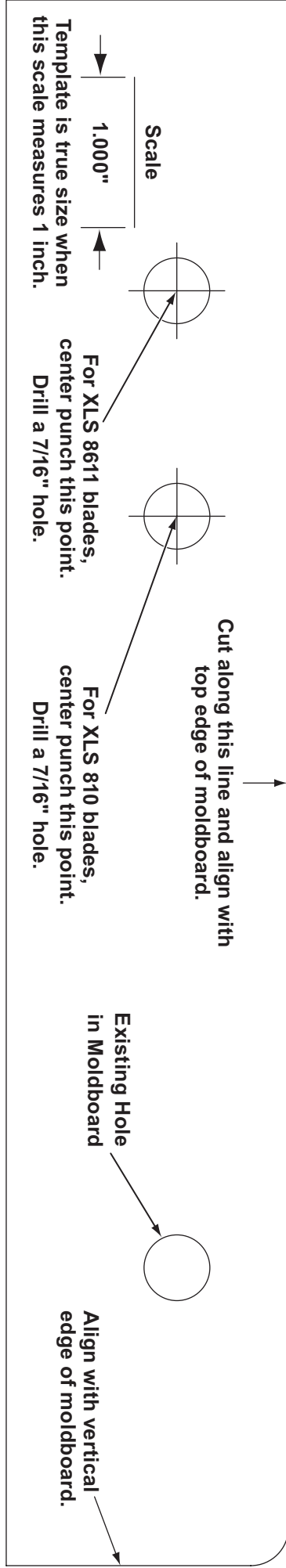

Fisher Engineering reserves the right under its product improvement policy to change construction or design details and furnish equipment when so altered without reference to illustrations or specifications used. Fisher Engineering or the vehicle manufacturer may require or recommend optional equipment for snow removal. Do not exceed vehicle ratings with a snowplow. Fisher Engineering offers a limited warranty for all snowplows and accessories. See separately printed page for this important information. The following are registered (®) or unregistered (™) trademarks of Douglas Dynamics, LLC: FISHER®, XLS™.

**Printed in U.S.A.**

---