

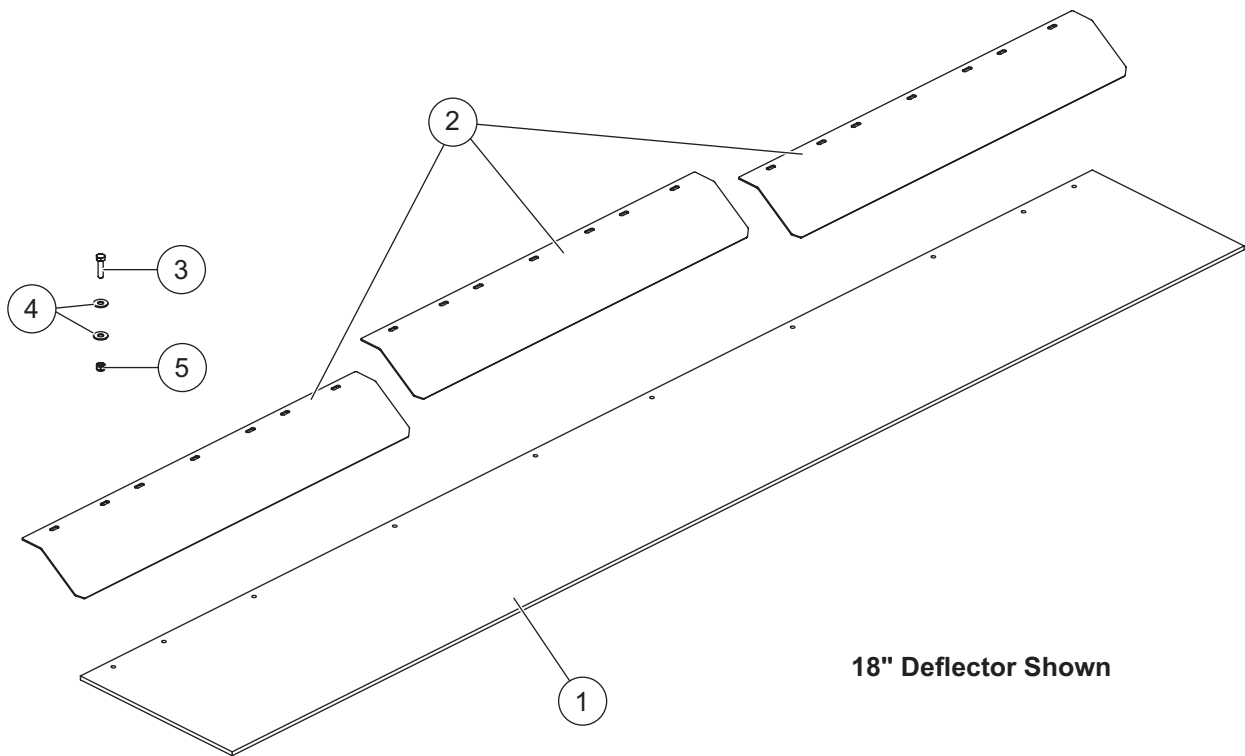

Rubber Deflector Kits

9' & 10' HC Snowplows

PARTS LIST



57411 Rubber Deflector Kit – 18"							
Item	Part	Qty	Description	Item	Part	Qty	Description
1	57413	1	Rubber Deflector, 3/8 x 18 x 120	ns	52540	1	Bolt Bag
2	57412	3	Deflector Bracket (18" only)				
57420 Rubber Deflector Kit – 10"							
ns	57417	1	Rubber Deflector, 3/8 x 10 x 120	ns	52540	1	Bolt Bag
ns	57415	3	Deflector Bracket (10" only)				
52540 Bolt Bag							
3		10	5/16-18 x 1-1/4 Hex Cap Screw G5	5		10	5/16 Hex Locknut GB
4		20	5/16 Flat Washer				
ns = not shown				G = Grade			

INSTALLATION INSTRUCTIONS

⚠ WARNING

Do not exceed GVWR or GAWR, including blade and ballast. The rating label is found on the driver-side vehicle door cornerpost.

⚠ CAUTION

Read this document before installing the rubber deflector.

⚠ CAUTION

Use standard methods and practices when attaching snowplow and installing accessories, including proper personal protective safety equipment.

⚠ CAUTION

See your FISHER® outlet/website for specific vehicle application recommendations before installation. Rubber deflector weight information may be found in the eMatch selection system.

NOTE: Due to the weight and size of this deflector, two people are recommended for installation.

This deflector is designed to fit 9' and 10' HC blade models. On 9' blades, the deflector must be trimmed.

For installation on 9' blades, refer to the illustration below when resizing the deflector. A sharp utility knife works well to cut the rubber. For best results, plan on multiple knife passes.

Resizing Rubber Deflector for 9' Blade

Trim both ends as shown.

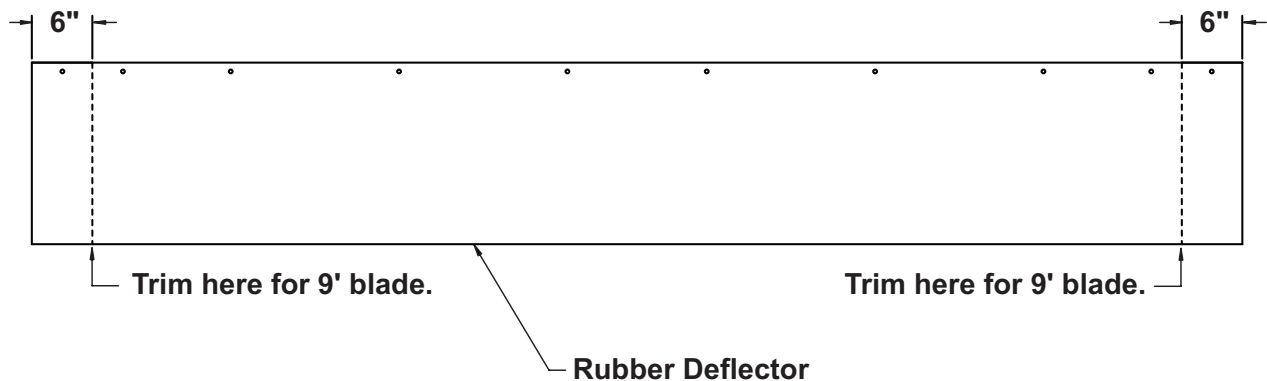

1. Park the vehicle on a smooth, level, hard surface, such as concrete. Lower the blade to the ground, and turn the control OFF. Disconnect the snowplow from the vehicle, or turn the vehicle ignition to the "OFF" position and remove the key.
2. Place the rubber deflector on top of the blade. Line up the holes in the deflector with the holes in the top bar.

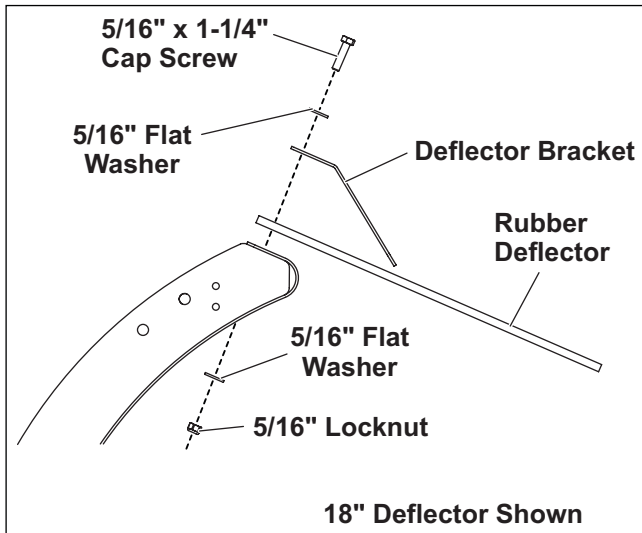

3. Attach a deflector bracket to the rubber deflector, starting on the passenger's side.
 - a. Line up the 4 holes in the bracket with the holes in the deflector.

- b. Secure the bracket to the deflector using one 5/16" x 1-1/4" cap screw, two 5/16" washers, and one 5/16" locknut per hole, as shown in the illustrations.
 - c. Verify the bracket is tight against the deflector and moldboard.
4. Attach the remaining deflector brackets.
 - a. Place one deflector bracket in the center and the other bracket on the driver's side on top of the deflector.
 - b. Line up the 2 holes in the center bracket with the corresponding holes in the deflector, and then line up the 4 holes in the end bracket with the corresponding holes on the deflector.
 - c. Attach the brackets using one 5/16" x 1-1/4" cap screw, two 5/16" washers, and one 5/16" locknut per hole, as shown below.
 - d. Verify the brackets are tight against the deflector and moldboard.
5. Tighten all fasteners to 17 ft-lb.

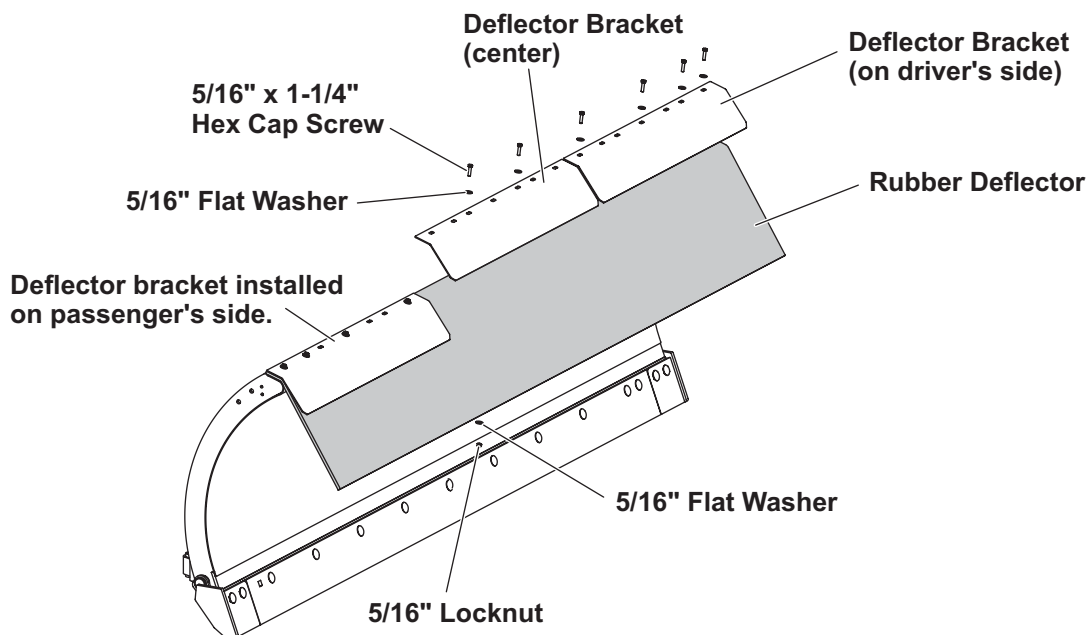

Copyright © 2018 Douglas Dynamics, LLC. All rights reserved. This material may not be reproduced or copied, in whole or in part, in any printed, mechanical, electronic, film, or other distribution and storage media, without the written consent of Fisher Engineering. Authorization to photocopy items for internal or personal use by Fisher Engineering outlets or snowplow owner is granted.

Fisher Engineering reserves the right under its product improvement policy to change construction or design details and furnish equipment when so altered without reference to illustrations or specifications used. Fisher Engineering or the vehicle manufacturer may require or recommend optional equipment for snow removal. Do not exceed vehicle ratings with a snowplow. Fisher Engineering offers a limited warranty for all snowplows and accessories. See separately printed page for this important information. The following is a registered (®) trademark of Douglas Dynamics, LLC: FISHER®.

Printed in U.S.A.
