

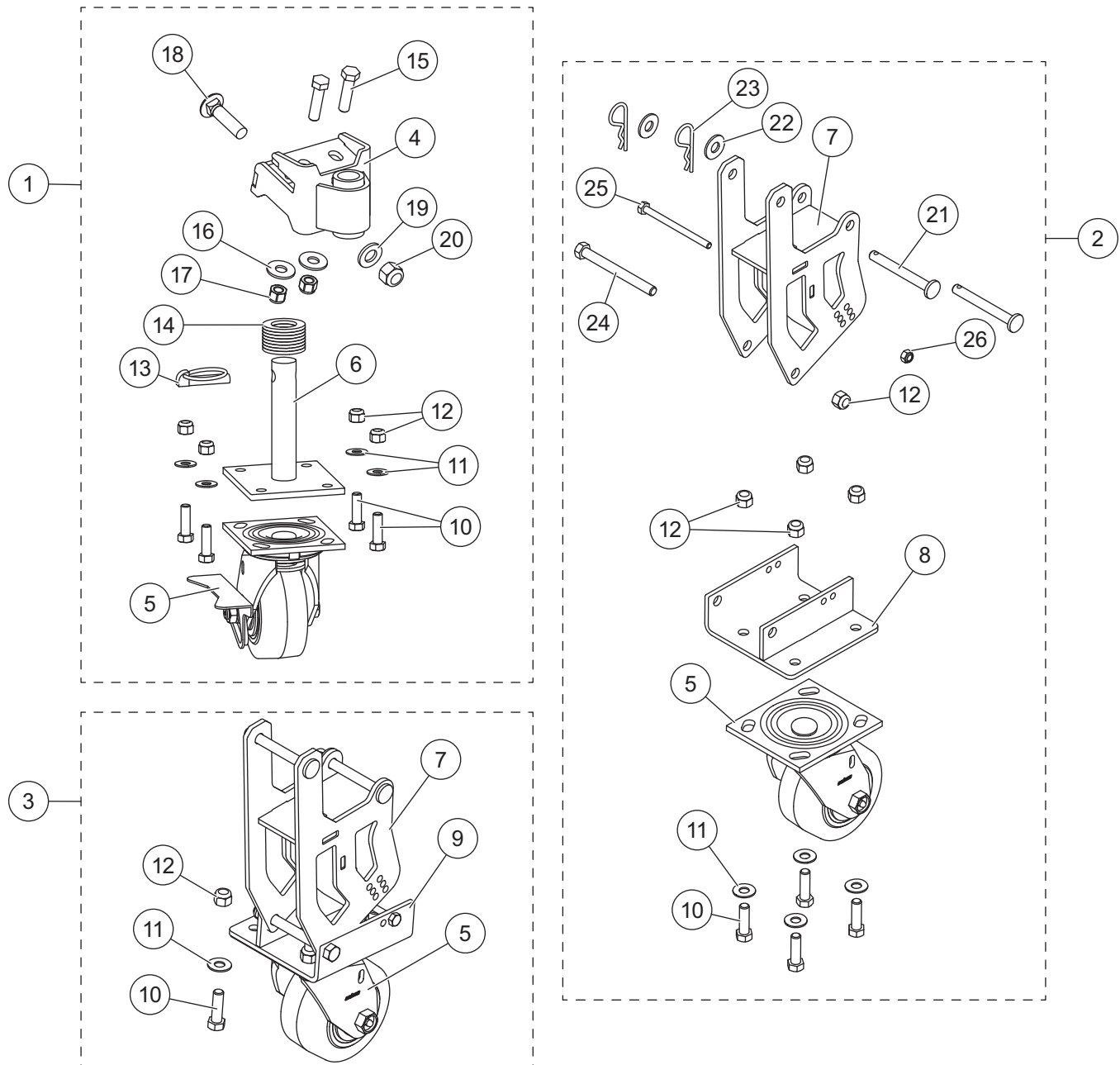

# Wheel Assembly Kit

## 10' HC Snowplow

### PARTS LIST



**WHEEL ASSEMBLY KIT COMPONENTS**

<b>77525 Wheel Assembly Kit</b>							
Item	Part	Qty	Description	Item	Part	Qty	Description
1	77530	2	Shoe Wheel Kit, 10' HC	3	77507	1	Headgear Wheel Kit, 10' HC – PS
2	77508	1	Headgear Wheel Kit, 10' HC – DS				
<b>Item 1 77530 Shoe Wheel Kit, 10' HC</b>							
4	57449	1	Attachment Bracket	6	93289	1	Wheel Mount
5	93286	1	Swivel Caster Wheel	ns	77526	1	Bolt Bag, Shoe Wheel Kit
<b>Item 2 77508 Headgear Wheel Kit, 10' HC – DS</b>							
5	93286	1	Swivel Caster Wheel	8	77520	1	Foot Bracket – DS
7	77523	1	Leg Bracket	ns	77534	1	Bolt Bag, Headgear Wheel Kit
<b>Item 3 77507 Headgear Wheel Kit, 10' HC – PS</b>							
5	93286	1	Swivel Caster Wheel	9	77522	1	Foot Bracket – PS
7	77523	1	Leg Bracket	ns	77534	1	Bolt Bag, Headgear Wheel Kit
<b>77526 Bolt Bag, Shoe Wheel Kit</b>							
10		4	3/8-16 x 1-1/4 Hex Cap Screw G5	16		2	1/2 Flat Washer, Type A Wide
11		4	3/8 Flat Washer	17		2	1/2-13 Hex Locknut GB
12		4	3/8-16 Hex Locknut GB	18		1	5/8-11 x 2-1/2 Carriage Bolt G5
13		1	7/16 x 1-3/4 Linchpin	19		1	5/8 Hardened Flat Washer, Type 1
14		8	Round Flat Washer, Special	20		1	5/8-11 Hex Locknut GB
15		2	1/2-13 x 2 Hex Cap Screw G5				
<b>77534 Bolt Bag, Headgear Wheel Kit</b>							
10		4	3/8-16 x 1-1/4 Hex Cap Screw G5	23		2	1/8 Hairpin Cotter
11		4	3/8 Flat Washer	24		1	3/8-16 x 4 Hex Cap Screw G5
12		5	3/8-16 Hex Locknut GB	25		1	1/4-20 x 4 Hex Cap Screw G5
21		2	3/8 OD x 3-1/4 Clevis Pin	26		1	1/4-20 Hex Locknut GB
22		2	3/8 Flat Washer, Type A Wide				
ns = not shown				G = Grade			

## INSTALLATION INSTRUCTIONS

### ⚠ WARNING

Do not exceed GVWR or GAWR, including blade and ballast. The rating label is found on the driver-side vehicle door cornerpost.

### ⚠ WARNING

Blade can drop unexpectedly. Place blade on jack stands. Failure to do so could result in serious personal injury.

### ⚠ CAUTION

Read this document before installing the wheel assembly kit.

### ⚠ CAUTION

Use standard methods and practices when attaching snowplow and installing accessories, including proper personal protective safety equipment.

### ⚠ CAUTION

See your FISHER® outlet/website for specific vehicle application recommendations before installation. Wheel assembly weight information may be found in the eMatch tool.

## Installing the Attachment Bracket

1. Park the vehicle on a smooth, level, hard surface, such as concrete. Raise the blade, then turn the control OFF.
2. From the front of the blade assembly, place jack stands under the blade.
3. Turn the control ON and lower the blade so that the blade rests securely on the jack stands. Turn the control OFF. Turn the vehicle ignition to the "OFF" position and remove the key.
4. Remove the 5/8" x 2" carriage bolt and 5/8" locknut that attach the cutting edge to the blade.
5. Position the attachment bracket to the blade base angle as shown below. Align the holes in the attachment bracket with the holes in the base angle and cutting edge.
6. Starting on the driver's side, loosely assemble an attachment bracket with two 1/2" x 2" cap screws, 1/2" washers, and 1/2" locknuts through the top of the bracket and base angle. Replace the 5/8" x 2" carriage bolt and 5/8" locknut removed in Step 4 with the 5/8" x 2-1/2" carriage bolt, 5/8" washer, and 5/8" locknut provided in the shoe wheel kit bolt bag, inserting the carriage bolt through the cutting edge and attachment bracket.

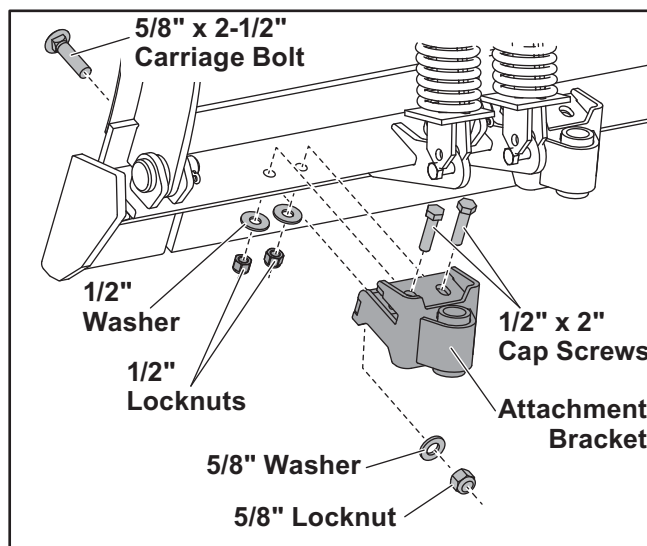

7. Tighten the 1/2" fasteners to 75 ft-lb. Tighten the 5/8" fasteners to 150 ft-lb.
8. Repeat Steps 4–7 for the passenger's side.

## Mounting Swivel Caster Wheels to the Wheel Mounts & Wheel Brackets

1. **For the shoe wheels:** Use the provided 3/8" hardware from the shoe wheel kit bolt bag to attach the swivel caster wheels to the wheel mounts as shown below.

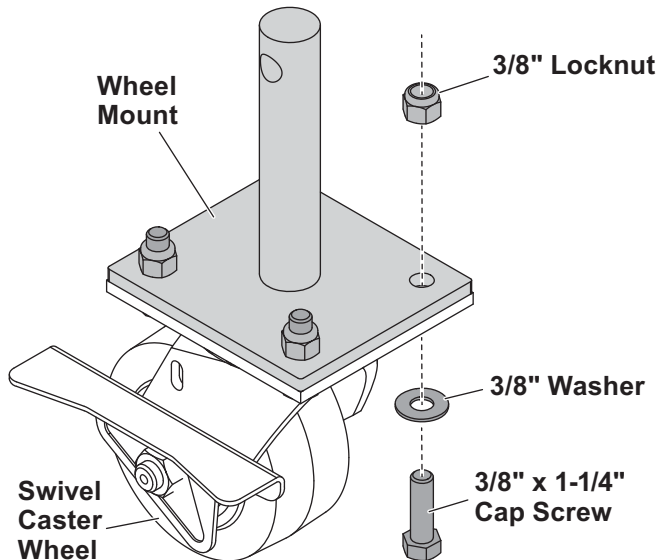

2. **For the headgear wheels:** Use the provided 3/8" hardware from the headgear wheel kit bolt bags to attach the swivel caster wheels to the passenger-side and driver-side foot brackets and tighten securely.

Attach the foot bracket/swivel caster wheel to the leg bracket using a 3/8" x 4" cap screw and 3/8" locknut. Tighten the locknut as much as possible while allowing the leg bracket and foot bracket to pivot freely.

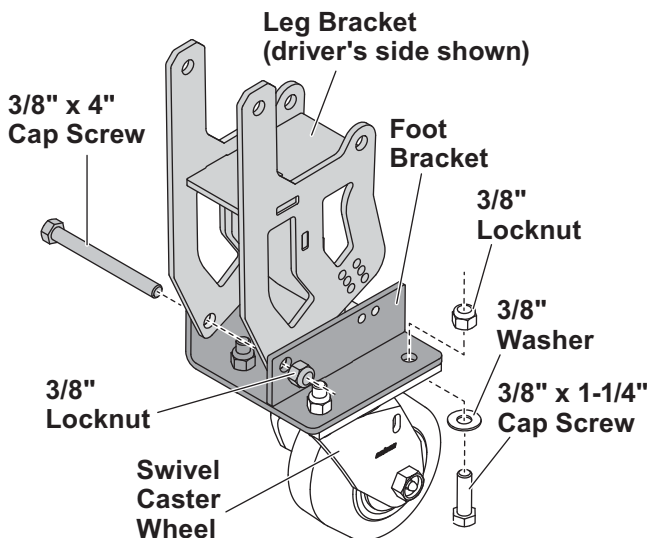

## Attaching Shoe Wheel Assemblies

1. Insert the wheel mount stem through the bottom of the attachment bracket.
2. Adjust the wheel to the desired height by adding/removing the supplied round flat washers onto the wheel mount stem.

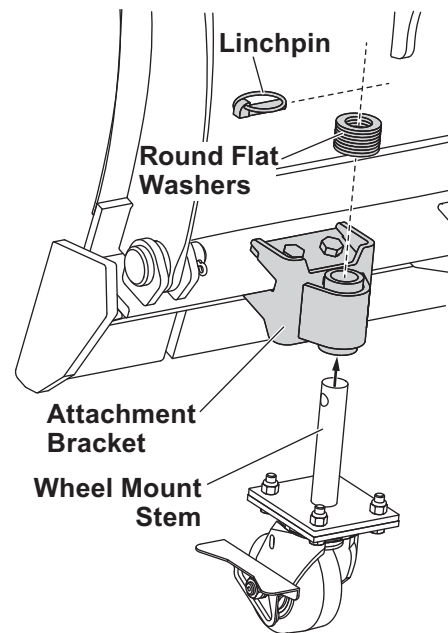

3. Secure the shoe wheel assembly to the blade using the supplied linchpin.
4. Repeat for the opposite side.
5. Turn the vehicle ignition to the "ON" position and turn the control ON. Slightly raise the blade, and then turn the vehicle ignition and the control OFF.
6. Remove the jack stands and lower the blade to the ground. Activate the wheel locks.

## Installing Headgear Wheel Assemblies to the Headgear

1. Detach the snowplow from the vehicle. Refer to the Owner's Manual for instructions.
2. Push the headgear forward until it rests on the T-frame. Reposition the lift chains to remove any slack and to prevent any unexpected movement.

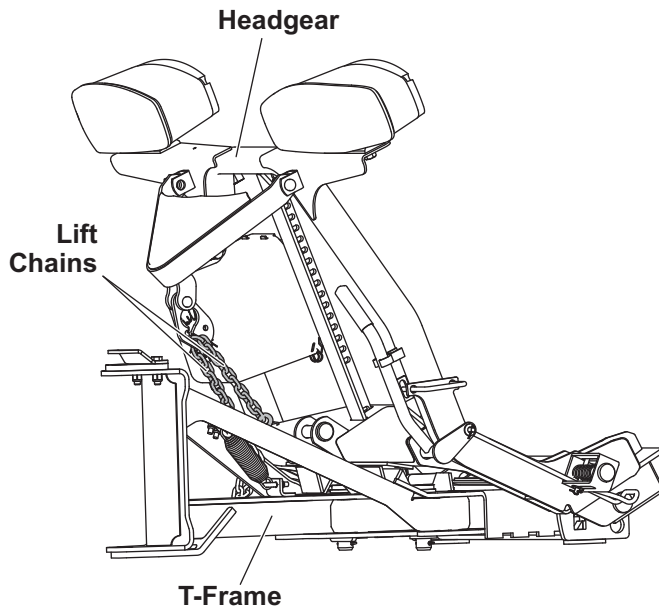

Blade not shown.

3. Safely lift and support the T-frame so that the headgear is elevated off the ground.

4. Place the driver-side wheel assembly around the headgear upright. Insert a 3/8" x 3-1/4" clevis pin through the top hole of the wheel assembly and across the top of the upright. Secure it in place with a 3/8" washer and hairpin cotter as shown in the following illustration.

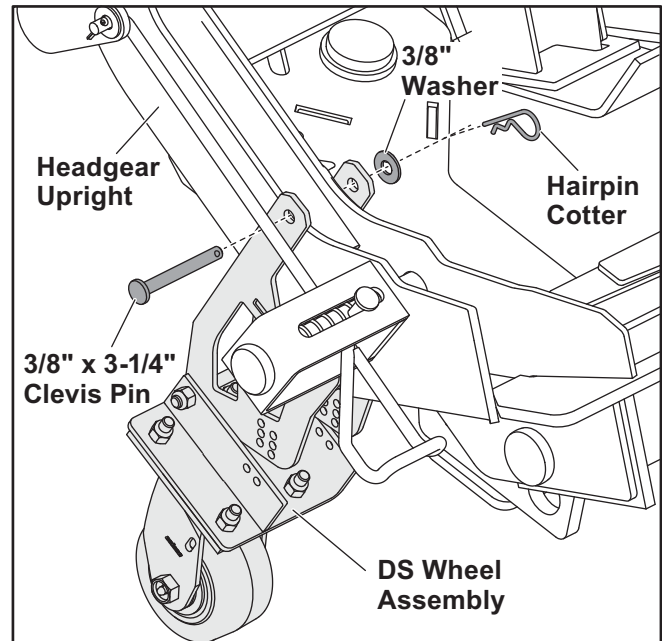

5. Insert the next clevis pin through the driver-side wheel assembly and through the headgear upright. Secure in place with a 3/8" washer and hairpin cotter as shown below.

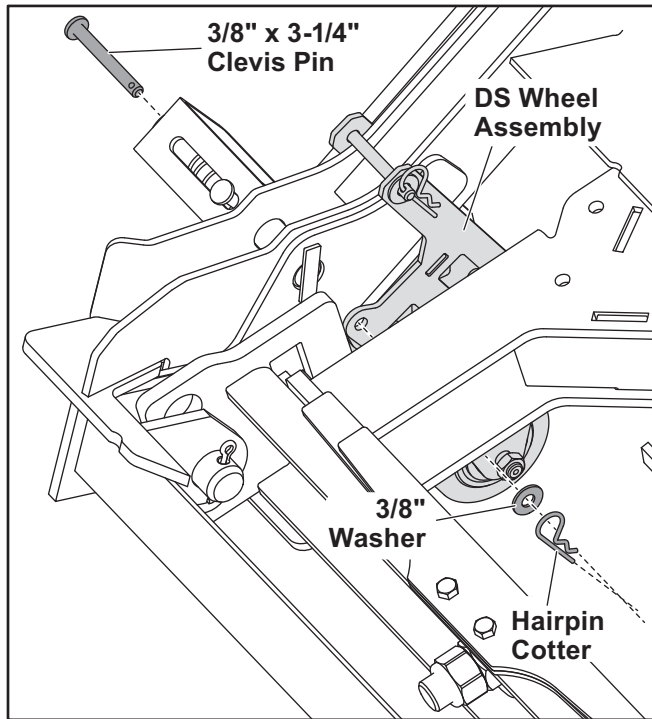

6. Repeat Steps 4 and 5 for the passenger's side.
7. Safely lower the T-frame, allowing both wheel assemblies to contact the ground (driver's side shown).

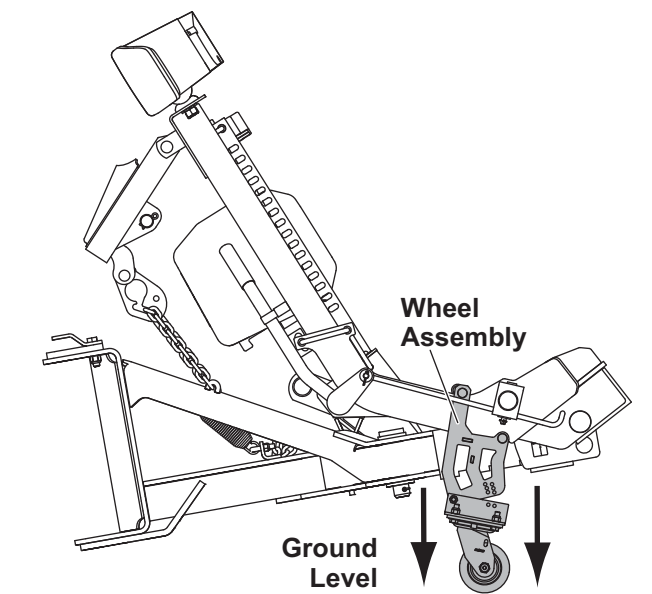

8. Continue lowering the headgear until the T-frame is level with the ground and/or until the 9/32" holes on the foot bracket and leg bracket align as shown below.

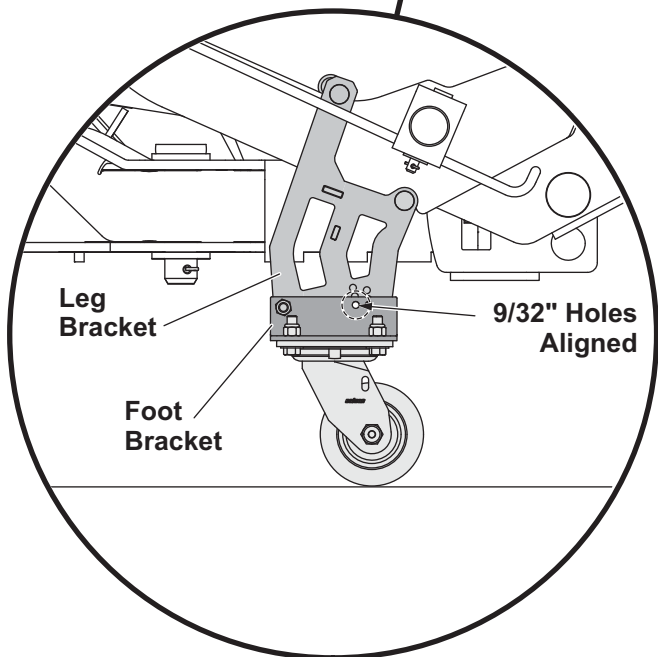
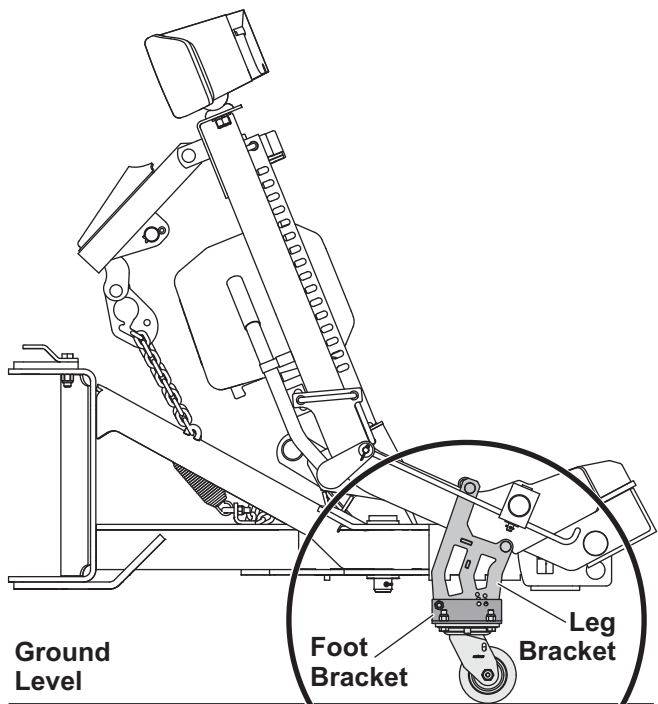

9. Insert a 1/4" x 4" cap screw through the aligned holes on the foot bracket/leg bracket. Secure the cap screw in place with a 1/4" locknut. Torque the fasteners to 10 ft-lb. Repeat for the other wheel assembly.

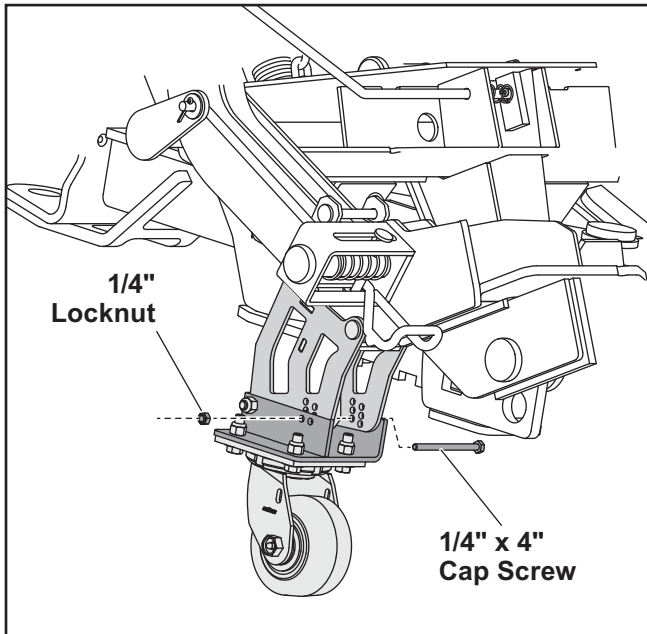

10. Tighten the 3/8" x 4" cap screw and 3/8" locknut to 30 ft-lb. Repeat for the other wheel assembly.

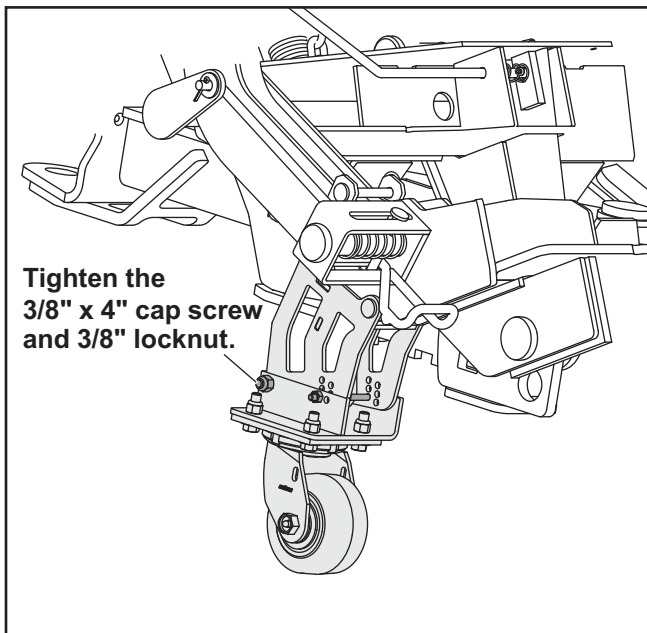

## USING THE WHEEL KIT

### ⚠ CAUTION

Be sure to engage the wheel brakes when the snowplow is left unattended to prevent accidental movement. Failure to do so could result in snowplow damage or personal injury.

### ⚠ CAUTION

The wheel kit assembly is for transporting the snowplow after it has been removed from the vehicle. Do not leave the wheel kit assembly attached while plowing. Failure to comply could damage the snowplow and/or vehicle.

To move the snowplow to the desired location, stand in front of the blade and push the snowplow. Pushing the snowplow from in front of the blade allows for better control and stability.

If pushing the snowplow from behind the blade or using the headgear, be aware of the terrain and be careful of any cracks or obstacles on the floor.

Copyright © 2020 Douglas Dynamics, LLC. All rights reserved. This material may not be reproduced or copied, in whole or in part, in any printed, mechanical, electronic, film, or other distribution and storage media, without the written consent of Fisher Engineering. Authorization to photocopy items for internal or personal use by Fisher Engineering outlets or snowplow owner is granted.

Fisher Engineering reserves the right under its product improvement policy to change construction or design details and furnish equipment when so altered without reference to illustrations or specifications used. Fisher Engineering or the vehicle manufacturer may require or recommend optional equipment for snow removal. Do not exceed vehicle ratings with a snowplow. Fisher Engineering offers a limited warranty for all snowplows and accessories. See separately printed page for this important information. The following is a registered (®) trademark of Douglas Dynamics, LLC: FISHER®.

**Printed in U.S.A.**

---