

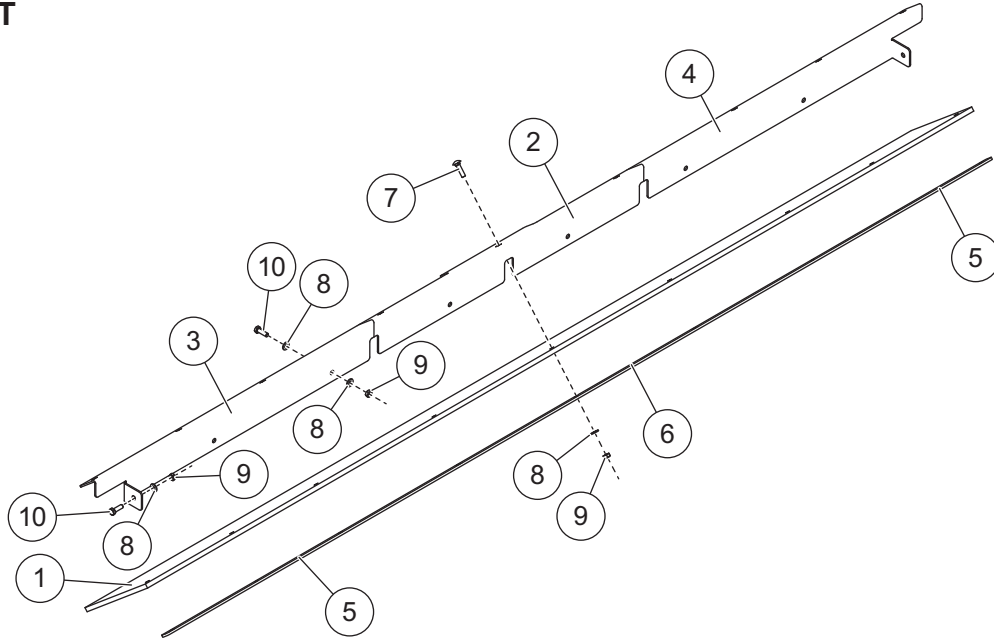

# Rubber Deflector

## XLS™ Snowplows

### PARTS LIST



50628-1 Rubber Deflector Kit – XLS 810							
Item	Part	Qty	Description	Item	Part	Qty	Description
1	50679	1	Rubber Deflector, 810	5	B61658	2	Mount Strip, End – 810
2	50681-1	1	Mount Angle, Center	6	B61659	1	Mount Strip, Center
3	B61652-1	1	Mount Angle, DS – 810	ns	B61379	1	Bolt Bag
4	B61654-1	1	Mount Angle, PS – 810				
B61379 Bolt Bag							
7		9	5/16-18 x 1-1/4 Carriage Bolt	9		17	5/16-18 Hex Locknut GB
8		25	5/16 Hardened Flat Washer	10		8	5/16-18 x 1 Hex Cap Screw G5
ns = not shown				G = Grade			

81997 Rubber Deflector Kit – XLS 8611							
Item	Part	Qty	Description	Item	Part	Qty	Description
1	81101	1	Rubber Deflector, 8611	5	81126	2	Mount Strip, End – 8611
2	50681-1	1	Mount Angle, Center	6	B61659	1	Mount Strip, Center
3	81124	1	Mount Angle, DS – 8611	ns	B61379	1	Bolt Bag
4	81125	1	Mount Angle, PS – 8611				
B61379 Bolt Bag							
7		9	5/16-18 x 1-1/4 Carriage Bolt	9		17	5/16-18 Hex Locknut GB
8		25	5/16 Hardened Flat Washer	10		8	5/16-18 x 1 Hex Cap Screw G5
ns = not shown				G = Grade			

**INSTALLATION INSTRUCTIONS**

**⚠ WARNING**

Do not exceed GVWR or GAWR, including blade and ballast. The rating label is found on the driver-side vehicle door cornerpost.

**⚠ CAUTION**

Read this document before installing the Rubber Deflector Kit.

**⚠ CAUTION**

Use standard methods and practices when attaching snowplow and installing accessories, including proper personal protective safety equipment.

**⚠ CAUTION**

See your FISHER® outlet/website for specific vehicle application recommendations before installation. The eMatch selection system has specific vehicle and snowplow requirements.

1. Park the vehicle on a smooth, level, hard surface, such as concrete. Lower the blade to the ground, and turn the control OFF. Disconnect the snowplow from the vehicle, or turn the vehicle ignition to the "OFF" position and remove the key.
2. If your snowplow has blade guides installed, they must be reversed before installing the rubber deflectors.

Remove the 5/16" locknuts that secure the blade-guide bracket. Remove the bracket, turn it around, and reinstall it as shown below. Repeat for both sides and tighten the fasteners to 18 ft-lb.

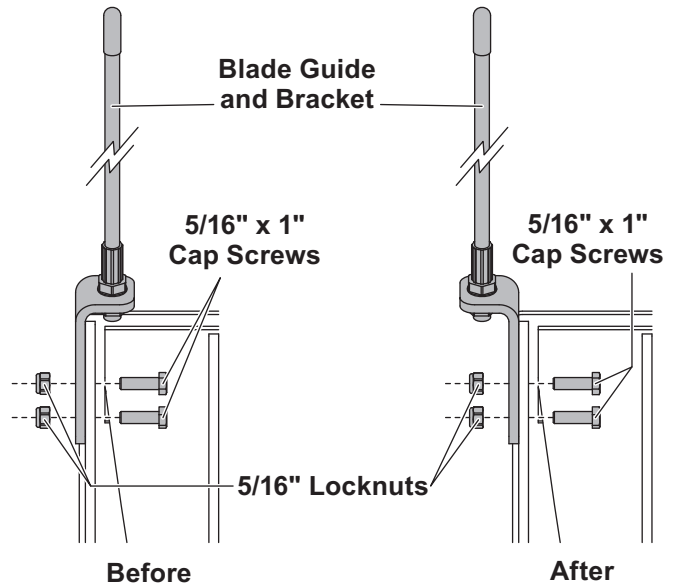

3. Position the mount angles on the logo side of the rubber deflector and the mount strips on the opposite side of the deflector. Attach the mount strips and mount angles to the deflector using the supplied 5/16" x 1-1/4" carriage bolts, 5/16" flat washers, and 5/16" locknuts. Finger tighten the fasteners until the mount strips and mount angles are snug against the deflector.

**NOTE: Each mount angle should be aligned with and butted up against the end of the other mount angles.**

**Blades without Bolt-On Moldboard:**

4. Position the assembled deflector against the inside, top angle of the moldboard. Align the notches in the mount angles with the center support ribs on the blade. Both bent tabs' holes should align with the holes of the support rib on each end. Clamp the mount angles into place on the blade.
5. Using the holes in the mount angles as guides, drill eight 3/8" holes in the moldboard and ribs.
6. Attach the assembled deflector to the blade using the supplied 5/16" x 1" cap screws, 5/16" washers, and 5/16" locknuts. Tighten the fasteners to 18 ft-lb.
7. Tighten the fasteners that secure the mount strips and mount angles to the deflector (from Step 3) until the mount strips and mount angles are tight against the deflector.

**Blades with Bolt-On Moldboard:**

4. Remove the fasteners that fasten the top of the moldboard to the snowplow frame. Save these fasteners, they will be re-used to bolt the mount angles to the snowplow.
5. Attach the assembled deflector to the top of the blade using the removed fasteners from the previous step. Use the supplied 5/16" x 1" cap screws, 5/16" washers, and 5/16" locknuts to attach the driver-side and passenger-side mount angles to the outer blade ribs. Tighten the fasteners to 18 ft-lb.
6. Tighten the fasteners that secure the mount strips and mount angles to the deflector (from Step 3) until the mount strips and mount angles are tight against the deflector.

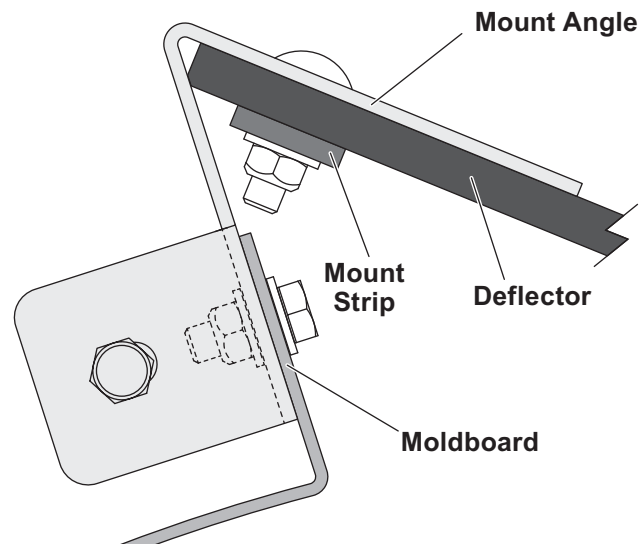

Copyright © 2018 Douglas Dynamics, LLC. All rights reserved. This material may not be reproduced or copied, in whole or in part, in any printed, mechanical, electronic, film, or other distribution and storage media, without the written consent of Fisher Engineering. Authorization to photocopy items for internal or personal use by Fisher Engineering outlets or snowplow owner is granted.

Fisher Engineering reserves the right under its product improvement policy to change construction or design details and furnish equipment when so altered without reference to illustrations or specifications used. Fisher Engineering or the vehicle manufacturer may require or recommend optional equipment for snow removal. Do not exceed vehicle ratings with a snowplow. Fisher Engineering offers a limited warranty for all snowplows and accessories. See separately printed page for this important information. The following are registered (®) or unregistered (™) trademarks of Douglas Dynamics, LLC: FISHER®, XLS™.

**Printed in U.S.A.**

---