



**Fisher Engineering**

50 Gordon Drive, Rockland, Maine 04841-2139 • www.fisherplows.com

**92012**

January 1, 2021  
Lit. No. 92013, Rev. 02

# Headgear/Stand Update Kit

## 7'6" EZ-V® Snowplow

### PARTS LIST

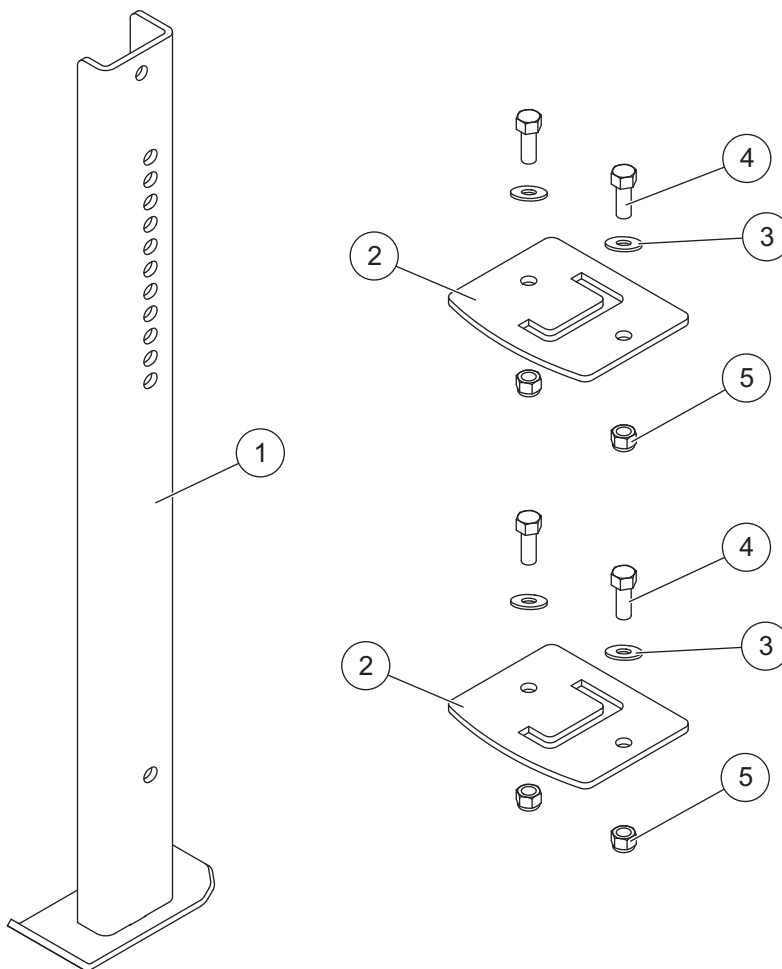

92012 Headgear/Stand Update Kit							
Item	Part	Qty	Description	Item	Part	Qty	Description
1	92009	1	Jack Stand	4		4	3/8-16 x 1 Hex Cap Screw G5
2	92014	2	Jack Stand Retrofit Plate	5		4	3/8-16 Hex Locknut GB
3		4	3/8 Flat Washer Type A Narrow				
G = Grade							

## INSTALLATION INSTRUCTIONS

### ⚠ WARNING

Do not exceed GVWR or GAWR, including blade and ballast. The rating label is found on the driver-side vehicle door cornerpost.

### ⚠ WARNING

Blade can drop unexpectedly. Place blade on jack stands. Failure to do so could result in serious personal injury.

### ⚠ CAUTION

Read this document before installing the headgear/stand update kit.

### ⚠ CAUTION

Use standard methods and practices when attaching snowplow and installing accessories, including proper personal protective safety equipment.

### ⚠ CAUTION

See your FISHER® outlet/website for specific vehicle application recommendations before installation. Headgear/stand update kit weight information may be found in the eMatch tool.

Park the vehicle on a smooth, level, hard surface, such as concrete. Lower the blade to the ground, and turn the control OFF. Disconnect the snowplow from the vehicle, or turn the vehicle ignition to the "OFF" position and remove the key.

## Replace the Jack Stand

1. Detach the snowplow from the vehicle according to the instructions on the blade label and in the Owner's Manual.
2. Remove the hydraulic unit cover.
3. Set the snowplow face down on its blade as shown.

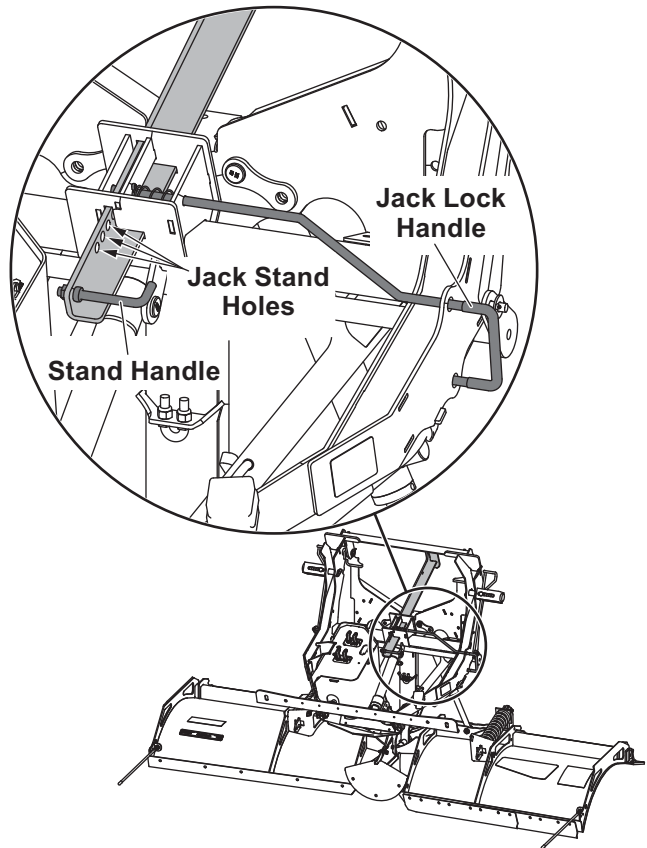

4. Note the number of visible jack stand holes so that the new jack stand can be installed in the same position.
5. Remove the stand handle and retain for reinstallation. Remove the jack stand.

6. Remove material to extend the jack stand retaining slots to the edges of the material as shown.

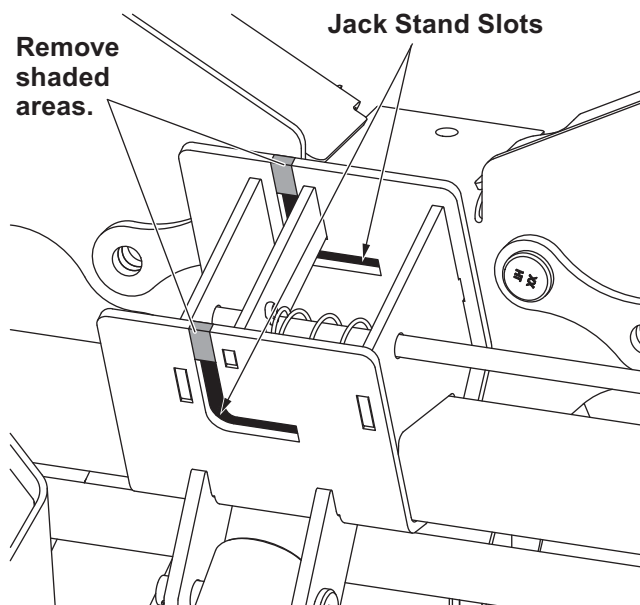

7. Clamp both retrofit plates to the existing stand plates with the jack stand slots aligned.

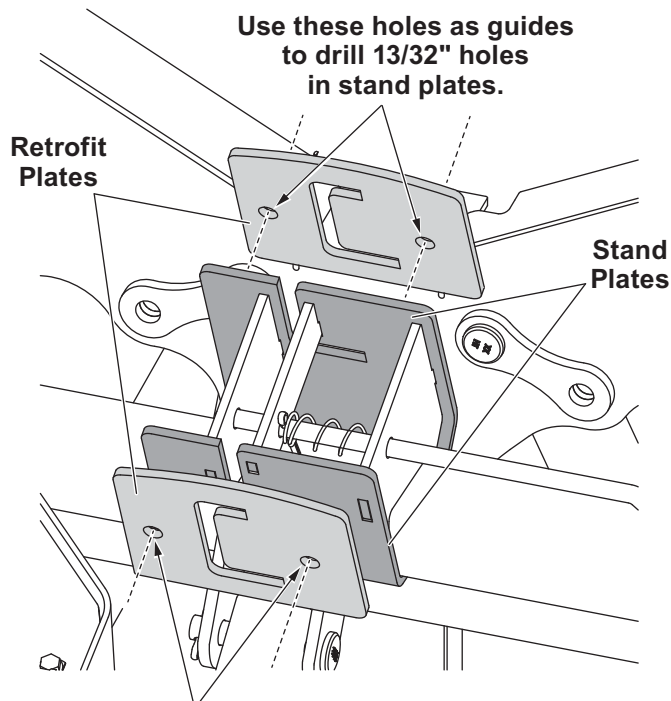

Use these holes as guides  
to drill 13/32\" holes  
in stand plates.

8. Using the holes in the retrofit plates as guides, drill 13/32\" holes through the stand plates.

9. Paint all areas where material was removed.

10. Install the retrofit plates to the stand plates with two 3/8\" x 1\" cap screws and two 3/8\" washers from the top side of the headgear each. Secure each cap screw with a 3/8\" locknut.

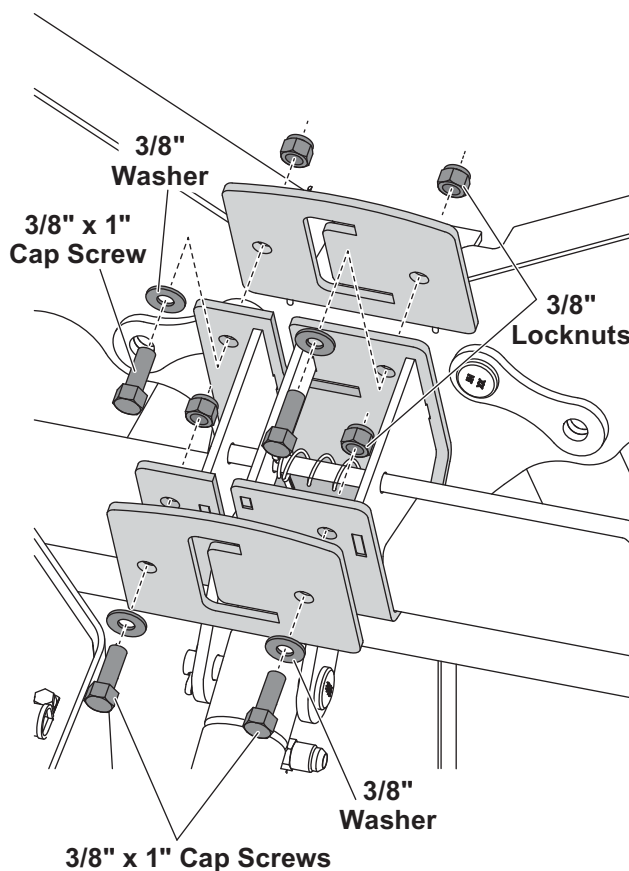

11. Tighten fasteners to 30 ft-lb.

12. To install the new jack stand, pull the jack lock handle out and hold it while sliding the jack stand into the slots.

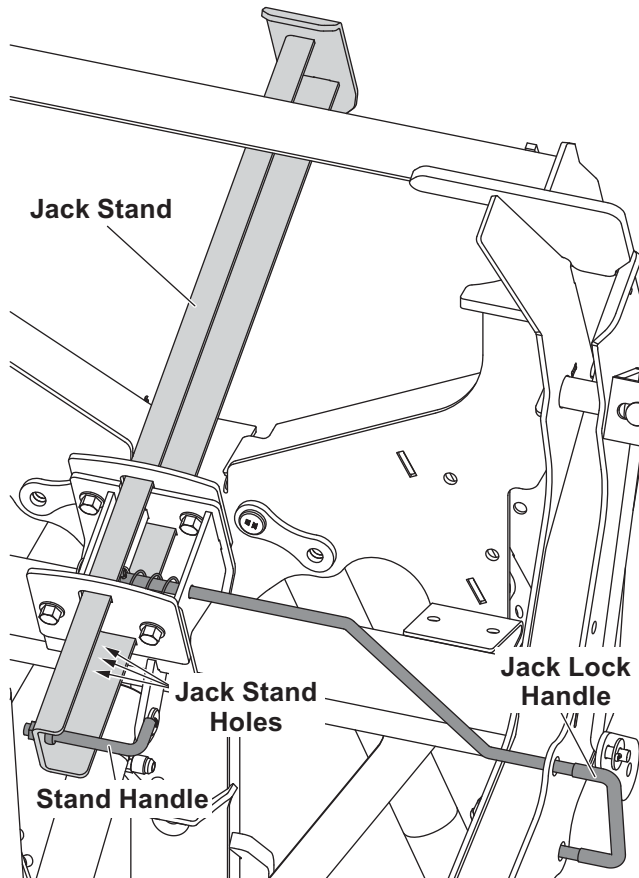

13. When the same number of jack stand holes are visible as in Step 2, release the jack lock handle to hold the jack stand in place.
14. Install the stand handle to the new jack stand.
15. Return the snowplow to normal operating position. If necessary, position the headgear so that the jack stand is vertical.
16. Replace the hydraulic unit cover.

Copyright © 2021 Douglas Dynamics, LLC. All rights reserved. This material may not be reproduced or copied, in whole or in part, in any printed, mechanical, electronic, film, or other distribution and storage media, without the written consent of Fisher Engineering. Authorization to photocopy items for internal or personal use by Fisher Engineering outlets or snowplow owner is granted.

Fisher Engineering reserves the right under its product improvement policy to change construction or design details and furnish equipment when so altered without reference to illustrations or specifications used. Fisher Engineering or the vehicle manufacturer may require or recommend optional equipment for snow removal. Do not exceed vehicle ratings with a snowplow. Fisher Engineering offers a limited warranty for all snowplows and accessories. See separately printed page for this important information. The following are registered (®) trademarks of Douglas Dynamics, LLC: EZ-V®, FISHER®.

Printed in U.S.A.